

Epson® PowerLite® S4

Quick Setup



EPSON®
EXCEED YOUR VISION

1 *Unpack the projector*

You should have the following items:



Projector

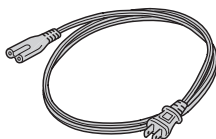

Power cord

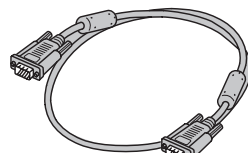

Computer cable



Projector
remote control



Batteries



User's Guide
CD-ROM



Password protect
sticker

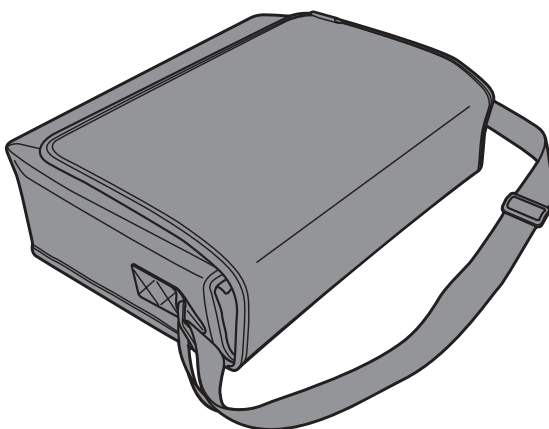

Carrying case

2 *Connect your video source*

Connect the projector to a computer or video source using any of the available connections shown below.

- Check the connectors on your video equipment. If more than one connection is available, choose the one that provides the best quality. (The projector connectors from highest to lowest quality are Computer/Component Video, S-Video, and Video.)
- A computer cable is included. You can purchase optional video cables through Epson or at local electronics stores. See the next page for accessory information.
- You can connect up to 3 video devices and use the remote control to switch between them.

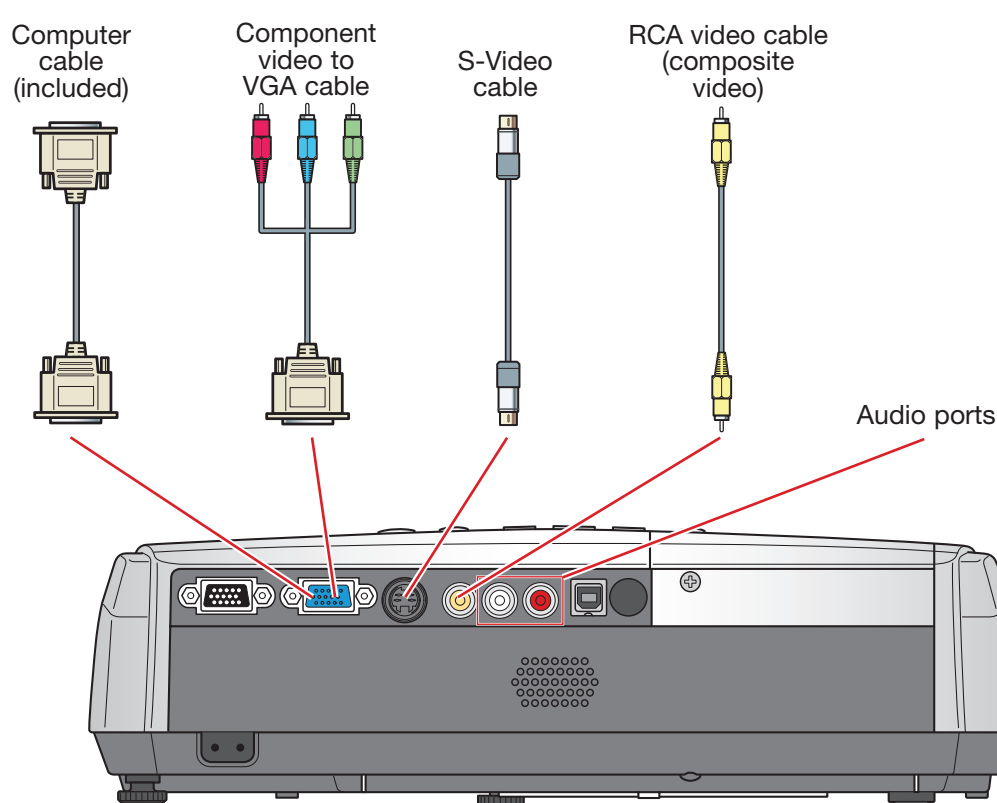

NOTE To play back audio through the projector, you can connect an audio cable from your video device to the audio ports on the projector. See the *User's Guide* on your CD-ROM for instructions.

3 *Set up the remote control*

- 1 Remove the battery cover.
- 2 Insert the batteries.
- 3 Replace the battery cover.

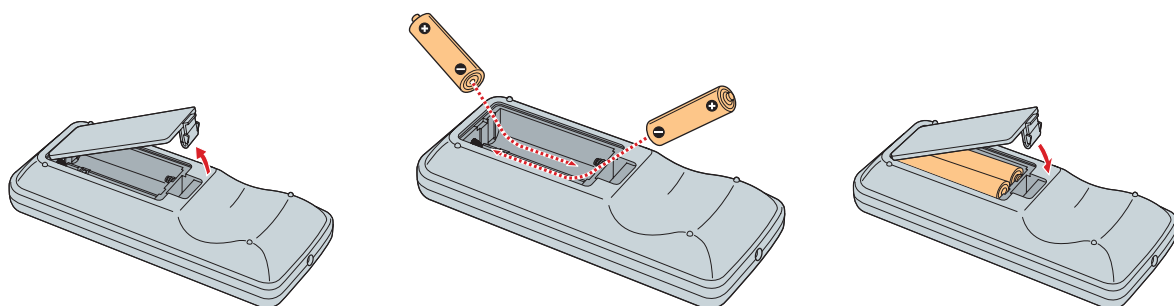

The remote control is ready for use.

Choosing a location

The projector supports 4 viewing setups. Choose the best one for your environment. If you install the projector in a rear or overhead position, you'll need to choose the correct projection option, identified below, from the **Extended** menu. See the *User's Guide* on your CD-ROM for instructions.

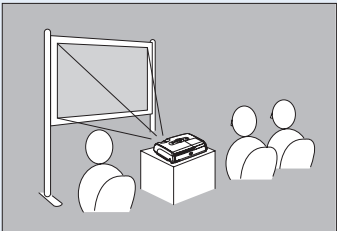
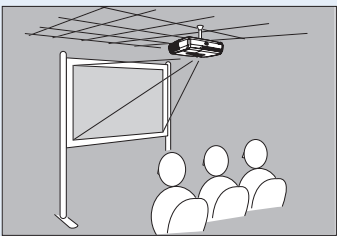
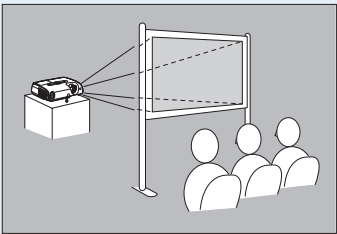

Table
Convenient for temporary front projection. Choose **Front** from the menu.



Ceiling
Professional installation recommended. Choose **Front/Ceiling** from the menu.



Rear
For permanent installation behind a translucent screen. Choose **Rear** from the menu.

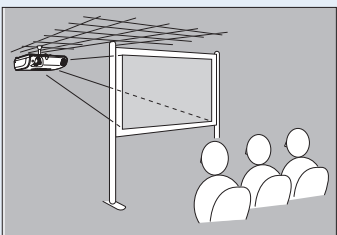

Rear/Ceiling
Professional installation behind a translucent screen recommended. Choose **Rear/Ceiling** from the menu.

The distance between the projector and the screen determines the size of the image. The diagram below shows approximately how big your image will be, based on where you set up the projector.

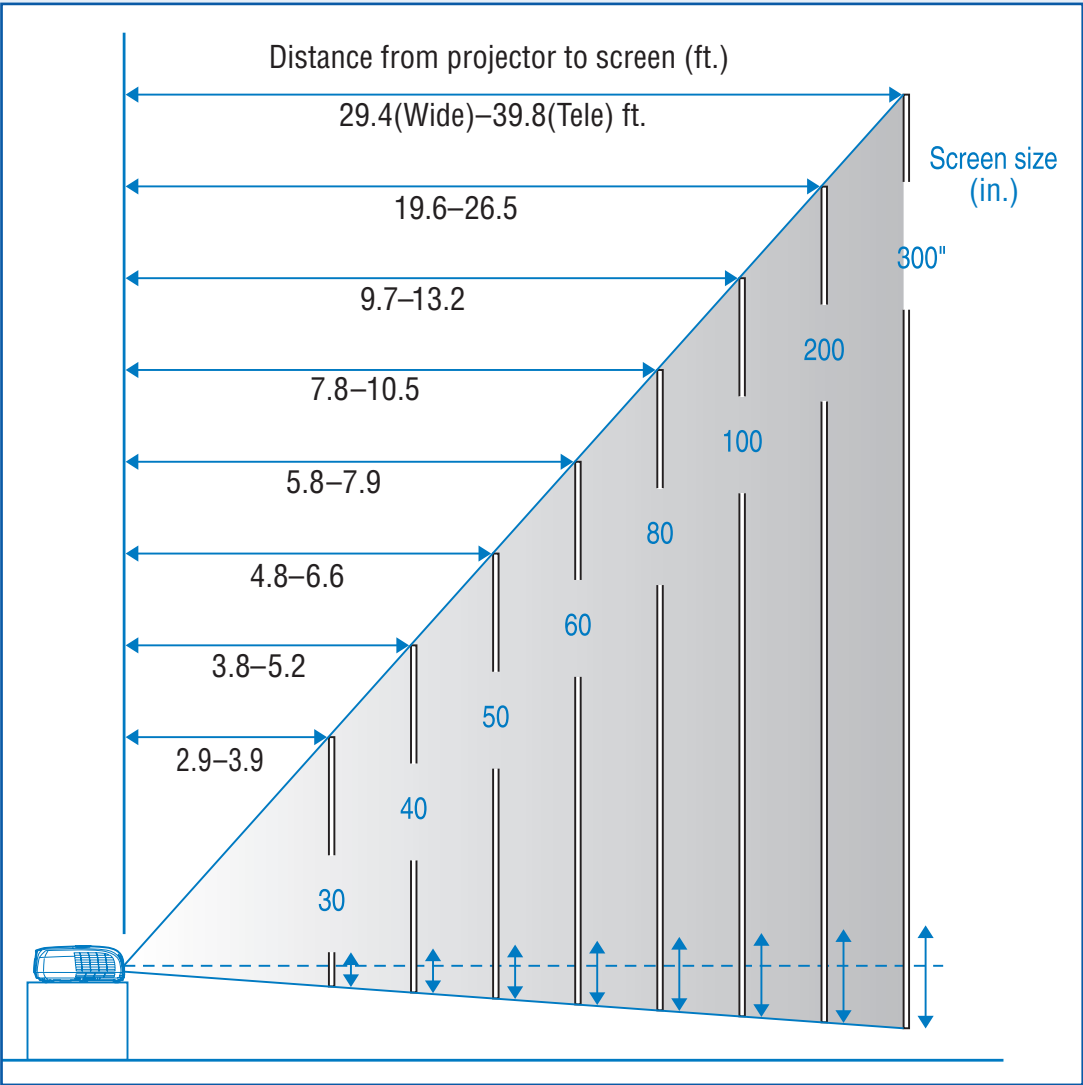

4 Plug in and turn on

- 1 Open the lens cover.

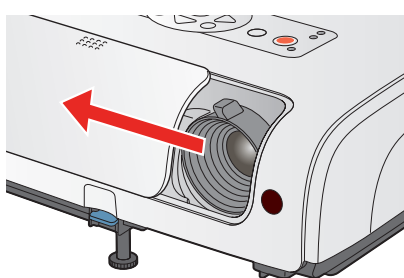

- 2 Connect the power cord to the projector and plug the other end into an electrical outlet.

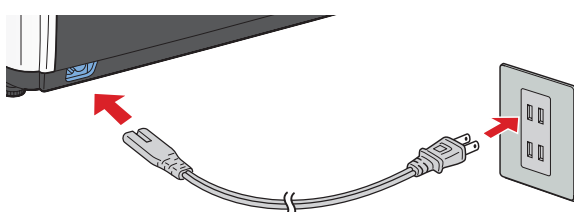

The **Power** light turns orange.

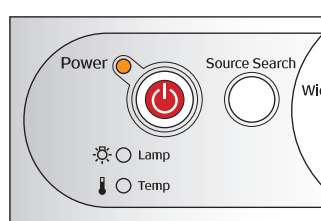

- 3 Press the **Power** button on the projector or remote control. You hear a beep, the **Power** light flashes green, and the projector lamp comes on in about 4 seconds. The **Power** light stays green.

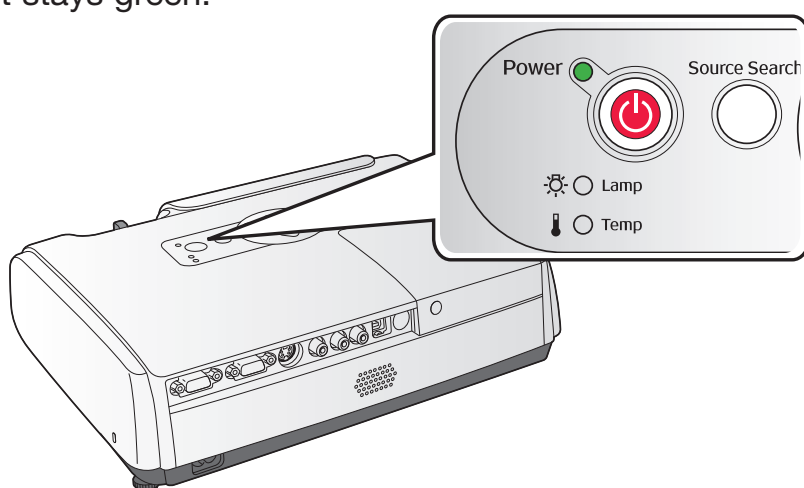

- 4 Start your video or presentation. If you have connected more than one video source, use the **Source** buttons on the remote control to select the one you want to watch.

NOTE If you connected a notebook computer and no image is being projected, you may need to set up the notebook to output signals externally. See the **Troubleshooting** section for instructions.

Source buttons

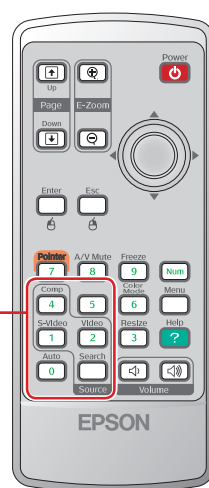

Turning off the projector

- 1 Press the **Power** button on the projector or remote control.
- 2 When you see the confirmation message, press the **Power** button again.
- 3 When the projector beeps twice and the **Power** light turns orange, unplug the projector.

5 *Adjust the image*

- 1 To raise the image, press the foot adjust button and lift the front of the projector. Release the button to lock the foot in the position you want.

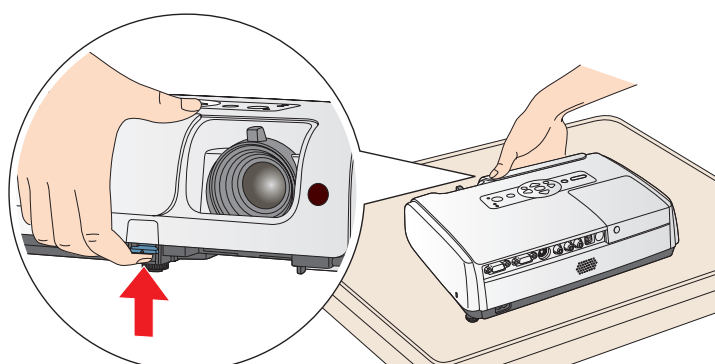

- 2 Rotate the focus ring to sharpen the image. To change the image size, use the **Wide** and **Tele** buttons on the projector.

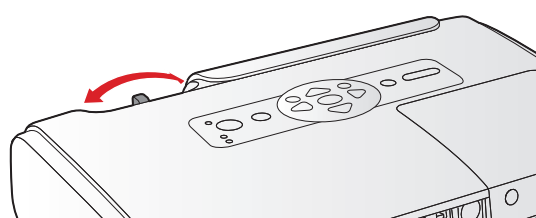

- 3 If your image looks like □ or □, first make sure the projector is facing the screen squarely. Then, if necessary, press the △ and ▽ buttons on the projector's control panel until the image is corrected.

TIP If the projector cannot be placed directly in front of the screen, you can use the Image Shift feature to move the image over the screen. See your *User's Guide* on the CD-ROM.

- 4 To select the best color mode, press the **Color Mode** button on the remote control repeatedly to move through the options.

See your *User's Guide* on the CD-ROM for more information about image adjustments.



Color Mode button

6 *Install your User's Guide and register your projector*

- 1 Insert the CD-ROM in your drive. If the installer doesn't open automatically, double-click the **Epson** CD-ROM icon, then double-click the **Epson** installer icon.
- 2 Choose **English**, then follow the instructions on-screen to register your projector.

NOTE You can also register at www.epson.com/webreg.

- 3 When you are done registering, click **User's Guide** to install it.

If you don't already have Adobe® Reader®, click **Adobe Reader** and follow the on-screen instructions to install it.

- 4 When the guide is installed, double-click the **User's Guide** icon on your desktop to open your *User's Guide*.

Register today to get product updates, special promotions, and customer-only offers.

Where to get help

Internet Support

Visit <http://support.epson.com> for solutions to common problems. You can download drivers and documentation, get FAQs and troubleshooting advice, or e-mail Epson with your questions.

Visit <http://www.presentersonline.com> to access tips, templates, and training for developing successful presentations.

Speak to a Support Representative

To use the Epson PrivateLine® Support service, call (800) 637-7661 and enter the PIN on the included Epson PrivateLine Support card. This service is available 6 AM to 6 PM, Pacific Time, Monday through Friday, for the duration of your warranty period. You may also speak with a projector support specialist by dialing one of these numbers:

U.S.: (562) 276-4394, 6 AM to 6 PM, Pacific Time, Monday-Friday

Canada: (905) 709-3839, 6 AM to 6 PM, Pacific Time, Monday-Friday

Toll or long distance charges may apply.

Purchase Supplies and Accessories

You can purchase screens, carrying cases, video cables, or other accessories from an Epson authorized reseller. To find the nearest reseller, call 800-GO-EPSON (800-463-7766). Or you can purchase online at www.epsonstore.com (U.S. sales) or www.epson.ca (Canadian sales).

Troubleshooting

If you see a blank screen

If you see a blank screen or the No signal message after turning on your notebook, check the following:

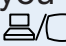
- Make sure the **Power** light on the projector is green and not flashing and the lens cover is open.
- Try turning off the notebook and restarting it.
- If you've connected more than one computer and/or video source, you may need to press the **Source Search** button on the projector or the **Search** button on the remote control to select your video source. (Allow a few seconds for the projector to sync up after pressing it.)
- If you're using Windows®, hold down the **Fn** key and press the function key that lets you display on an external monitor. It may have an icon such as , or it may be labeled CRT/LCD. Allow a few seconds for the projector to sync up after pressing it.

If the projector and the notebook don't display the same image

If you're using a Windows notebook:

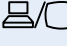
- On most systems, the  or CRT/LCD key lets you toggle between the LCD screen and the projector, or display on both at the same time.
- You might need to use the Display utility in the Control Panel to enable both the LCD screen and external monitor port. Check your notebook's manual or online help for details.
- If you have dual monitor support, you may need to uncheck the option to extend your Windows desktop in the Display Properties.

If you're using a Macintosh® PowerBook® with OS X:

1. From the Apple® menu, select **System Preferences**, then click **Displays**.
2. Select **VGA Display** or **Color LCD**, click **Arrangement** or **Arrange**, and click **Mirror Displays**.