

Start Here



1

Unpack Your Scanner

- 1 Make sure you have everything:

Built-in transparency unit

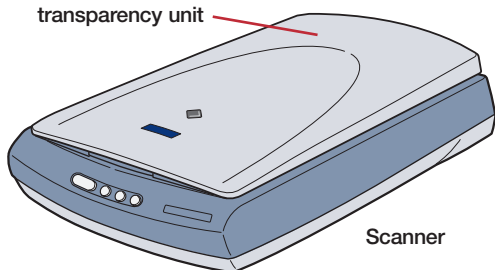

Scanner

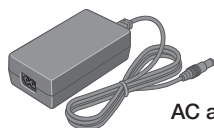

AC adapter

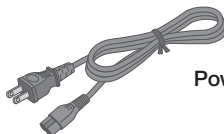

Power cord



CD-ROM with EPSON® scanner software and electronic manual

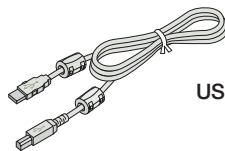

USB cable



Adobe® Photoshop® Elements CD-ROM

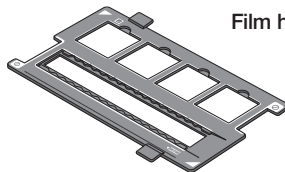

Film holder

See your on-screen *Scanner Reference Guide* for detailed scanning instructions.

- 2 Remove all the packing tape, but leave the yellow sticker in place for now.

IMPORTANT!
Leave the yellow sticker in place until you're instructed to remove it.

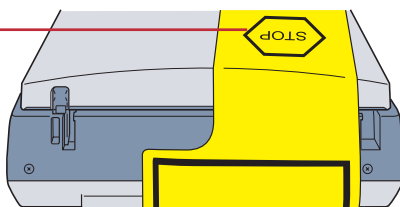

2

Install the Software

Wait! You must install your software before connecting the scanner to your computer. The installation process may take several minutes. Be sure to close all open programs and turn off any virus protection programs.

If you don't already have Adobe Photoshop or Photoshop Elements on your computer, install Photoshop Elements from the CD-ROM included with your scanner before you install the scanner software.

Note: The software works with Windows® 98, Me, 2000, and XP, and Macintosh® OS 8.6 to 9.x and OS X 10.2.x. Macintosh OS 10.1.x is not supported. Follow the steps below for your system.

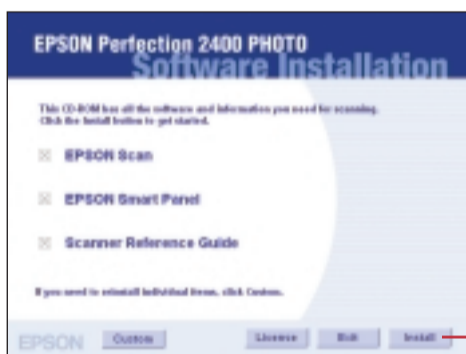

Windows

- 1 Insert the scanner software CD-ROM in the CD-ROM or DVD drive. The installer starts automatically. If it doesn't start, do the following:
 - **Windows XP:** Click **Start**, click **My Computer**, then double-click the **EPSON** CD-ROM icon.
 - **Windows 98, Me, and 2000:** Double-click **My Computer**, then double-click the **EPSON** CD-ROM icon.
- 2 When you see the message about disabling your antivirus software, verify that you have disabled the software, then click **Continue**.
- 3 Read the license agreement, then click **Agree**.
- 4 At the Software Installation screen, click **Install**.



- 5 Follow the on-screen instructions to install each program. Note that EPSON Smart Panel™ installs in several steps.
- 6 At the end of the installation, click **Exit**.
- 7 When you see the Product Registration screen, register your scanner as instructed. At the last screen, click **Done** or close your browser.

Macintosh

- 1 Insert the scanner software CD-ROM in the CD-ROM or DVD drive. The EPSON folder opens on your desktop. If it doesn't open, double-click the  **EPSON** CD-ROM icon.
- 2 If you are using Mac® OS X, double-click the **Mac OS X** folder in the **EPSON** folder, then double-click the  **EPSON** icon.

If you are using Mac OS 8.6 to 9.x, double-click the  **EPSON** icon in the **EPSON** folder.
- 3 When you see the message about disabling your antivirus software, verify that you have disabled the software, then click **Continue**.
- 4 If you see a license agreement, click **Agree** to continue.
- 5 At the Software Installation screen, click **Install**. Enter your Administrator name and password, if necessary.

*Note: If you're installing on Macintosh OS 8.6 to 9.x, you may see a prompt to update your Carbon Library. After the CarbonLib installation is complete and you've restarted your system, double-click the  **EPSON** icon, then click **Install** to continue the installation.*

Continue

- 6** Follow the on-screen instructions to install each program. Click **Quit** to continue, as needed. Note that EPSON Smart Panel installs in several steps.
- 7** At the end of the installation, click **Exit**.
- 8** If you see a Product Registration screen, register your scanner as instructed. At the last screen, click **Done** or close your browser.
- 9** Follow the instructions below to connect the scanner. Then restart your system to fully activate the scanner and software.

3

Connect the Scanner

After your software is installed, it's time to get connected!

- 1** Remove the yellow sticker from the back of the scanner.

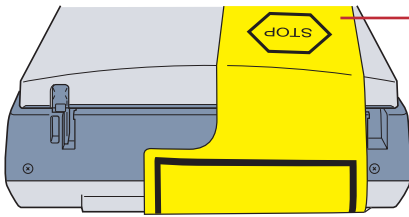

Remove the yellow sticker

- 2** Connect the cable for the built-in transparency unit to the connector on the back of the scanner. (The small arrow on the cable should be facing up.)

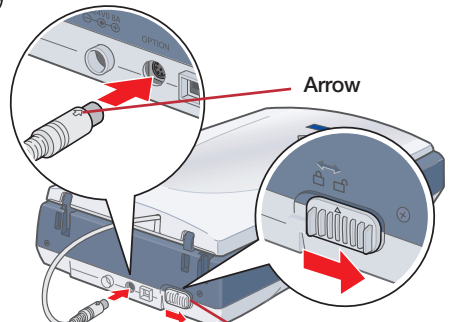

Arrow

- 3** Slide the transportation lock all the way to the right.

Transportation lock

- 4** Connect the AC adapter and power cord, as shown.

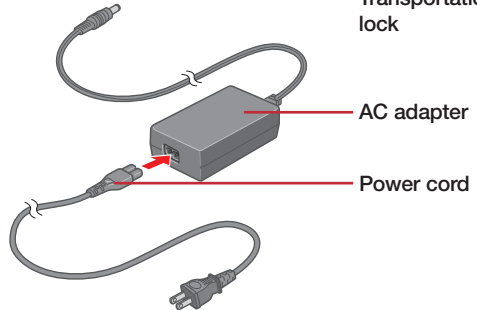

AC adapter

Power cord

- 5** Connect the AC adapter to the scanner.

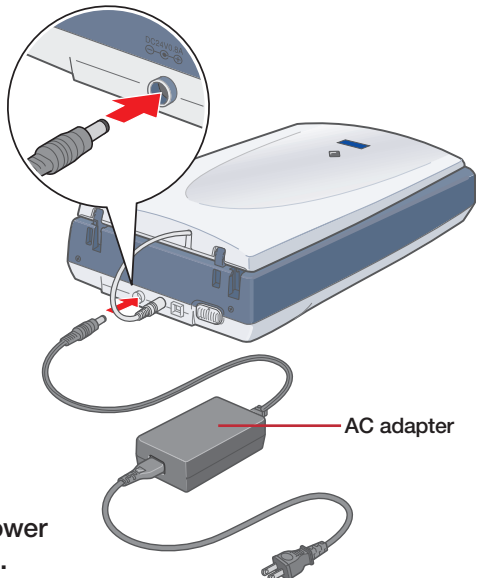



AC adapter

- 6** Plug the other end of the power cord into an electrical outlet.

The scanner turns on and begins to warm up. The  Start button on the front of the scanner flashes. It stops flashing and turns green when the scanner is ready.

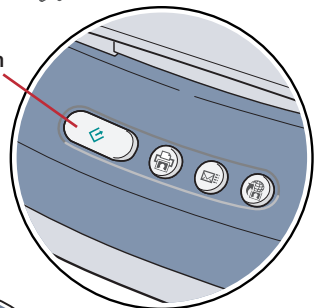
Start button



- 7** Plug the square end  of the USB cable into the scanner's USB port.

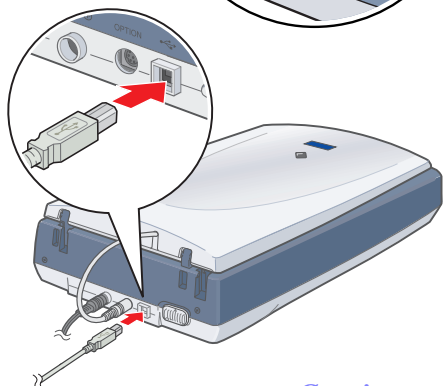

Continue

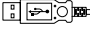
- 8** Plug the flat end  of the cable into any available USB port on your computer.

Note: Your system may not work correctly if you use a USB cable other than the one supplied by EPSON or if you connect to your computer through a hub.

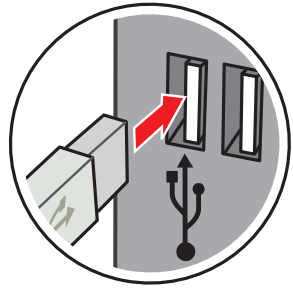

Now you're ready to start scanning!

Scanner Basics

Your First Scan

- 1** Raise the scanner lid and place your photo face down on the glass.

Then close the lid.

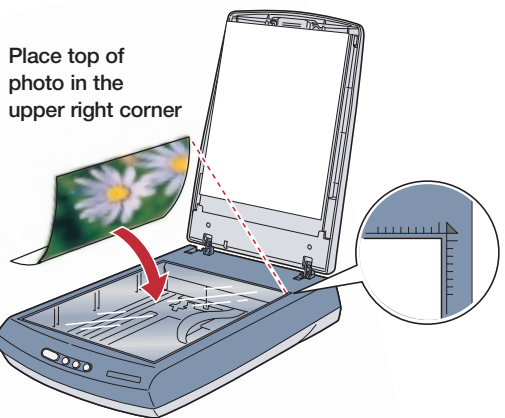

Place top of photo in the upper right corner

- 2** Press the  Start button on the scanner.

Start button

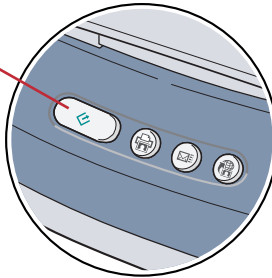

EPSON Smart Panel opens on your computer.



*Note: In Windows XP, you may see a message the first time you press any of the scanner buttons. Select **EPSON Smart Panel**, click **Always use this program for this action**, then click **OK**.*

- 3** Click the  **Scan and Save** icon.

A progress meter appears on the screen and your photo is automatically scanned. After your photo is scanned, the View Image screen opens.

- 4** Click **Next** to continue.

- 5** When you see the following screen, select a location and file type for your scanned image, then click **Save**.

The image is saved to the location specified. To view it, double-click the image or open it in an application like Photoshop Elements.





Starting a Scan

You can start a scan in several different ways:

- You can use the scanner buttons. Press the button for the type of scan you want. Smart Panel automatically opens and scans your documents. Then follow the easy on-screen instructions to finish your task.

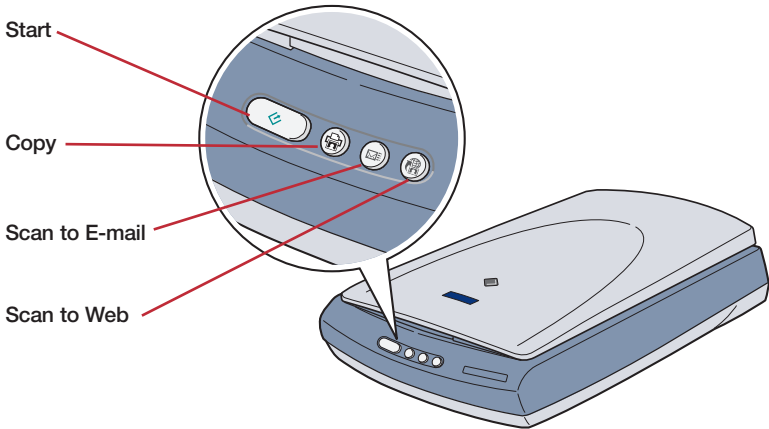
*Note: If you are using Windows XP, you will have to select **EPSON Smart Panel and Always use this program for this action** the first time you press each of the buttons.*



- You can start Smart Panel by clicking the  icon on your desktop, and use it to perform various types of scans.
- You can start EPSON Scan from Adobe Photoshop Elements or any other TWAIN-compliant program. You can also start the EPSON Scan program directly from your computer.

Selecting the Scanning Mode

EPSON Scan has three scanning modes:

- **Full Auto Mode** for automatic control of scan settings.
- **Home Mode** for more control over scan settings, including Color Restoration.
- **Professional Mode** for full control over all scan settings.



To change the scanning mode, choose the mode you want to use from the **Mode** list box at the top right of the window.

To change settings in Full Auto Mode, click the **Pause** button, then click **Options**. If you're using Home or Professional Mode, the options window automatically appears. Then select the settings you want to use for your scan.

Note: The selected mode and settings remain in effect until they are changed.

Restoring Color in Photos

If you have faded photos or negatives, you can use the Color Restoration setting in your software to improve the color of your scan. You can select this setting in Smart Panel or in EPSON Scan.



Smart Panel

- 1 To select the Color Restoration setting, open Smart Panel and select  **Reprint Photo**. You see the screen below.
- 2 Click the **Color Restoration** icon.



Click Color Restoration

Click here to scan and print

EPSON Scan

Color restoration is available in Home and Professional modes.

- 1 To select Color Restoration, start EPSON Scan. You see a screen similar to this.

Select Color Restoration

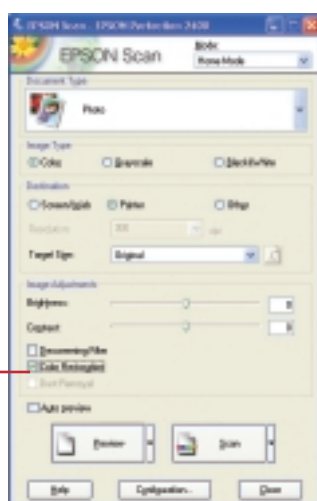

- 2 Click the **Preview** button at the bottom of the screen.
- 3 Select the **Color Restoration** checkbox. (If you're using Professional Mode, you may need to scroll to the bottom of the screen.)

Scanning Film

The scanner cover has a built-in film transparency unit. To scan film or negative strips, slides, or transparencies, you need to remove the document mat from the scanner cover and insert the film in a holder.

Follow these steps to scan 35 mm film or slides:

- 1 Make sure the cable for the transparency unit is connected to the scanner (see section 3). If you need to connect the cable, first disconnect the scanner from the electrical outlet. After you have connected the cable, plug the scanner back into the outlet.
- 2 Open the scanner cover. Pull the handle for the document mat up slightly until the handle is free of the cover, then pull the document mat forward and out.

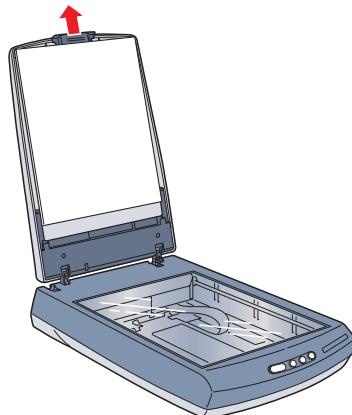

- 3 Locate the film holder that came with your scanner. Slide a strip of 35 mm film into the film strip holder, with the film's shiny side side facing down.

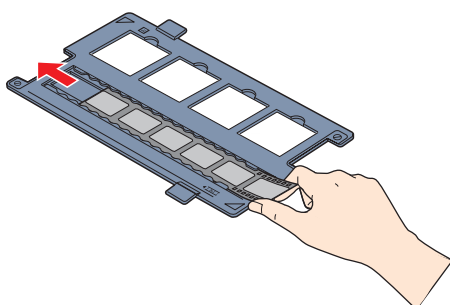

continue

- 4** Place the film holder on the scanner as shown. The film strip side of the holder should be toward the center, and the 35 mm slide holders should be aligned with the right edge of the scanner glass.

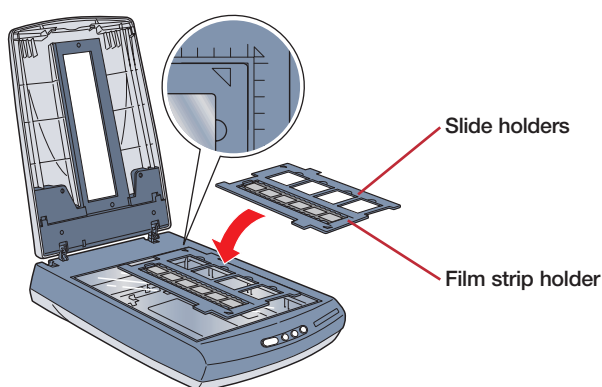

If you're scanning slides, reverse the film holder so the 35 mm slide holders are toward the center and the film strip holder is aligned with the right edge of the scanner glass. Then place the slides in the holder.

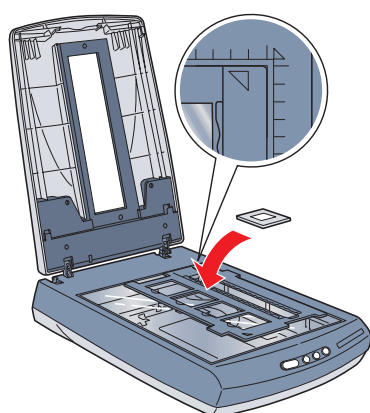

- 5** Start EPSON Scan and select either **Home Mode** or **Professional Mode**.

Note: You can also scan film and slides in Full Auto mode, although you won't have control over the settings.

Home Mode: Select the correct Document Type: **Color Negative Film**, **B&W Negative Film**, or **Positive Film** (for slides and transparencies).

Professional Mode: Select **Transparency** as your Document Type. Then select the Film Type: **Color Negative Film**, **B&W Negative Film**, or **Positive Film**.

Tip: Make sure your film is dust-free for the best scan. You can also select the **Dust Removal** setting in EPSON Scan, as shown.

Click to lessen the appearance of dust

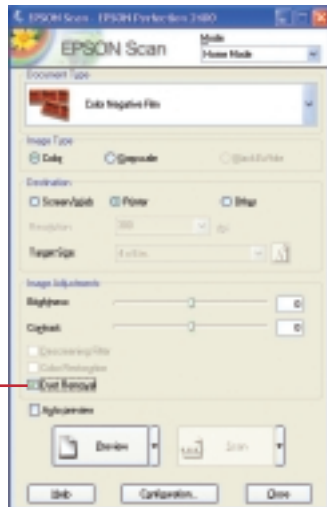

Got Questions?

Here's where to look for answers:

On-screen *Scanner Reference Guide*

Double-click the *Scanner Reference Guide* icon on your desktop.

On-screen Help for Smart Panel and EPSON Scan

Click the **Help** button or question mark that appears on the screen when you're using these programs.

EPSON Technical Support

EPSON provides technical assistance 24 hours a day through the electronic support services and automated telephone services described below:

World Wide Web

From the Internet, you can reach EPSON Support at <http://support.epson.com>.

Automated Telephone Services

To use Automated Telephone Services, you must have a touch tone telephone and call (800) 922-8911. Your EPSON SoundAdviceSM Express Code is 70395. Use it to quickly select your scanner in SoundAdvice.

To Speak to a Technical Support Representative

Dial (562) 276-4382 (U.S.) or (905) 709-3839 (Canada), 6 AM to 6 PM, Pacific Time, Monday through Friday. Toll or long distance charges may apply.

To Purchase an Optional Film Adapter or Other Accessories

Call the EPSON StoreSM at (800) 873-7766 or visit our web site at www.epsonstore.com (U.S. sales only). In Canada, please call (800) 873-7766 for dealer referral.



Software Technical Support

If you're having problems with your software, use the contact information below.

Software	Telephone	Fax	Internet and E-mail
EPSON Scan	U.S. (562) 276-4382		support.epson.com
	Canada (905) 709-3839		
	6:00 AM to 6:00 PM, PT, Monday-Friday		
EPSON Smart Panel	(510) 445-8616	(510) 445-8601	www.newsoftinc.com tech@newsoftinc.com
Adobe Photoshop Elements	Windows (206) 675-6358		www.adobe.com/support
	Macintosh (206) 675-6258		

Problems?

First, check the  light on the scanner.

-  **Flashing green** Warming up or scanning.
-  **Green** Ready to scan.
-  **Flashing red** Make sure the transportation lock is unlocked (see section 3).

Try restarting your computer and turning the scanner off and then on again.

If the red light is still flashing, contact your dealer or EPSON.
-  **Off** Make sure your scanner is connected to your computer and plugged into a working power source.

If your problem is listed here, try these suggestions.

The New Hardware Wizard appears on your screen. Click **Cancel** and follow the steps in "Install the Software" on the other side of this sheet. Disconnect the scanner before installing the software.

You see a message about a HI-SPEED USB device in Windows XP. Click the x in the corner of the message to close it. Your scanner will work correctly, although not at maximum speed.

You see an error message when you try to scan, or the scanner doesn't scan. Make sure the scanner is connected to your computer and plugged into a power source.

Make sure the transportation lock is pushed all the way to the right (see section 3).

Uninstall the following programs: EPSON Photo Print, EPSON Scan, EPSON Smart Panel, and ScanToWeb. In the Windows Control Panel, use the Add/Remove Programs utility to uninstall software. Then follow the instructions on the other side of this sheet to reinstall your scanner software.

You can't scan negatives or slides. Make sure the scanner film holder is positioned correctly, and the scanner glass is clean.

Make sure the cable for the transparency unit is connected to the scanner (see section 3) and the reflective document mat is removed.

If you're using Home or Professional mode, make sure the Document Type or Film Type matches what you're scanning: either **Color Negative Film**, **B&W Negative Film**, or **Positive Film** (for slides and transparencies).

EPSON is a registered trademark and EPSON Smart Panel is a trademark of SEIKO EPSON CORPORATION. EPSON Perfection is a registered trademark, and EPSON Store and SoundAdvice are service marks of Epson America, Inc.

General Notice: Other product names are for identification purposes only and may be trademarks of their respective owners. EPSON disclaims any and all rights in those marks.