

Quick Setup

IMPORTANT: Before using this product, make sure you read these instructions and the safety instructions in the online *User's Guide*.

Contents

Make sure your projector box includes all of these parts:

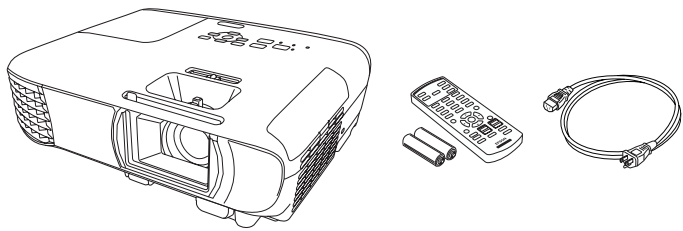

Connect the projector

Choose from the following connections. See the sections below or the online *User's Guide* for details.

Video device

Connect one end of an HDMI™ cable to one of the projector's **HDMI** ports and the other end to an HDMI port on your video device.

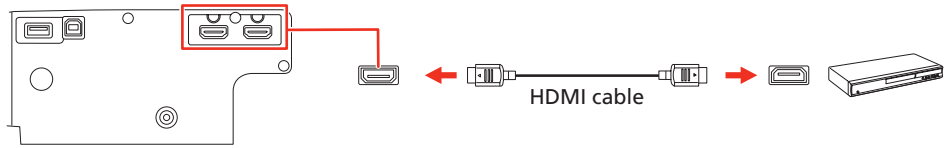

Note: If you connected a streaming device to an HDMI port, you can also connect it to the projector's **USB-A** (flat) port for power.

Computer

Connect one end of an HDMI cable to one of the projector's **HDMI** ports and the other end to an HDMI port on your computer.

Note: For more information on connecting the projector to your computer or other devices (camera, USB flash drive, etc.), see the online *User's Guide*.

Connect audio

Built-in speaker

The projector has a built-in speaker that can play audio from a video source (DVD player, streaming device, etc.) connected by an HDMI cable.

External speakers

You can connect the projector to external self-powered speakers through the **Audio Out** port.

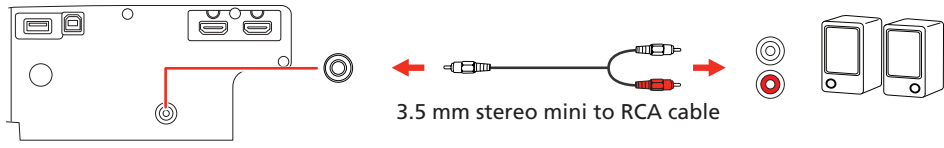

Note: The projector's internal speaker is disabled when you connect external speakers.

Using the remote control

Install the batteries as shown (two AA batteries).

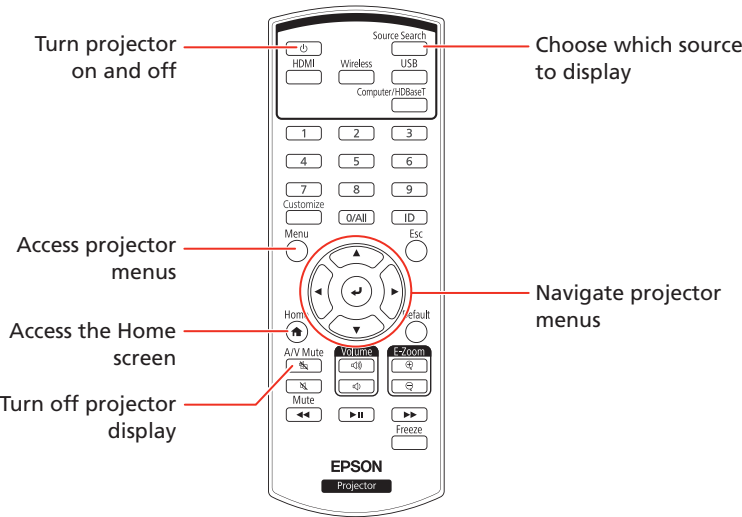
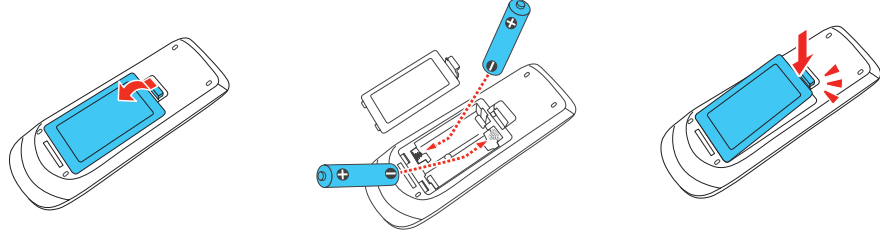

For more information on using the remote control, see the online *User's Guide*.

Turn on your equipment

- 1 Plug in the projector. The power light on the projector turns blue.

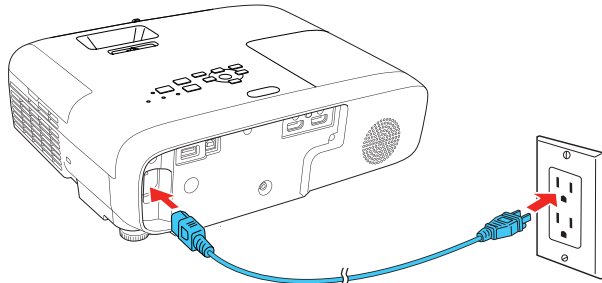

- 2 Open the A/V Mute slide all the way.

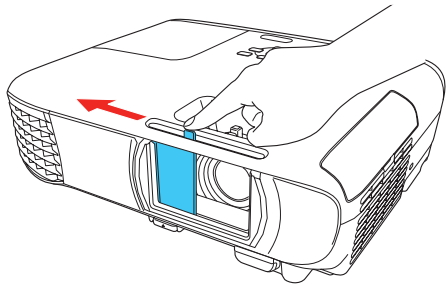

- 3 Press the power button on the projector or remote control. The projector beeps, the Status light flashes blue, and then stays on.

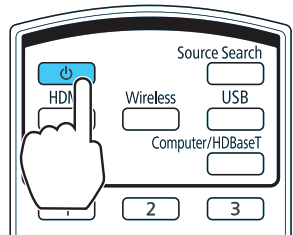

Note: To shut down the projector, press the power button twice.

- 4 Use the arrow and buttons on the projector or remote control to proceed with initial setup.

Note: You can change these settings later using the projector's menus. For more information, see the online *User's Guide*.

- 5 When initial setup is complete, turn on your computer or video source.

Adjust the image

- 1 If you don't see an image, press the **Source Search** button on the projector or remote control to select the image source.

Note: If you still see a blank screen or have other display problems, see "Troubleshooting."

- 2 To raise the image, press the foot release button and lift the front of the projector. Release the button to lock the foot in position.

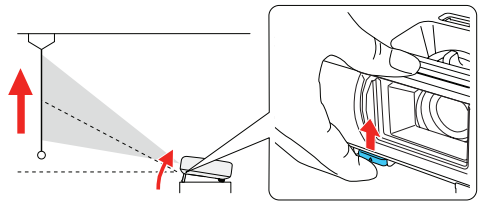

- 3 To reduce or enlarge the image, turn the zoom ring.

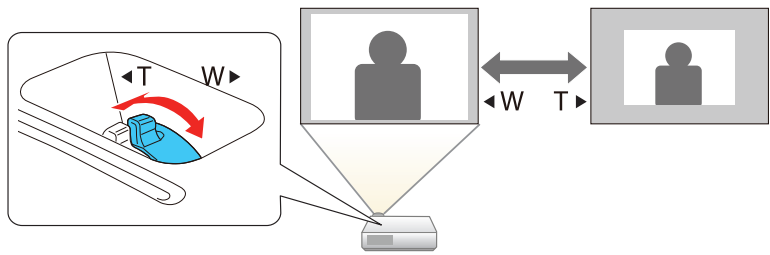

- 4 To sharpen the image, turn the focus ring.

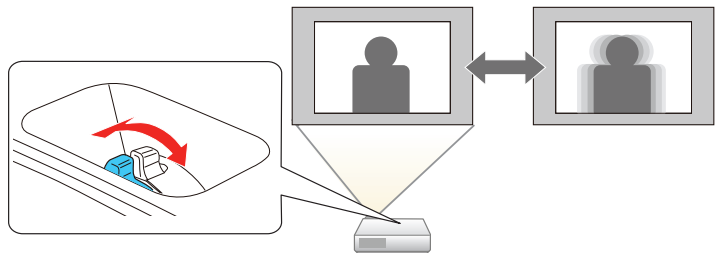

- 5 If your image looks like [trapezoid] or [trapezoid], you may have placed the projector off to one side of the screen at an angle. Place the projector directly in front of the center of the screen, facing the screen squarely. If you can't move the projector, use the horizontal keystone slider on the projector to correct the image shape.

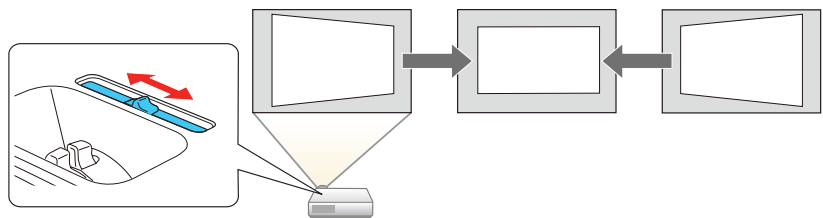

- 6 Your projector automatically adjusts an image that looks like [trapezoid] or [trapezoid], but, if necessary, you can press the button or button on the projector to correct it.

Mirroring a mobile device

If your mobile device (laptop, smartphone, or tablet) supports Miracast™, you can project or mirror your device's screen wirelessly. You do not need any additional software to use this feature.

Note: Some restrictions apply. See the online *User's Guide* for details.

Select screen mirroring settings

- 1 Press the **Menu** button on the remote control.
- 2 Select the **Network** menu and press .
- 3 Make sure the **Wireless LAN Power** setting is set to **On**.
- 4 Select **Network Configuration** and press .

- 5 Select the **Wireless LAN** menu and press .

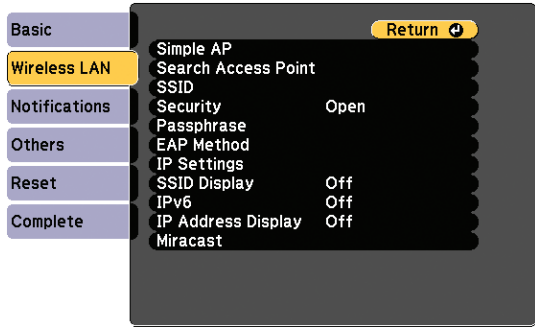

- 6 Make sure the **Simple AP** setting is set to **On**.

- 7 Select **Miracast** and press .

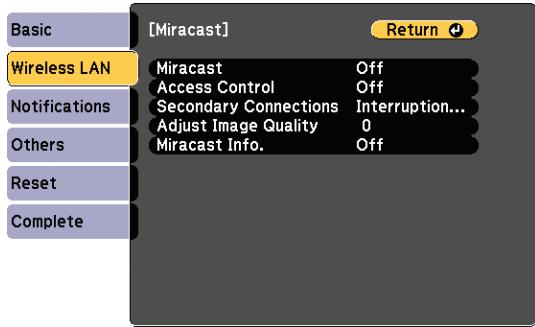

- 8 Select **On** as the **Miracast** setting.

- 9 Select any of the **Miracast** options as necessary. See the online *User's Guide* for details.

- 10 When you finish selecting settings, select **Complete** and follow the on-screen instructions to save your settings and exit the menus.

Note: If you are prompted to enter a password for *Epson Web Control*, you can create a password or leave it blank. If you do not set a password, you cannot use *Epson Web Control*.

Connect your device

- 1 Press the **Wireless** button on the remote control to switch to the Miracast source. You see the Screen Mirroring standby screen.

- 2 Use the Miracast function on your device to search for the projector. You see a list of available devices.

Note: See your device's documentation for details on using its Miracast function.

- 3 Select the projector from the list.

Note: If you see a confirmation screen, check the displayed device name, then select if you want to allow projection.

The projector displays the image from your device once a connection is established.

Caution: It may take some time to establish a connection. Do not disconnect the projector's power cord while it is connecting to your device. Doing so may cause your device to freeze or malfunction.

Apple AirPlay and Apple HomeKit

With AirPlay, you can stream movies, music, games, and photos to your projector right from your iPhone, iPad, or Mac.

With HomeKit, you can easily and securely control your projector with the Apple Home app and Siri on your iPhone, iPad, Apple Watch, HomePod, HomePod mini, or Mac.

See the online *User's Guide* for more information.

Note: To use *AirPlay* and *HomeKit* with your projector, the latest version of *iOS*, *iPadOS*, or *macOS* is recommended.



Troubleshooting

- If you see a blank screen, check the following:
 - Make sure the A/V Mute slide is open.
 - Make sure the Status light on the projector is blue and not flashing.
 - Press the  power button or the **A/V Mute** button on the remote control to wake to wake the projector from standby or sleep mode, if necessary.
- If you see a blank screen when a computer is connected, check the following:
 - On Windows®, hold down the Windows key and press **P** at the same time, then click **Duplicate**.
 - If you are using a Mac laptop with macOS 13 or newer, select **System Settings > Displays**. Select the projector, then choose the mirror option for your display from the Use as pop-up menu.

On macOS 12, select **System Preferences > Displays > Display Settings**. Select the projector, then choose the mirror option for your display from the drop-down menu.

On macOS 11 and older, open **System Preferences** and select **Displays**. Click the **Arrangement** tab and select the **Mirror Displays** checkbox.
- If the projector does not respond to remote control commands, make sure the batteries in the remote control are installed correctly. Replace the batteries if necessary.
- If you are unable to project using a wireless connection, make sure the projector and your device are on the same network. See the online *User's Guide* for more information.

Registration

Scan the QR code to register for product updates and exclusive offers.



Where to get help

Manuals

For more information about using the projector, you can view or download the manuals from the Epson website, as described below.

Internet support

Visit **<http://epson.com/support/hc1100>** (U.S.), **<http://epson.ca/support/hc1100>** (Canada), or **<http://latin.epson.com/support/hc1100>** (Latin America) to download software and utilities, view manuals, get FAQs and troubleshooting advice, or contact Epson.

Telephone support

To use the Epson PrivateLine™ Support service, call (800) 637-7661. This service is available for the duration of your warranty period. You may also speak with a support specialist by calling (562) 276-4394 (U.S.) or (905) 709-3839 (Canada).

Support hours are 7 a.m. to 4 p.m., Pacific Time, Monday through Friday. Days and hours of support are subject to change without notice. Toll or long distance charges may apply.

In Latin America, see the online *User's Guide* for technical support information.

Optional accessories

For a list of optional accessories, see the online *User's Guide*.

You can purchase screens or other accessories from an Epson-authorized reseller. To find the nearest reseller in the U.S. or Canada, call 800-GO-EPSON (800-463-7766). Or you can purchase online at **<http://epsonstore.com>** (U.S. sales) or **<http://epsonstore.ca>** (Canadian sales).

To find the nearest reseller in Latin America, go to **<http://latin.epson.com>**.

Notices

Wireless Product Safety Instructions

Contains WLAN / BT module model: NH7

This document provides safety instructions and describes the specifications. Read this document carefully before use to ensure your safety and product performance.

This device is restricted to indoor operation only.

Operating frequency range: 2.402-2.480GHz, 5.18-5.24GHz, 5.26-5.32GHz, 5.50-5.72GHz, 5.745-5.825GHz, 5.845-5.885GHz, 5.955-7.115GHz

Data transmission is always initiated by software, which is then passed down through the MAC, through the digital and analog baseband, and finally to the RF chip. Several special packets are initiated by the MAC. These are the only ways the digital baseband portion will turn on the RF transmitter, which it then turns off at the end of the packet. Therefore, the transmitter will be on only while one of the aforementioned packets is being transmitted. In other words, this device automatically discontinues transmission in case of either absence of information to transmit or operational failure.

U.S. FCC Notices

Contains FCC ID: BKMAE-NH7

This device complies with Part 15 of the FCC Rules. Operation is subject to the following two conditions: (1) This device may not cause harmful interference, and (2) this device must accept any interference received, including interference that may cause undesired operation. This equipment has been tested and found to comply with the limits for a Class B digital device, pursuant to Part 15 of the FCC Rules. These limits are designed to provide reasonable protection against harmful interference in a residential installation. This equipment generates, uses, and can radiate radio frequency energy and, if not installed and used in accordance with the instructions, may cause harmful interference to radio communications. However, there is no guarantee that interference will not occur in a particular installation. If this equipment does cause harmful interference to radio or television reception, which can be determined by turning the equipment off and on, the user is encouraged to try to correct the interference by one or more of the following measures:

- Reorient or relocate the receiving antenna.
- Increase the separation between the equipment and receiver.
- Connect the equipment into an outlet on a circuit different from that to which the receiver is connected.
- Consult the dealer or an experienced radio/TV technician for help.

Caution: Changes or modifications not expressly approved by the party responsible for compliance could void the user's authority to operate this equipment. Properly shielded and grounded cables and connectors must be used for connection to host computers and/or peripherals in order to meet FCC emission limits.

This transmitter must not be co-located or operating in conjunction with any other antenna or transmitter.

This equipment complies with FCC radiation exposure limits set forth for an uncontrolled environment and meets the FCC radio frequency (RF) Exposure Guidelines.

This equipment should be installed and operated keeping the radiator at least 7.8 inches (20 cm) or more away from person's body.

Innovation, Science and Economic Development Canada (ISED) Notices

Contains IC: 1052D-NH7

CAN ICES(B)/NMB(B)

This device contains license-exempt transmitter(s)/receiver(s) that comply with Innovation, Science and Economic Development Canada's license-exempt RSS(s). Operation is subject to the following two conditions: (1) This device may not cause interference. (2) This device must accept any interference, including interference that may cause undesired operation of the device.

This equipment (without Bluetooth® remote controller) complies with ISED radiation exposure limits set forth for an uncontrolled environment and meets RSS-102 of the ISED radio frequency (RF) Exposure rules. This equipment should be installed and operated with a distance of at least 7.9 inches (20 cm) between the radiator and your body.



EPSON is a registered trademark of Seiko Epson Corporation.

PrivateLine is a trademark of Epson America, Inc.

AirPlay, Apple Watch, HomeKit, HomePod, HomePod mini, iPad, iPadOS, iPhone, Mac, macOS, OS X, and Siri are trademarks of Apple Inc., registered in the U.S. and other countries.

Windows is a trademark of the Microsoft group of companies.

Miracast is a trademark of Wi-Fi Alliance.

General Notice: Other product names used herein are for identification purposes only and may be trademarks of their respective owners. Epson disclaims any and all rights in those marks.

This information is subject to change without notice.

© 2024 Epson America, Inc., 11/24