



## Transparency Unit

The transparency unit (B813182) allows you to scan transparent materials—35 mm slides, filmstrips, and film up to  $8.5 \times 11.7$  inches ( $216 \times 297$  mm) in size. To switch between scanning transparent materials and normal reflective (paper) documents, simply insert or remove the reflective document mat that came with the unit. For instructions on using the reflective document mat, see “Scanning Reflective Documents” on page 101.

## Unpacking the Transparency Unit

Make sure that all of the following items are included in the transparency unit box. If any items are missing or damaged, contact your EPSON dealer, or contact EPSON at (562) 276-4382 (in the United States) or (905) 709-3839 (in Canada). Keep all the packing materials so you can use them for storage when you are not scanning transparencies.

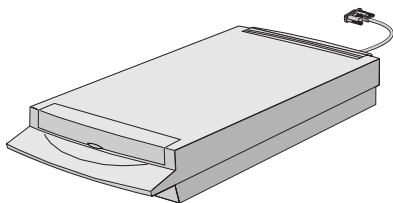

transparency unit



screws

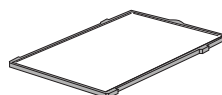

reflective document mat

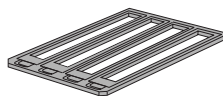
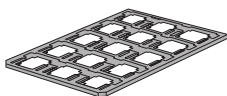

film holders

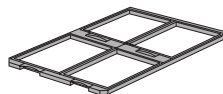
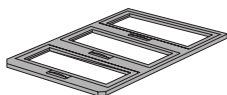

Use the transparency unit's pocket to store the reflective document mat. Don't store anything else in the pocket.

## Removing the Shipping Screw

To prevent damage during shipping, a shipping screw is attached to the transparency unit to secure its lamp assembly. You must remove this screw before using the transparency unit.

1. Turn the transparency unit so the glass side faces up.
2. Use a Phillips head (cross head) screwdriver to remove the shipping screw from the hole labeled **CLAMP**, as shown at right.
3. Install the screw in the storage hole labeled **STOCK**.

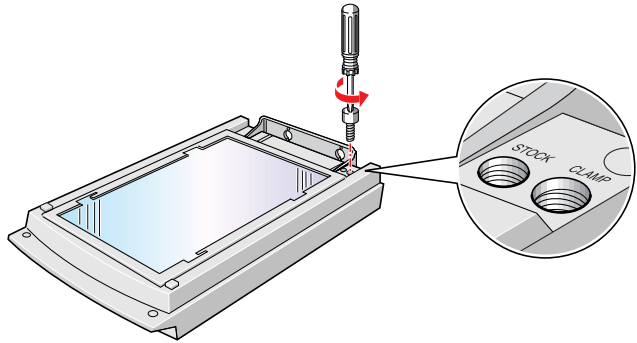

Before transporting the scanner, be sure to reinstall the shipping screw in the hole labeled **CLAMP**, and slide the transportation lock at the back of the scanner to the **LOCK** position.

## Installing the Transparency Unit

Follow these steps to install the transparency unit on the scanner.

1. Make sure the scanner is turned off. Then unplug the power cable from the scanner.
2. Remove the document cover by grasping the back of the document cover as shown and easing the cover up.
3. Make sure the document table is clean and dust free.

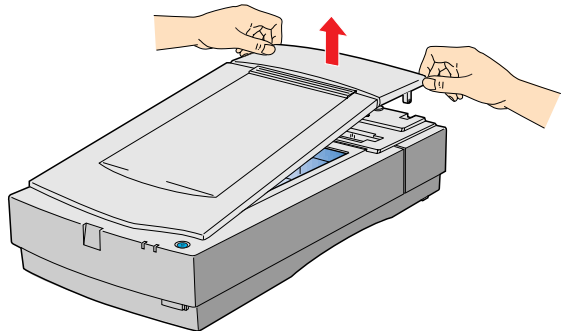

4. Position the slots on the transparency unit's mounting bracket over the heads of the two mounting screws located at the back of the scanner. Slide the transparency unit forward slightly until the two holes in front of these slots are aligned with the screw holes at the back of the scanner.

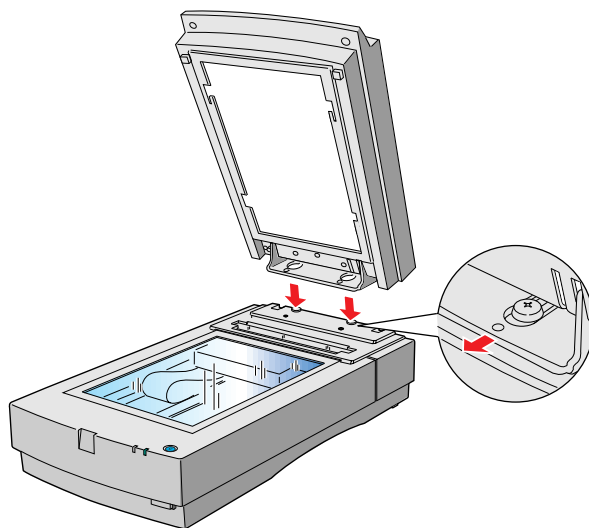

5. Insert the two installation screws that came with the transparency unit into the screw holes, then tighten the screws with a coin.

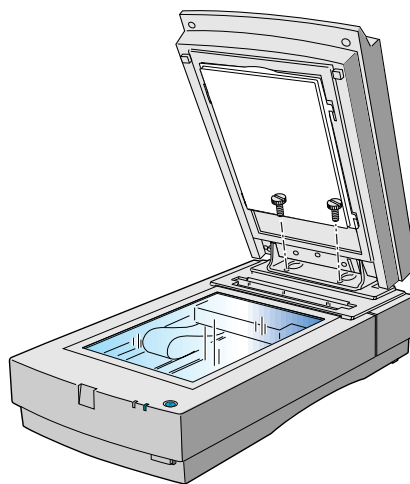

6. Gently close the transparency unit.

7. Attach the transparency unit connector to the **OPTION** connector at the back of the scanner. Tighten the attached screws to secure the connector.

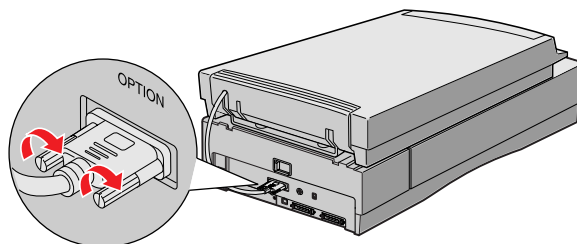

If you haven't connected the scanner to your computer, continue with "Connecting the Scanner to Your Computer" on page 25. Then plug the scanner in and turn it on.

See "Step-by-Step Scanning Instructions" on page 57 for scanning instructions. For more detail on scanning with EPSON TWAIN Pro, see your electronic *EPSON Expression 1600 Software Reference Guide*.

## Using the Film Guides

You can use the four film guides that came with the TPU to scan 35 mm slides, strips of 35 mm negative or positive film, 120-size or 220-size format film, and 4 × 5-inch film.

### Loading 35 mm film

Follow these steps to load 35 mm positive or negative film:

1. Place the 35 mm filmstrip guide on a flat surface and remove the cover from one of the strip holders.
2. Insert a filmstrip in the holder, and then close the cover. The glossy (smooth) side of the film should be facing down, and the film emulsion layer should be facing up.
3. Repeat steps 1 and 2 for all the film strips you scan.

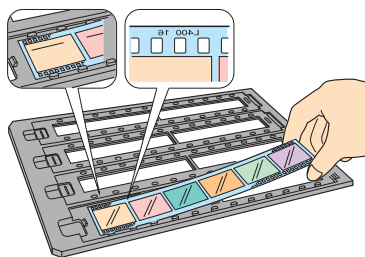
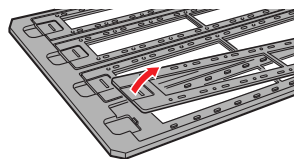

4. Place the 35 mm filmstrip guide on the document table, as shown. Make sure that the upper and right edges of the guide are aligned with the ruled edges of the document table.
5. Close the TPU and begin scanning.

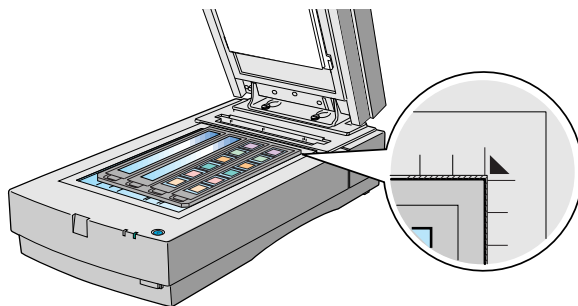

Make sure to select TPU for Neg. Film or TPU for Pos. Film as your Document Source in EPSON TWAIN Pro.

### **Loading 35 mm slides**

Follow these steps to load 35 mm slides:

1. Load slides in the 35 mm slide holder as shown. Make sure the glossy side of each slide faces down, and the film emulsion layer faces up.
2. Position the slide holder on the document table. The upper and right edges of the guide should be aligned with the ruled edges of the document table.
3. Close the TPU and begin your scan.

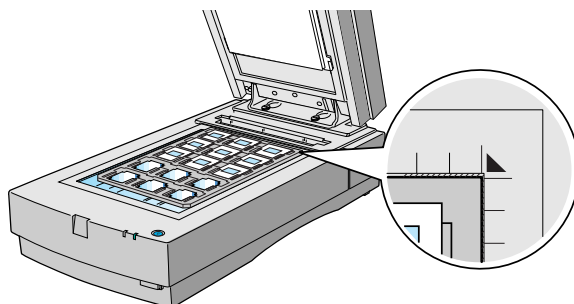
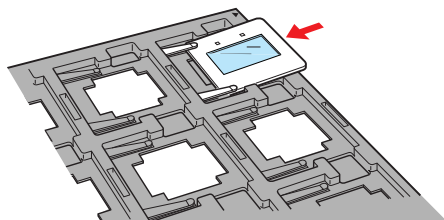

If you're using EPSON TWAIN Pro to scan, make sure to select TPU Pos as your document source.

## Loading 4 × 5-inch film

Follow these steps to load 4 × 5-inch film:

1. Place the 4 × 5-inch film guide on a flat surface and remove the cover from one of the film holders.
2. Insert the film in the film holder, making sure the glossy (smooth) side of the film faces down and the film emulsion layer faces up. Then close the cover.
3. Repeat steps 1 and 2 for all the film you scan.
4. Place the 4 × 5-inch film guide on the document table. Make sure the upper and right edges of the guide are aligned with the ruled edges of the document table.
5. Close the TPU and begin your scan.

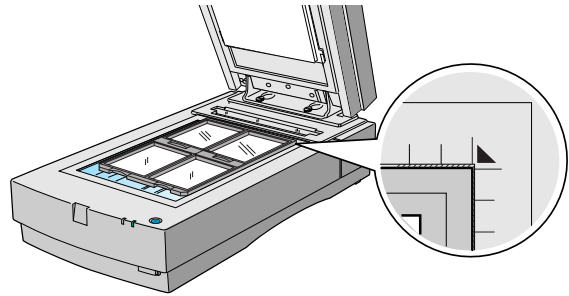
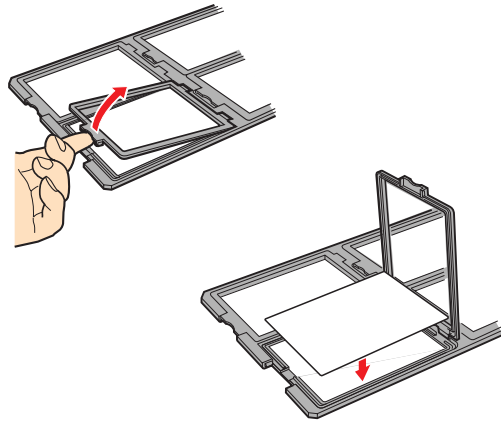

If you're using EPSON TWAIN Pro to scan, make sure to select TPU Neg or TPU Pos as your document source.

## ***Loading 120-size or 220-size (medium format) film***

Follow these steps to load 120-size or 220-size format film:

1. Place the 120/220-size film guide on a flat surface and open the cover for one of the film holders.
2. Insert the film in the film holder, making sure the glossy (smooth) side of the film faces down, and the film emulsion layer faces up. Then close the cover.
3. Repeat steps 1 and 2 for all the film you scan.
4. Place the film guide on the document table. Align the upper and right edges of the guide with the ruled edges of the document table.
5. Close the TPU and begin your scan.

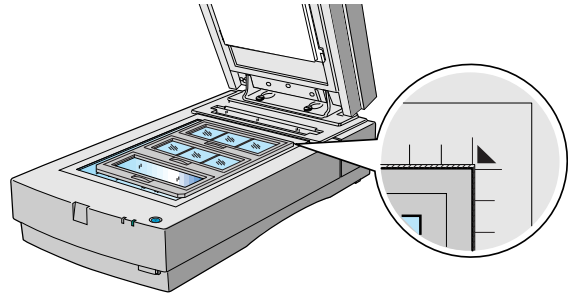
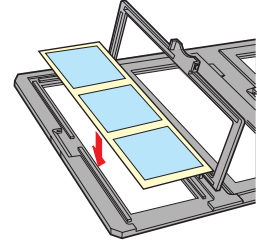
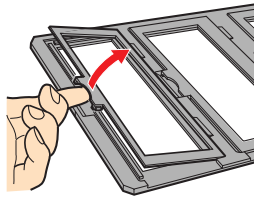

If you're using EPSON TWAIN Pro to scan, make sure to select TPU Neg or TPU Pos as your document source.



## ***Scanning Reflective Documents***

To scan reflective documents with the transparency unit installed, insert the reflective document mat included with the transparency unit.

1. Open the transparency unit. If there's a film guide on the document table, remove it.
2. Insert the tabs on the reflective document mat into the slots on the transparency unit and slide the mat down until the tabs are secure.
3. Place your document face down on the document table and close the transparency unit.
4. Scan according to instructions in "Step-by-Step Scanning Instructions" on page 57.

