

User's Guide

ELPMB87 Extreme short throw Wall Mount

V12H006AZ0

1. General information and compatibility

The support system and the contents of the box consist of 3 parts:

1. Main body (wall plate and adjustable arm)
2. Projector mounting plate (with four M4 screws)
3. Cover assembly

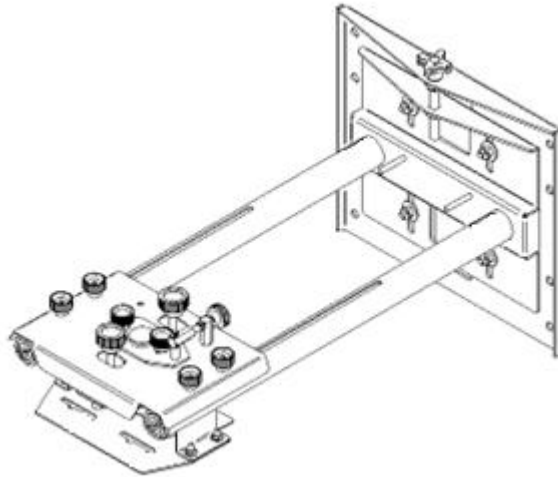

1.

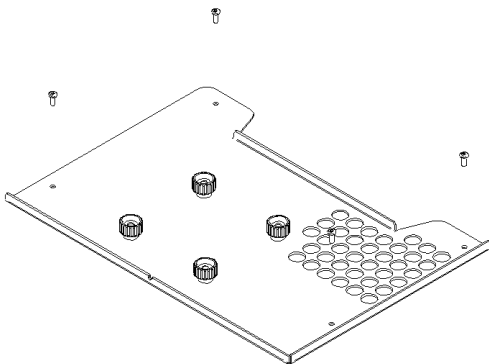

2.

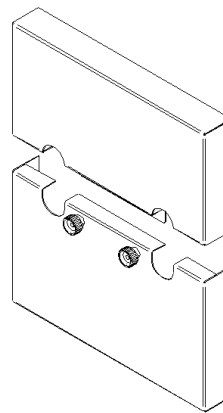

3.

| | |
|--------------------------------|---|
| Dimensions (assembled product) | 22.2 x 13.7 x 14.8 in. (563 x 348 x 377 mm) |
| Material | Steel, Nylon, Brass |
| Weight | 22.3 lb (10.1 kg) |
| Max load | 66.1 lb (30 kg) |

2. How to install the wall mount

The projector, when mounted with the bracket, will have the following dimensions:

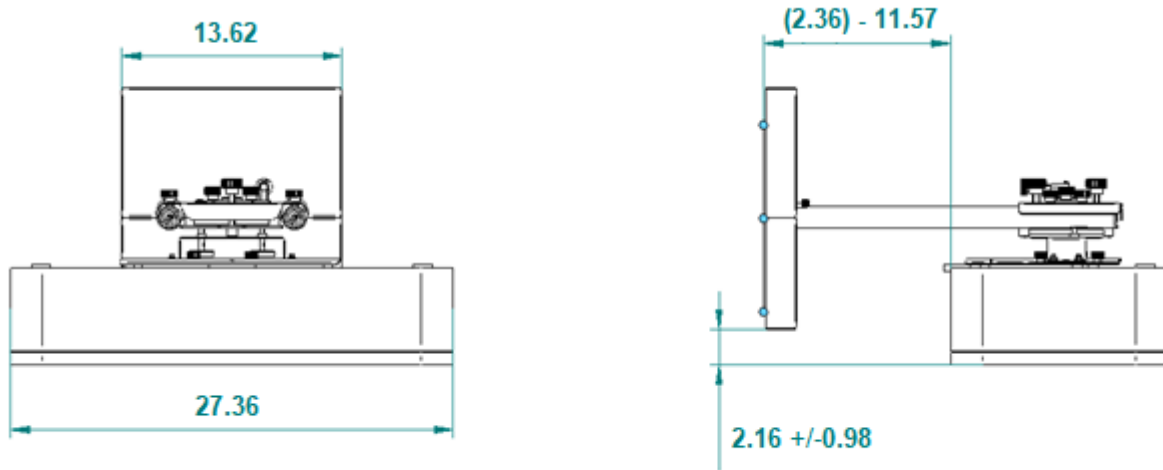

- **Assembly sequence**

- | | |
|---|---------------|
| 1) Install the wall plate on the wall* | A - Wall |
| 2) Attach the arm to the wall plate | B - A |
| 3) Attach the mounting plate to the projector | C - Projector |
| 4) Attach the mounting plate to the arm | B - C |

* Refer to the throw distance calculator available on Epson.com to determine location for mount placement. The mount location will vary based on desired image size and intended location of projected image.

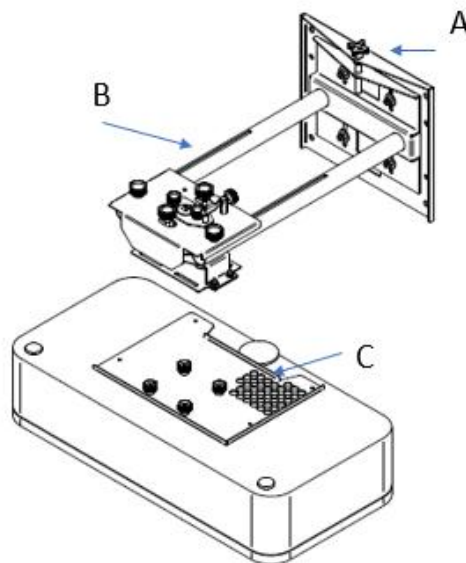

- **Attaching the wall bracket**

The wall bracket must be installed according to the pre-drilled hole pattern.

We recommend using the 4 Ø11 (0.433in) holes on the 296 x 240 mm (11.65 x 9.45 in) rectangle. Because wall materials vary, screws/fasteners for attaching the mount to the wall are not included. Please be sure to use the appropriate type of screws/fasteners for the wall material on which you are installing. Screws/fasteners need to be strong enough to support the combined weight of both the mount (29 lbs.) and projector (23 lbs.) 52 total lbs.

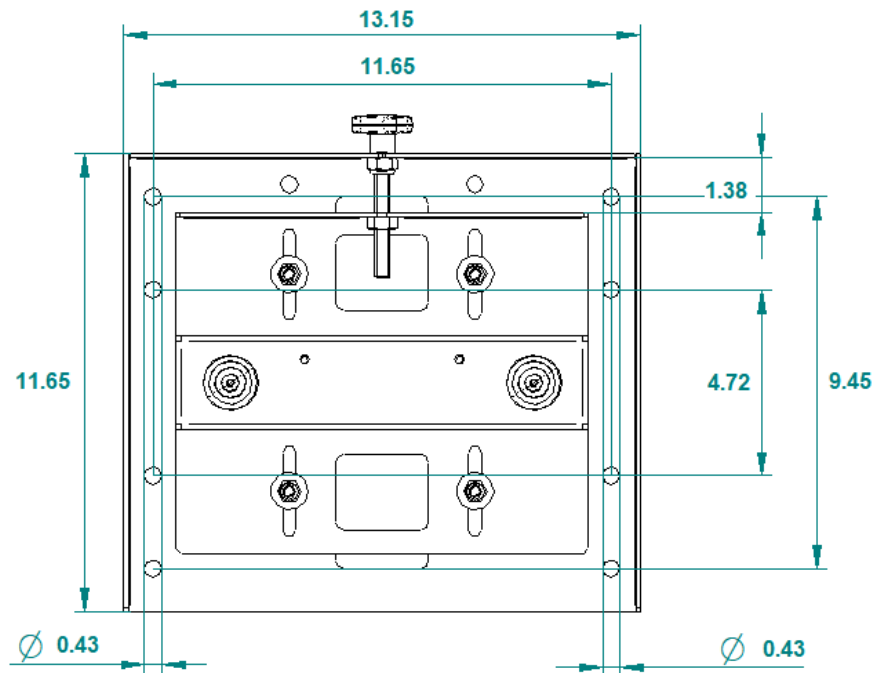

- **Wall Plate Positioning**

The distance from the bottom of the wall plate to the top of the image varies by the size and aspect ratio of the projected image. Prior to installing the wall plate, determine the desired aspect ratio, image size, and location of where the top of the image will appear. With this information, use the table below to determine the placement of the wall plate relative to the top of the image (distance A) as shown.

| In inches Image Size (Diagonal) | Distance A | | | |
|---------------------------------------|----------------|-----------------|----------------|----------------|
| | 16:9 Aspect | 16:10 Aspect | 21:9 Aspect | 16:6 Aspect |
| 80" | 6.25" | 6.75" | 11.6" | 13.8" |
| 90" | 7" | 7.6" | 13" | 15.5" |
| 100" | 7.9" | 8.5" | 14.5" | 17.25" |
| 110" | 8.7" | 9.4" | 15.9" | 19" |
| 120" | 9.5" | 10.25" | 17.4" | 20.7" |
| 130" | 10.25" | 11.2" | 18.9" | 22.5" |
| 140" | 11" | 12" | 20.25" | 24.25" |
| 150" | 11.75" | 12.75" | 21.7" | 26" |
| 160" | 12.5" | | | |

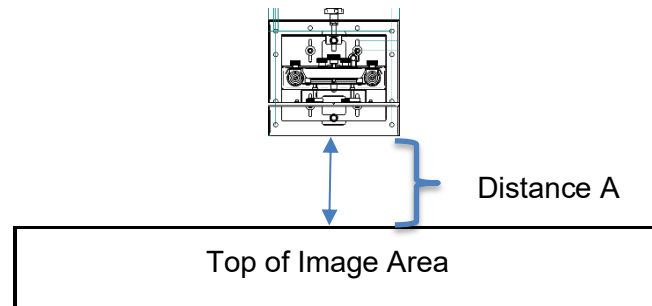

Note:

The center of wall plate should align with the center of image area.

If it is necessary to use the two holes marked in the illustration below for greater installation security, please note that the vertical slide system, which allows ± 25 mm (0.984in) adjustment will only allow a 25 mm (0.984in) downward adjustment (from the 'zero' position, as shown in the illustration).

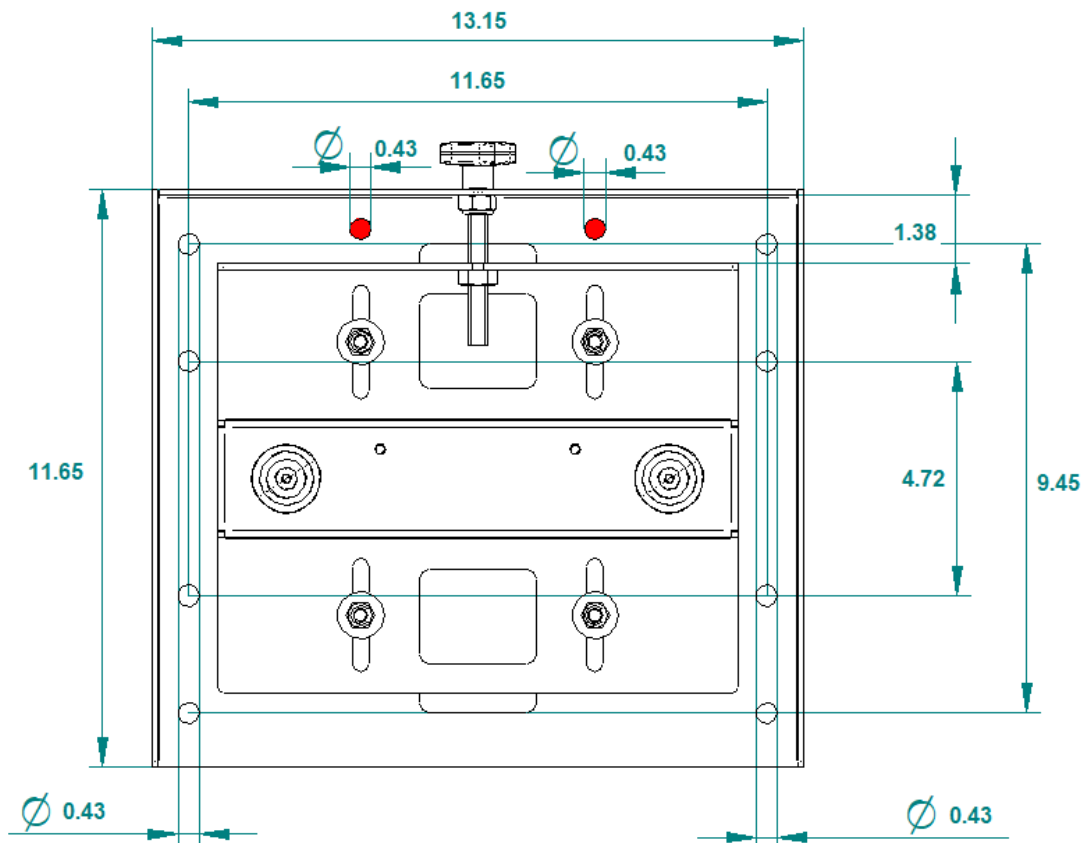

- **Attaching the projector**

Use the 4 M4 screws supplied to secure the plate to the projector as shown in the illustration.

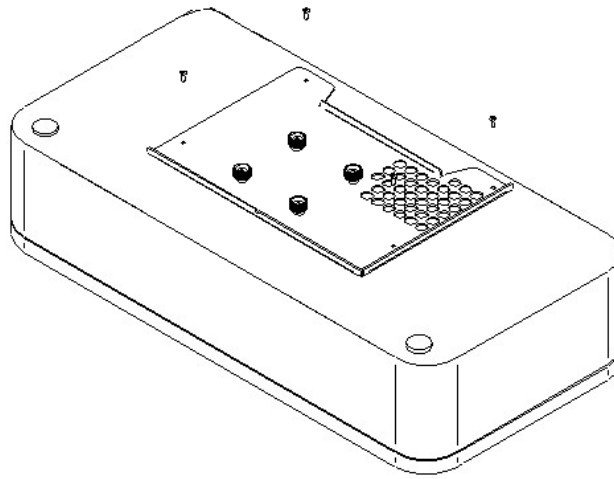

Hang the projector from the bottom using the 4 knobs (previously loosened by 3 turns), then secure the projector in the desired position in the available slot.

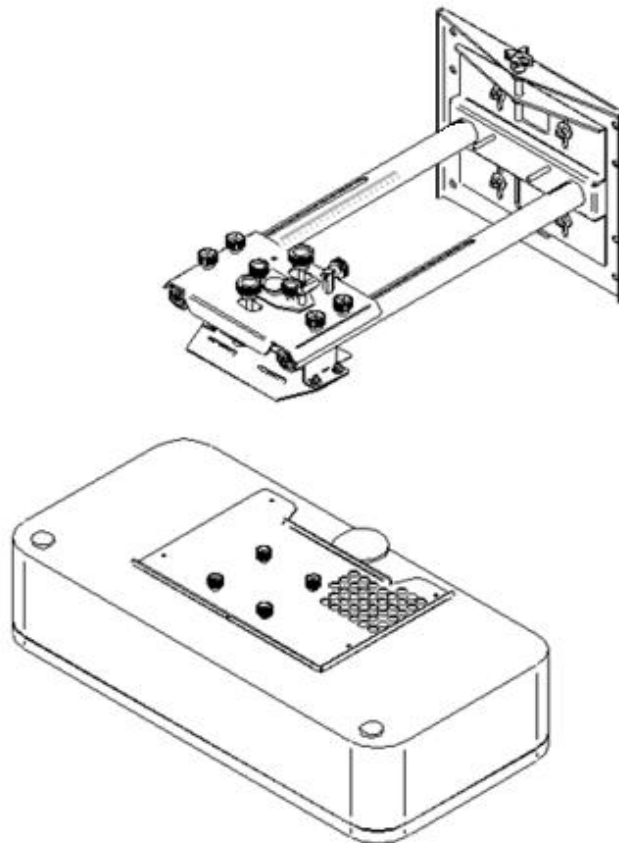

The mount also allows +/- 10 degrees of roll and pitch, using the knobs highlighted below.

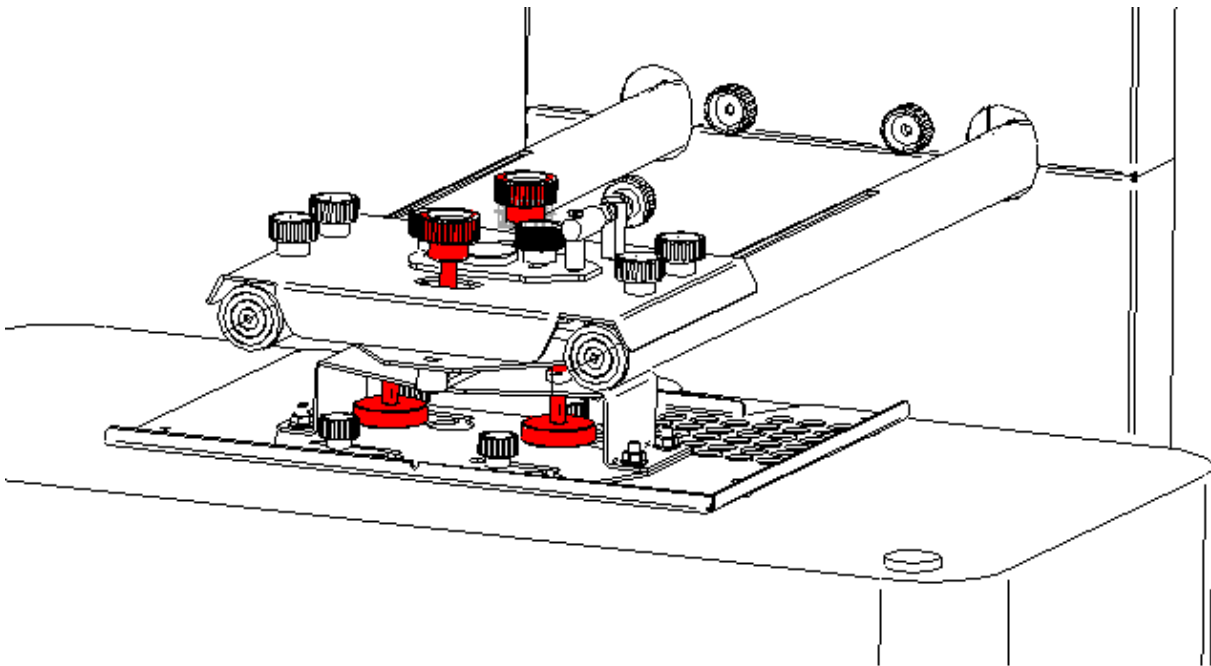

The rotation on a vertical axis is performed with the knob highlighted below.

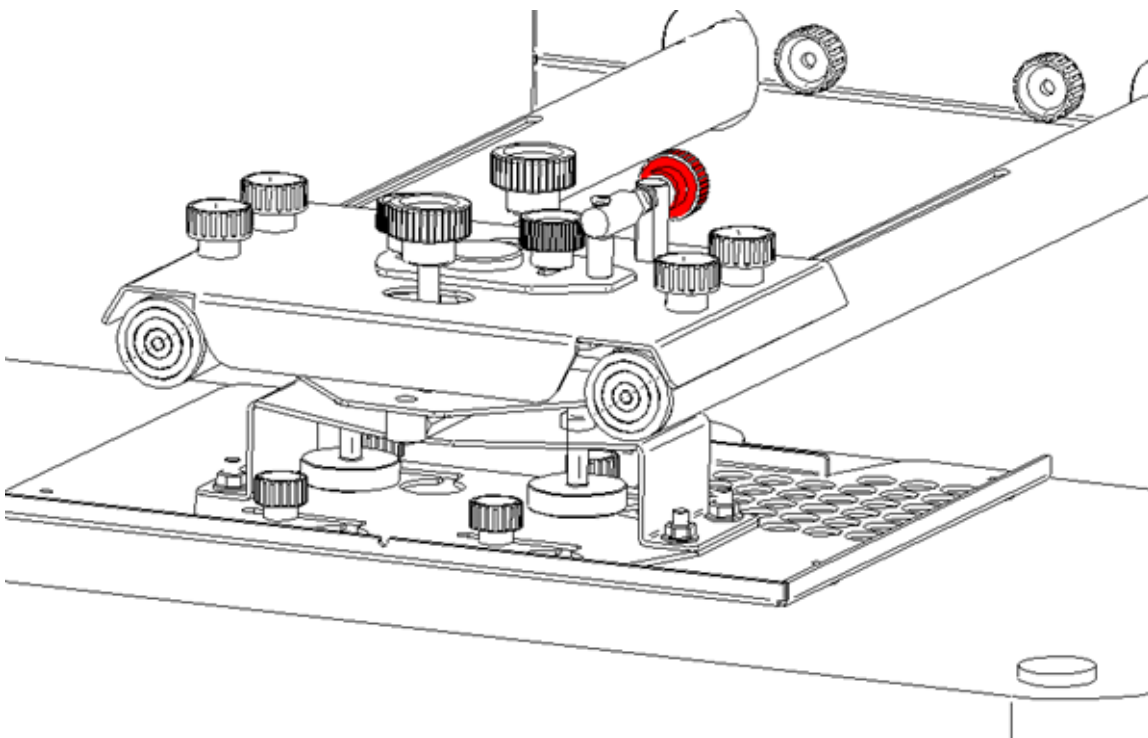

- **Installation note:**

The screws on the calibration structure should not be removed.
Use only the knobs for calibration.

- **Attaching the Cover Assembly**

Attach the bottom cover first, by aligning the holes with the 2 protruding screws.

Before screwing in the knobs, attach the top cover and align it with the 2 screws.

Finally, secure the covers by screwing on the 2 knobs (do not overtighten or you may dent the cover).

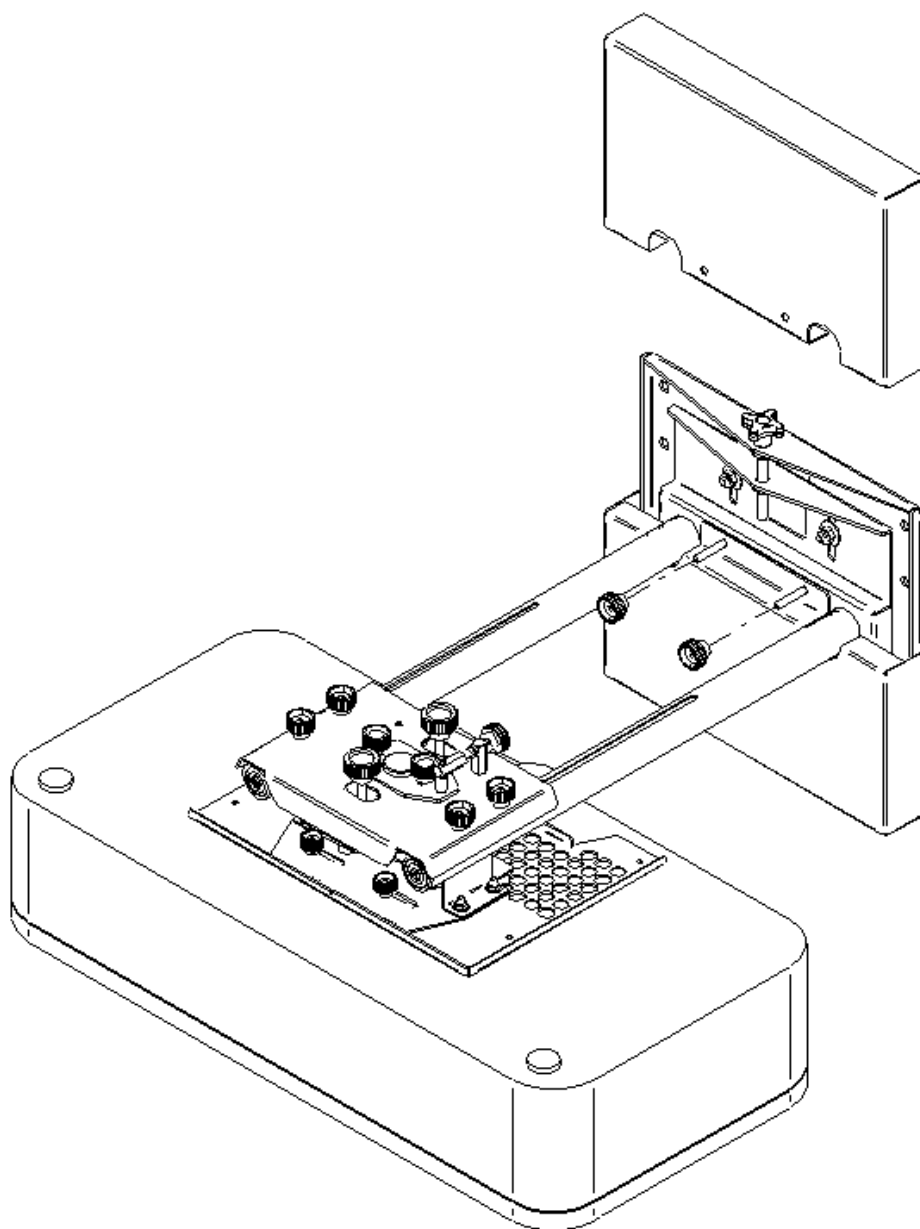

- **Where to get help**

To use the Epson PrivateLine Support service, call (800) 637-7661. This service is available for the duration of your warranty period. You may also speak with a projector support specialist by dialing (562) 276-4394 (U.S.) or (905) 709-3839 (Canada).

Support hours are Monday through Friday, 7 a.m. to 4 p.m., Pacific Time.

Days and hours of support are subject to change without notice. Toll charges may apply.

Before you call, have the following information ready:

- Product name
- Product serial number (located on the bottom or rear of the projector, or in the menu system)
- Proof of purchase (invoice) and date of purchase
- Computer or video configuration
- Description of the problem

