

# Installation and Assembly: Universal Projector Ceiling Mount

Model: ELPMBPJF

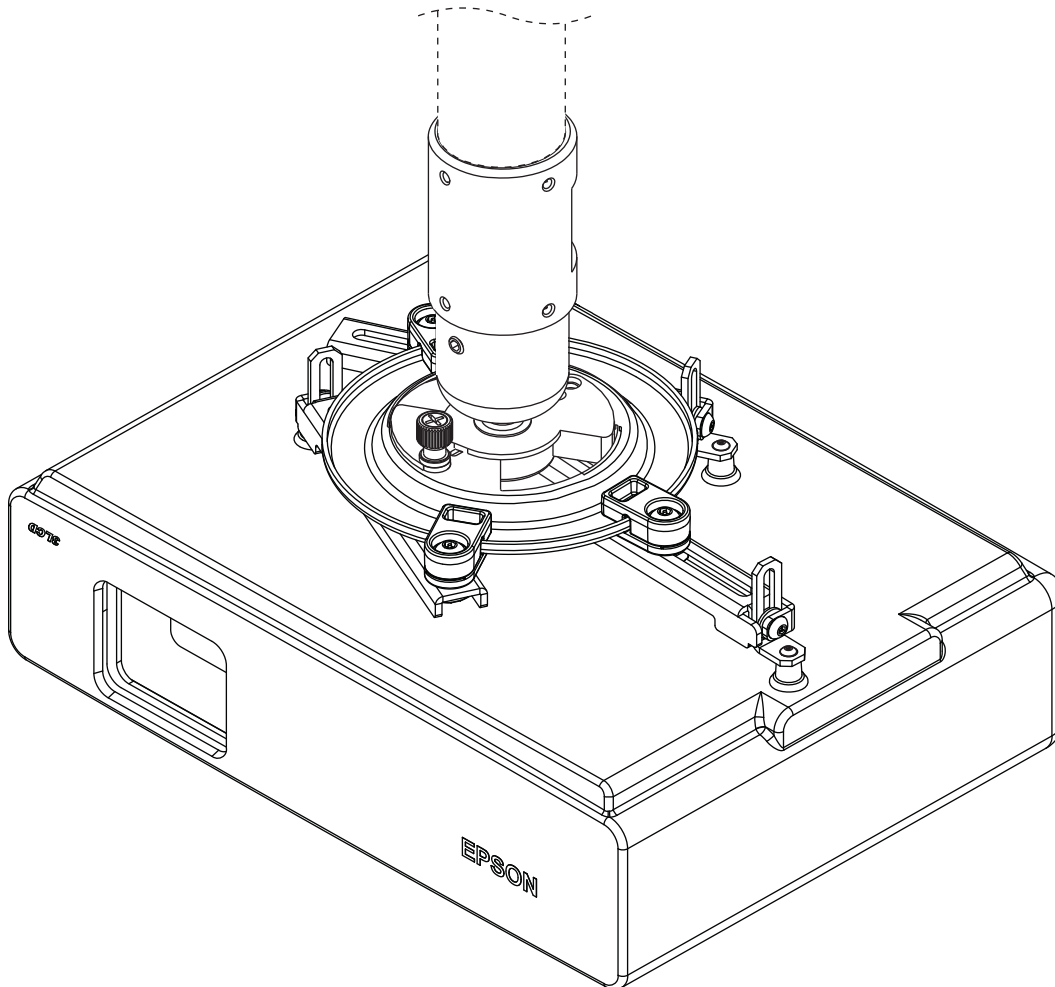

This product is UL Listed. It must be installed by a qualified professional installer.



**Maximum UL Load Capacity: 50 lb (22.7 kg)**

**NOTE:** Read entire instruction sheet before you start installation and assembly.

## **WARNING**

- Do not begin to install your product until you have read and understood the instructions and warnings contained in this Installation Sheet. If you have any questions regarding any of the instructions or warnings, call Peerless customer care at 1-800-729-0307.
- This product should only be installed by someone of good mechanical aptitude, has experience with basic building construction, and fully understands these instructions.
- Make sure that the supporting surface will safely support the combined load of the equipment and all attached hardware and components.
- Never exceed the Maximum UL Load Capacity.
- Always use an assistant or mechanical lifting equipment to safely lift and position equipment.
- This product is intended for indoor use only. Use of this product outdoors could lead to product failure and personal injury.
- Tighten screws firmly, but do not overtighten. Overtightening can damage the items, greatly reducing their holding power. See suggested torque values where applicable within these instructions.
- When installing or adjusting the ceiling mount, do not use adhesives, lubricants, or oils to prevent the screws from loosening. If you use adhesives, lubricants, or oils to prevent the screws from loosening, the casing may crack and the projector may fall, causing serious injury and damage to the projector.

### **Tools Needed for Assembly**

- stud finder ("edge to edge" stud finder is recommended)
- phillips screwdriver
- drill
- 1/4" bit for concrete surface
- 5/32" bit for wood joist

### **Table of Contents**

Parts List.....	3
Installation to Extension Column .....	4
Installation to Wood Joist Ceilings.....	5
Installation to Concrete Ceilings .....	6
Flush Mount Application .....	7
Attaching Adapter Plate to Projector.....	7-8
Attaching Adapter Plate to Projector Mount.....	8
Projector Alignment and Accessories .....	9
Warranty Information .....	10

Before you start check the parts list to ensure all of the parts shown are included.

## Parts List

Description	Qty.	Part Number
A projector mount	1	055-0016
B 4 mm security allen wrench	1	560-9646
C M5 x .8 x 10 mm socket pin type F screw	1	520-2031
D #10-32 x 3/8" spade thumb screw	1	560-2107
E #10-32 x 3/8" serrated washer head socket pin screw	1	520-2151
F #14 x 2.5" phillips hex head wood screw	2	5S1-015-C04
G ceiling plate	1	580-4042
H .25" ID x .56" OD x .26 spacer	2	590-2071
I extension column connector with cord management	1	580-4025
J #10-32 x 3/8" socket pin screw	2	520-2084
K #10-32 x 3/16" slotted set screw	3	520-2187
L adapter plate	1	055-KUNV-S-3
M M3 x 8 mm serrated washer head socket pin screw	4	510-2004
N M4 x 10 mm serrated washer head socket pin screw	4	510-2060
O M5 x 10 mm serrated washer head socket pin screw	4	510-2063
P M6 x 10 mm serrated washer head socket pin screw	4	510-2066
Q 2 mm security allen wrench	1	560-1097
R washer	4	540-2025

**NOTE:** Actual parts may appear slightly different than illustrated.

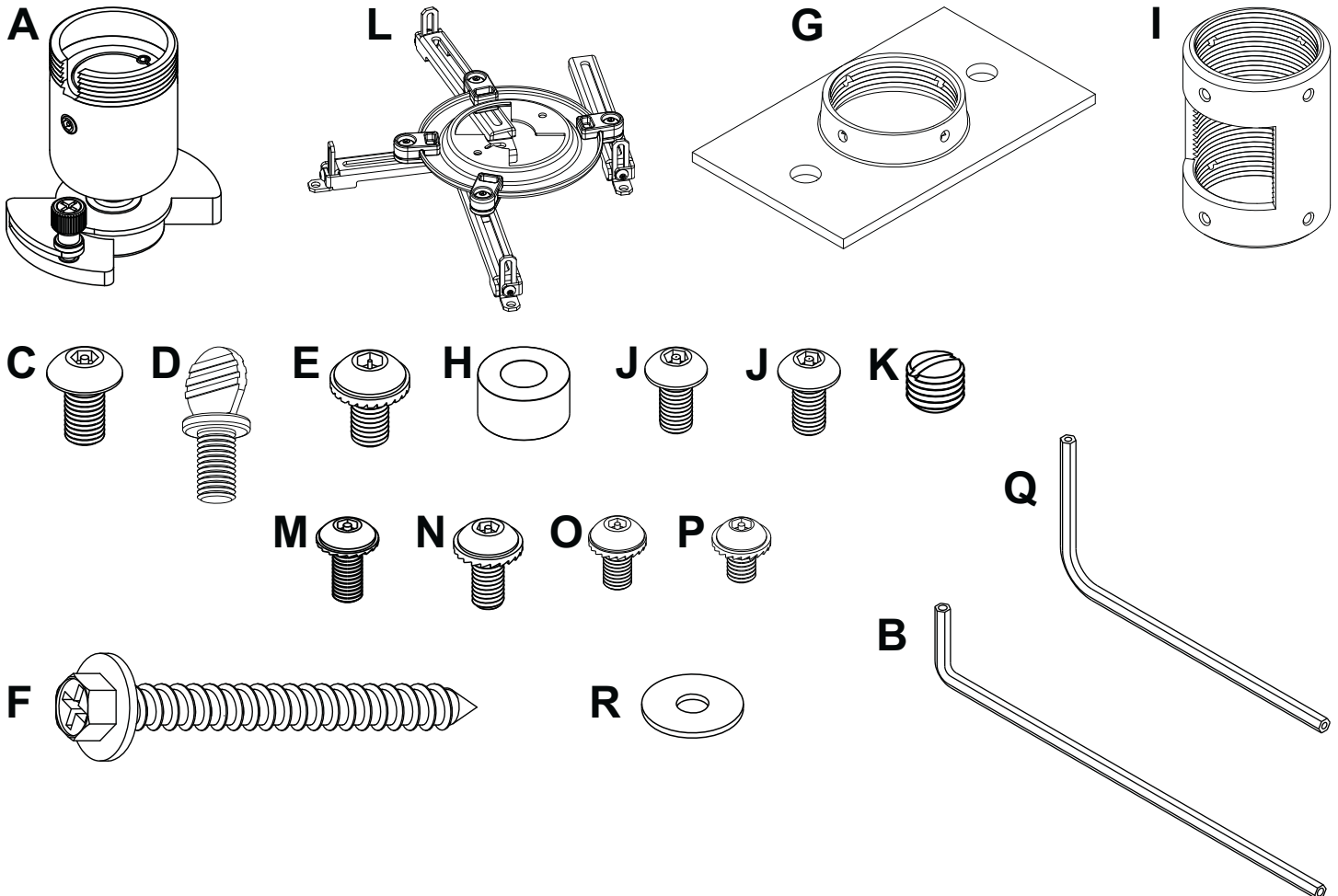

# Installation to Extension Column

**1** Screw extension column (sold separately) to ceiling plate (**G**). Align the notch with one of the four holes in the ceiling plate (**G**) and secure extension column with a M5 x 10 mm socket pin screw (**C**) using security allen wrench (**B**). See detail 1.

Screw extension column connector (**I**) to extension column. Align slot in extension column with one of the top holes in extension column connector (**I**). Insert and tighten one #10-32 x 3/8" socket pin screw (**J**) through extension column connector (**I**) into slot on extension column using security allen wrench (**B**). See detail 2.

Screw projector mount (**A**) into extension column connector (**I**). Align slot in projector mount (**A**) to one of the bottom holes in extension column connector (**I**). Insert and tighten one #10-32 x 3/8" socket pin screw (**J**) through extension column connector into slot in projector mount (**A**) using security allen wrench (**B**). See detail 3.

**\*NOTE:** Slotted set screws (**K**) are used to jam against the threads of each connecting joint to prevent any excess movement. Do not overtighten screws; overtightening screws will damage threads making it difficult to separate the products.

**Skip to step 2.**

UL Listed ELPMBP01, ELPMBP02, ELPMBP03  
or UL Listed CMJ and ACC Series Ceiling Mounts  
(Sold Separately).

EXTENSION COLUMN  
(UL Listed ELPMBC01,  
EXT or ADJ Series)  
(Sold Separately)

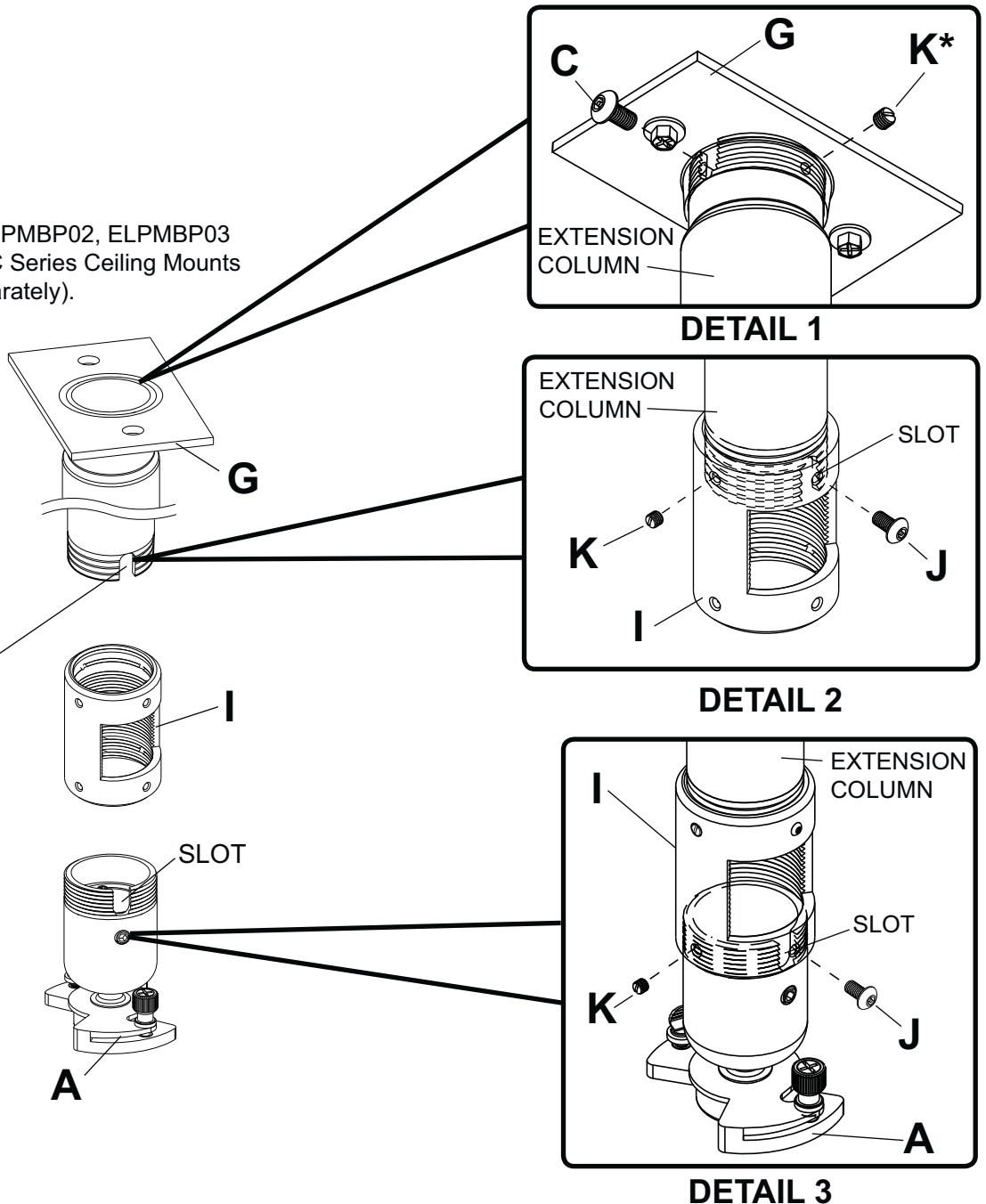

## Installation To Wood Joist Ceilings

- 1 Drill two 5/32" (4 mm) dia. holes to a minimum depth of 2.5" (64 mm). Attach ceiling plate (G) with two #14 x 2.5" (6 mm x 65 mm) wood screws (F) as shown using 3/8" (10 mm) socket wrench.

**Skip to step 2.**

### ⚠ WARNING

- Tighten wood screws (F) so that wall plate (G) is firmly attached, but do not overtighten. Overtightening can damage the screws, greatly reducing their holding power.
- Never tighten in excess of 80 in • lb (9 N.M.).
- Make sure that mounting screws are anchored into the center of the studs. The use of an "edge to edge" stud finder is highly recommended.

### ⚠ WARNING

- It is the responsibility of the installer to verify that the supporting surface will safely support the combined load of all attached hardware and components.

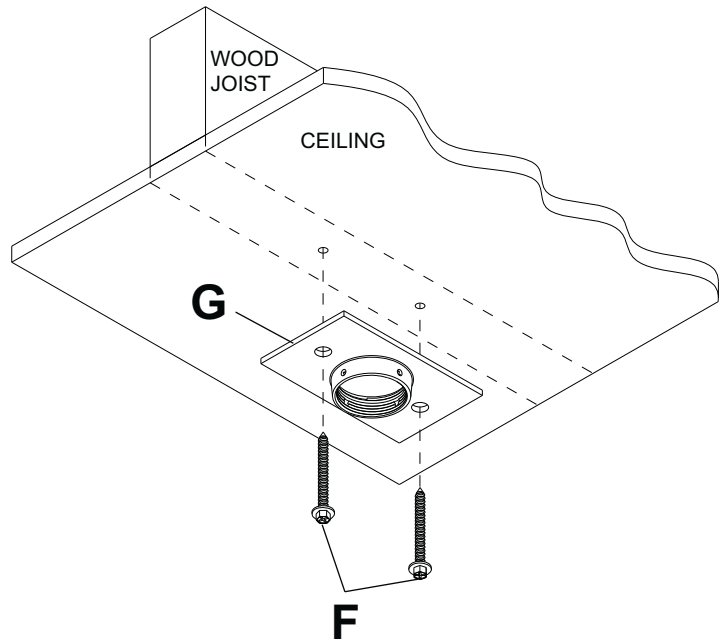

**IMPORTANT: Be sure to drill holes into the joist CENTER!**

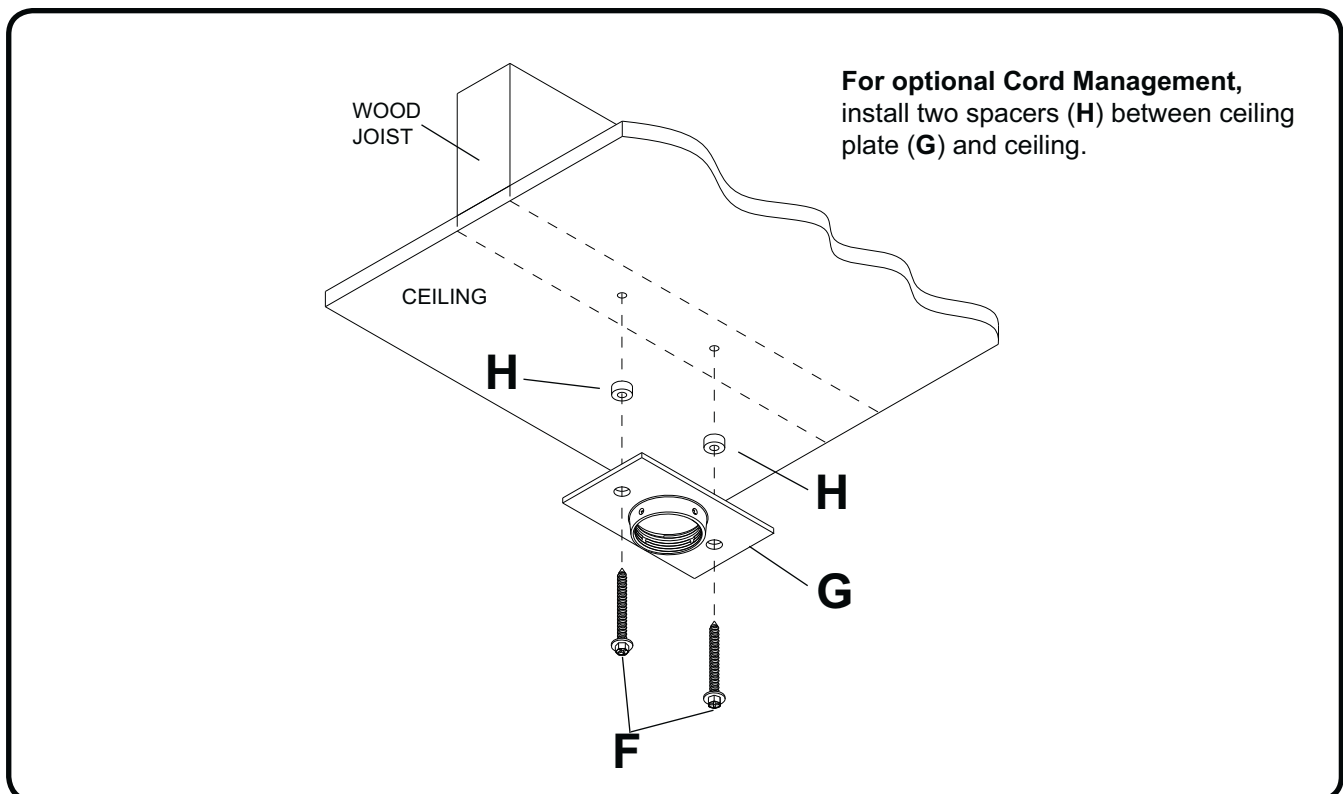

# Installation to Solid Concrete or Cinder Block

## ⚠ WARNING

- When installing Peerless wall mounts on cinder block, verify that you have a minimum of 1-3/8" of actual concrete thickness in the hole to be used for the concrete anchors. Do not drill into mortar joints! Be sure to mount in a solid part of the block, generally 1" minimum from the side of the block. Cinder block must meet ASTM C-90 specifications. It is suggested that a standard electric drill on slow setting is used to drill the hole instead of a hammer drill to avoid breaking out the back of the hole when entering a void or cavity.
- Concrete must be 2000 psi density minimum. Lighter density concrete may not hold concrete anchor.
- Make sure that the supporting surface will safely support the combined load of the equipment and all attached hardware and components.

### 1 NOTE: ACC233 (concrete anchors are not included) are recommended.

Drill two 5/16" (8 mm) dia. holes to a minimum depth of 2.5" (64 mm). Attach ceiling plate (G) using two concrete anchors and #14 x 2.5" wood screws (F) as shown in **Illustration A** and 1, 2 and 3. Tighten all fasteners.

**IMPORTANT: It is the responsibility of the installer to verify that the ceiling will safely support the combined load of all attached hardware and components.**

*Skip to step 2.*

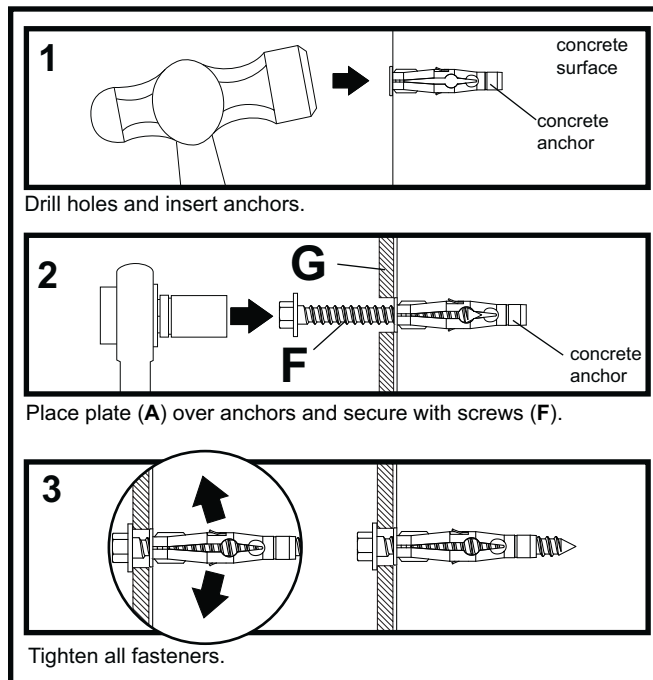

## ⚠ WARNING

- Tighten screws so that wall plate is firmly attached, but do not overtighten. Overtightening can damage screws, greatly reducing their holding power.
- Never tighten in excess of 80 in. • lb (9 N.M.).

## ⚠ WARNING

- Always attach concrete anchors directly to load-bearing concrete.
- Never attach concrete anchors to concrete covered with plaster, drywall, or other finishing material. If mounting to concrete surfaces covered with a finishing surface is unavoidable (not evaluated by UL), the finishing surface must be counterbored as shown below. Be sure concrete anchors do not pull away from concrete when tightening screws. If plaster/drywall is thicker than 5/8", custom fasteners must be supplied by installer (not evaluated by UL).

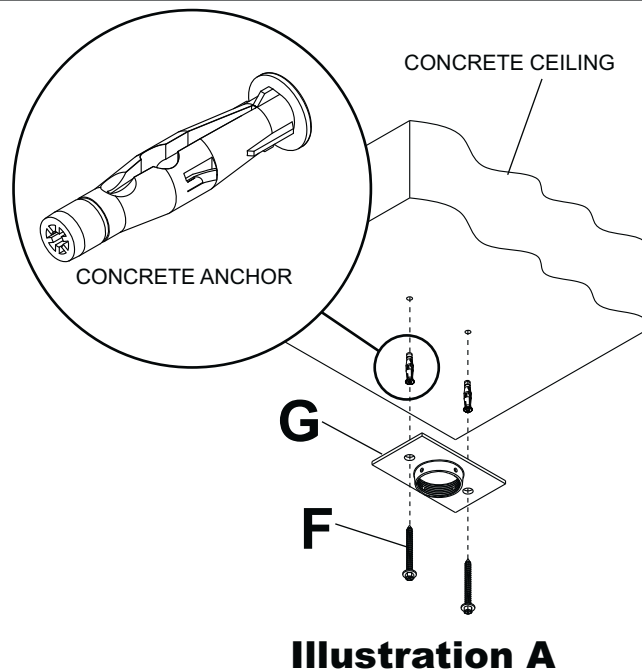
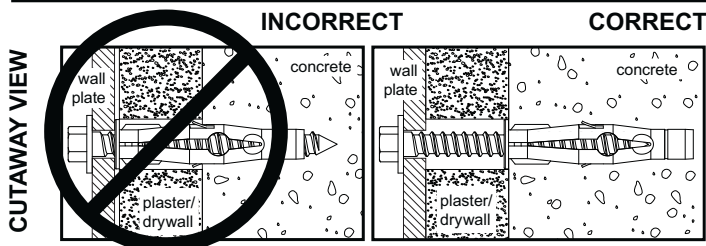

## Flush Mount Application

- 1** Screw projector mount (A) into ceiling plate (G). Align the notch with one of the four holes of the ceiling plate (G) and secure projector mount (A) with a M5 x 10 mm socket pin screw (C) using security allen wrench (B) as shown in **detail 1**.

**NOTE:** Slotted set screw (K) is used to jam against the threads of mount to prevent any excess movement of the projector mount (A). Do not overtighten screw; overtightening screw will damage threads making it difficult to separate the products.

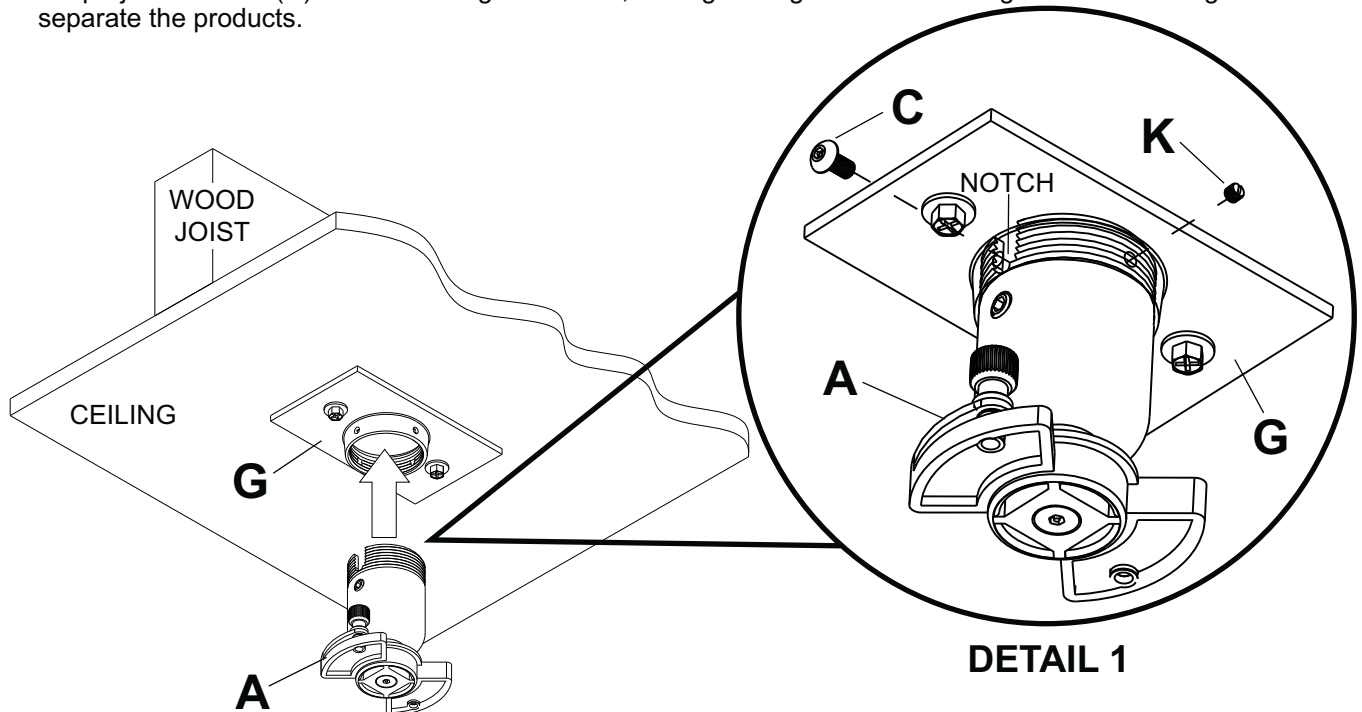

## Attaching Adapter Plate to Projector

- 2** **NOTE:** The projector you are installing may differ in appearance from the sample illustrated below.

**NOTE:** Some projectors may have three or four attachment points. If projector has three attachment points, the unused leg may be removed.

Place projector upside down. Locate adapter plate (L) with notch\* facing forward as close to projector center of gravity as possible without covering any mounting holes. Loosen channels, and if there are only three mounting holes remove fourth channel. Using one channel for each mounting hole, position feet of channels over mounting holes as shown. **Important:** If projector does not have at least three mounting holes, do not use this adapter plate. Once channels are in position retighten fasteners.

**NOTE:** Some projectors have feet which can be removed and the corresponding threaded insert can be used for a mounting hole.

\*Notch indicates front of projector.

## CAUTION

- It is the responsibility of the installer to ensure that the projector is properly ventilated. Feet of channels are used to raise the mount off the projector surface.

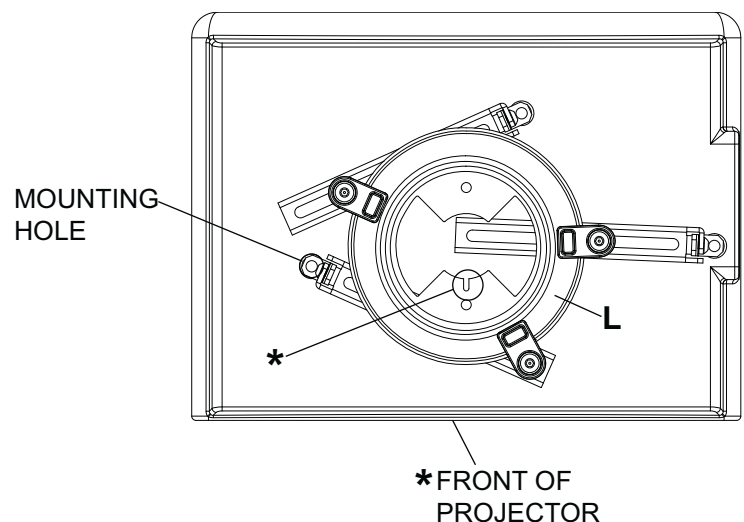

**3**

Attach adapter plate (L) to projector using one screw (M, N, O or P) for each channel as shown. Tighten all screws, while keeping the center of gravity. Be sure that adapter plate (L) is straight. Adjust the feet of the channels to keep the adapter plate level. Tighten all screws with 4 mm security allen wrench (B) or wrench provided with projector mount, while keeping the center of gravity. If M3 screws are used, tighten using 2 mm security allen wrench (Q).

**NOTE:** Projectors may require different size screws for mounting. Use a combination of screws (M, N, O or P) and foot adjustment that will result in channels of adapter plate (L) fitting tightly against projector.

**Important:** In order to properly engage the threads in the mounting holes, the screw must be turned at least 3 full turns.

**NOTE:** If using screw (M), place washer (R) between screw (M) and foot of channel.

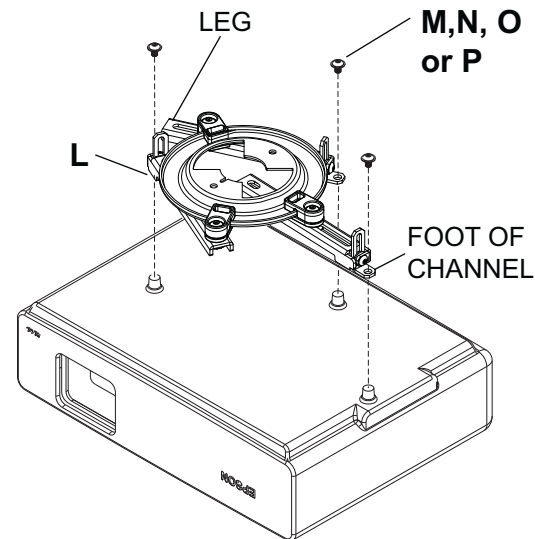

## Attaching Adapter Plate to Projector Mount

**4**

Attach projector, with adapter plate already on it, to the projector mount (A) by inserting the projector mount (A) into the adapter plate connection and twisting until the adapter plate will no longer turn (about 75°). The spring loaded captive screw should line up with a corresponding hole on the adapter plate (this should line up automatically when the two are connected). Push down and tighten the spring loaded captive screw to secure the adapter plate to the mount. If not using the optional security feature, fasten thumb screw (D) in the hole opposite the spring loaded captive screw.

**OPTIONAL:** For security option, use #10-32 x 3/8" security screw (E) in the hole opposite the spring loaded captive screw. Tighten with security allen wrench (B). This will prevent the projector from being removed.

**NOTE:** Be sure to only use the #10-32 x 3/8" screw (E) (or the thumb screw (D) opposite the spring loaded captive screw).

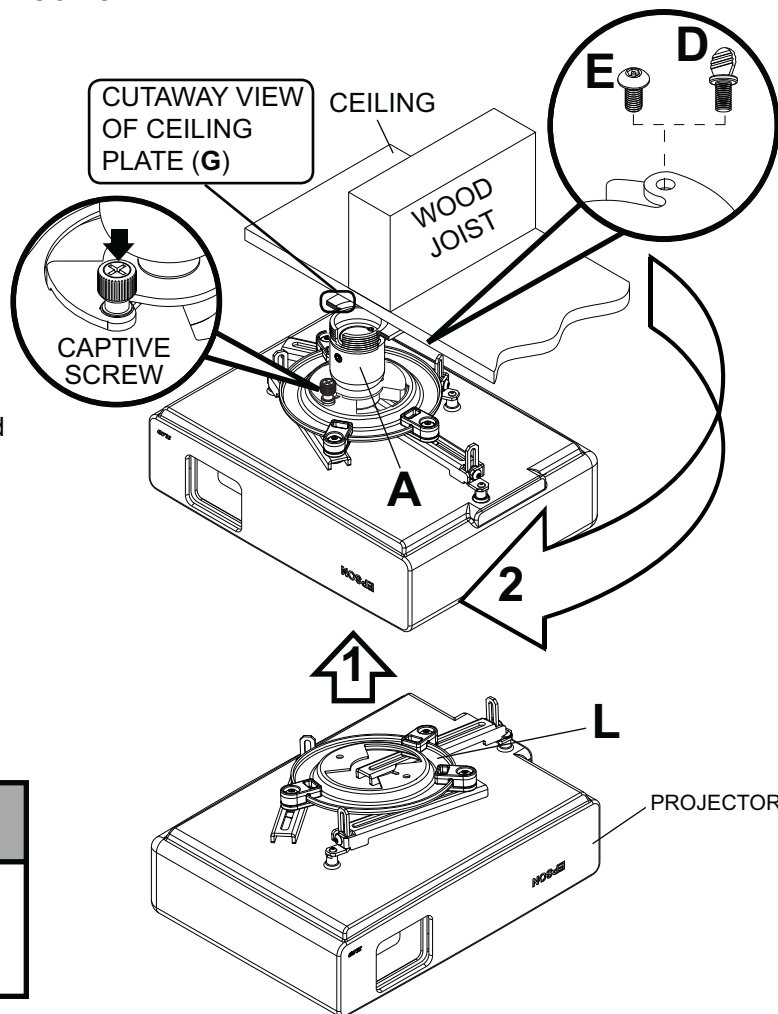

### **⚠ WARNING**

- Do not lift more weight than you can handle! Use additional man power or mechanical lifting equipment to safely handle placement of the projector!



## Projector Alignment

- 5** To adjust roll, pitch and yaw loosen the set screw (shown below) using allen wrench (B). You should be able to just slightly loosen the screw so that your adjustments can be set without having to hold the projector. Move projector to desired position and slowly tighten set screw.

**IMPORTANT: Allen wrench is your key for projector removal. Store it in a safe place.**

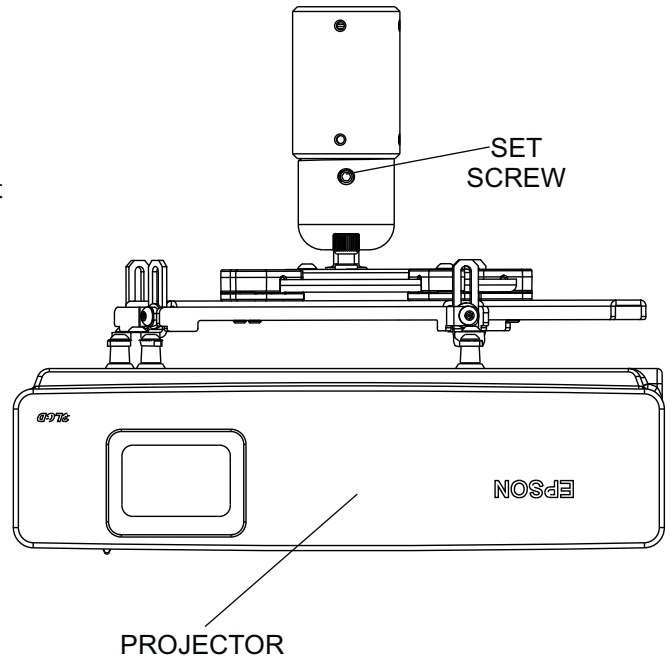

## Accessories

**NOTE:** All accessories are available for purchase through Epson ([www.epson.com](http://www.epson.com))

### ELPMBP01

#### Adjustable Suspended Ceiling Channel Kit

- Adjustable carriage allows for ideal projector positioning below a 2' x 2' or 2' x 4' standard ceiling tile
- Pre-assembled, easy to install design reduces installation time
- Knockouts are provided for electrical outlet boxes and antenna leads
- Escutcheon ring leaves a clean finish
- Compact and lightweight
- Includes Kwik-Loc™ self locking cable joiners for simple cable support set-up

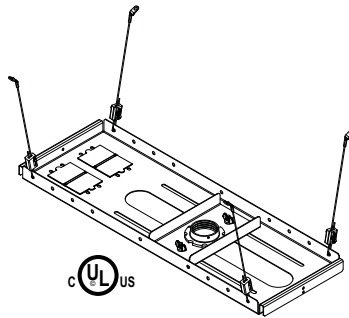

### ELPMBP02

#### False Ceiling Plate Kit

- Replaces a 2' x 2' ceiling tile and mounts to structural ceiling with tie wires
- Two-piece design offers five different points for mount attachment
- Includes tie wire supports and flush mount tube
- 1 1/2" - 11.5" NPT fitting for attachment of adjustable extension column
- Two knockout panels for electrical outlet boxes
- Max weight load: 50 lb (23 kg.)
- Color: White

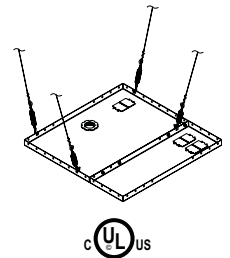

### ELPMBP03

#### Structural Round Ceiling Plate

- Mounts to wood joist or structural concrete ceiling
- Features cable management access hole
- 1 1/2" - 11.5" NPT fitting for attachment of adjustable extension column
- Max weight load: 150 lb (68 kg.)
- Color: White

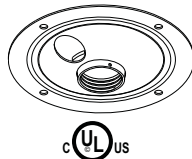

### ELPMBP01

#### Adjustable Extension Column (Pipe) 8" - 11"

- 8" - 11" adjustable extension in 1" increments
- Specially designed to allow internal cable management
- 1 1/2" - 11.5" NPT pipe threaded on both ends
- Notched ends for use with set screw to provide safety and security
- Color: White

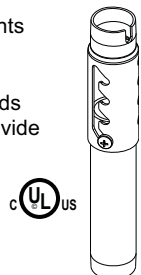

# LIMITED FIVE-YEAR WARRANTY

Peerless Industries, Inc. establishes a warranty period of five years for products manufactured or supplied by Peerless. This period commences from the date of sale of the product to the original consumer, but will in no case last for more than six years after the date of the product's manufacture. During the warranty period such products will be free from defects in material and workmanship, provided they are installed and used in compliance with the instructions established by Peerless Industries, Inc. Subject to applicable legal requirements, during the warranty period Peerless will repair or replace, or refund the purchase price of, any such product which fails to conform with this warranty.

Any other warranties prescribed by the law which may apply with respect to such products also are limited in duration to the warranty period specified in this Limited Five-Year Warranty.

This warranty does not cover damage caused by (a) service or repairs by the customer or a person who is not authorized for such service or repairs by Peerless Industries, Inc., (b) the failure to utilize proper packing when returning the product, (c) incorrect installation or the failure to follow Peerless' instructions or warnings when installing, using or storing the product, or (d) misuse or accident, in transit or otherwise, including in cases of third party actions and force majeure.

In no event shall Peerless be liable for incidental or consequential damages or damages arising from the theft of any product, whether or not secured by a security device which may be included with the product.

This Limited Five-Year Warranty is in lieu of all other warranties, expressed or implied, and is the sole remedy with respect to product defects. No retailer, dealer, distributor, installer or other person is authorized to modify or extend this warranty or impose any obligation on Peerless in connection with the sale of any product manufactured or supplied by Peerless.

This warranty gives specific legal rights, and you may also have other rights provided by the national legislation of the country in which you purchased such product.

**peerless**<sup>®</sup>

[www.peerlessmounts.com](http://www.peerlessmounts.com)

© 2008 Peerless Industries, Inc.