

Epson® SureColor® F10070

Handling and Unpacking Instructions for the Main Unit and Option Set

- * **No Stacking**
- * **Handling Instructions for Forklift**
- * **Unpacking Instructions**

Shipment and transportation/carry flow

List of shipments

This product is shipped with the following configurations.

c/No.	Item	quantity	Size (ft)			N/W (lb)	G/W (lb)
			L	W	H		
001	Main Body	1	12.6	3.7	6.1	1259	1991
002	Option set	1	12.6	3.7	4.4	361	728

Dimensions are the size after packing.

Note: No Stacking

Main body

Prohibition of stacking

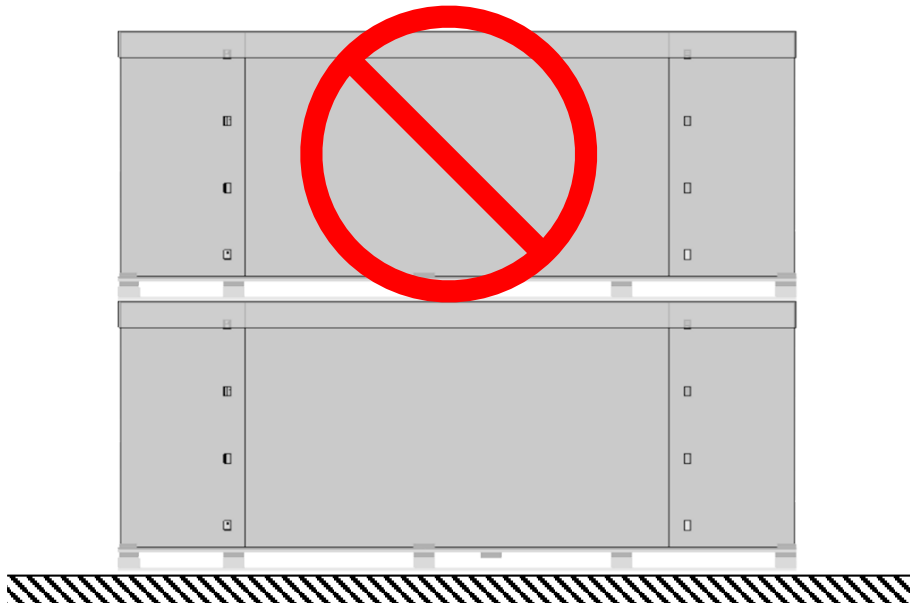

Option set

Prohibition of stacking

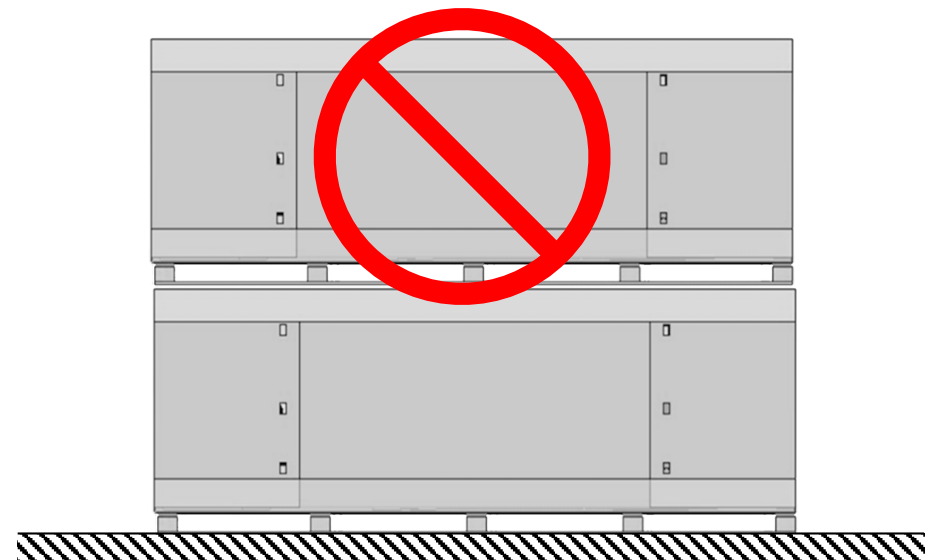

SC F10070 Lifting Points - Main Unit

Location of correct lifting positions on the rear side and prohibited areas.



Caution

Do not lift where prohibited.

If lifting from an incorrect position, the device will be damaged.



: No lifting position

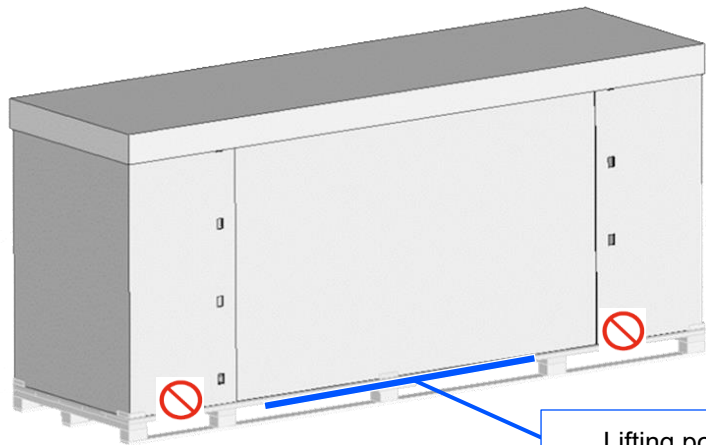

Lifting position

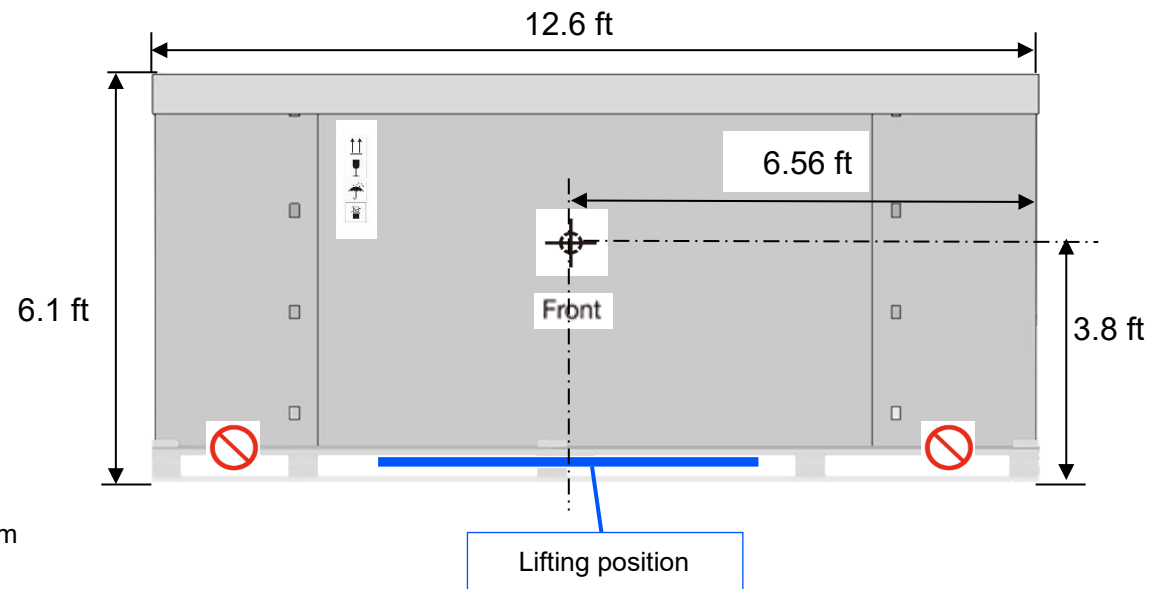

Lifting position

Insert forklift forks into the lifting position while maintaining the center of gravity from the long or short side of the pallet. Make sure the forks are inserted all the way in.

SC F10070 Positioning the Forklift - Main Unit

Location of correct lifting positions on the rear side and prohibited areas.

Use a forklift to remove it from the container.

	<p>Use a forklift that meets the following conditions.</p> <ul style="list-style-type: none">• Maximum load: 1.5t or more• Allowable load: Printer load is less than 1.5t• Forklift forks thickness should be within 7.3 in.
--	--

Lift with the center of gravity mark position as the center.

Insert the forklift forks all the way in.

	<p>Caution</p>	<p>Do not lift anywhere other than the lifting position. The load will be applied to an improper place and the device will be damaged.</p>
--	----------------	--

· Insert from long side

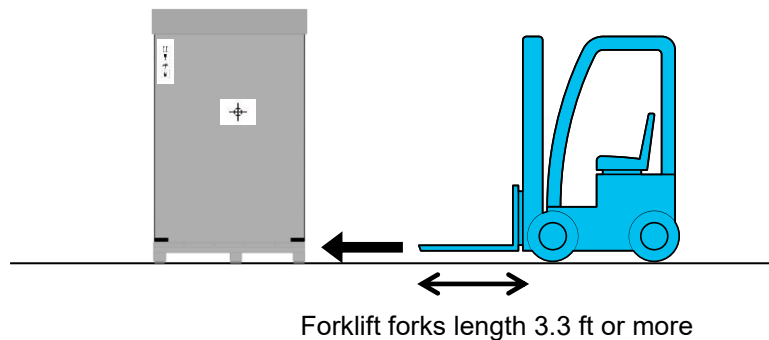

· Insert from short side

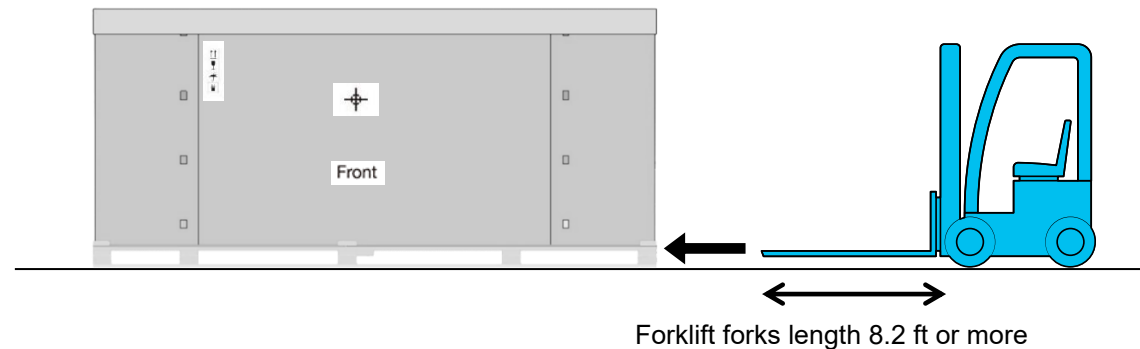

SC F10070 Lifting Position on Sides - Main Unit

Right side

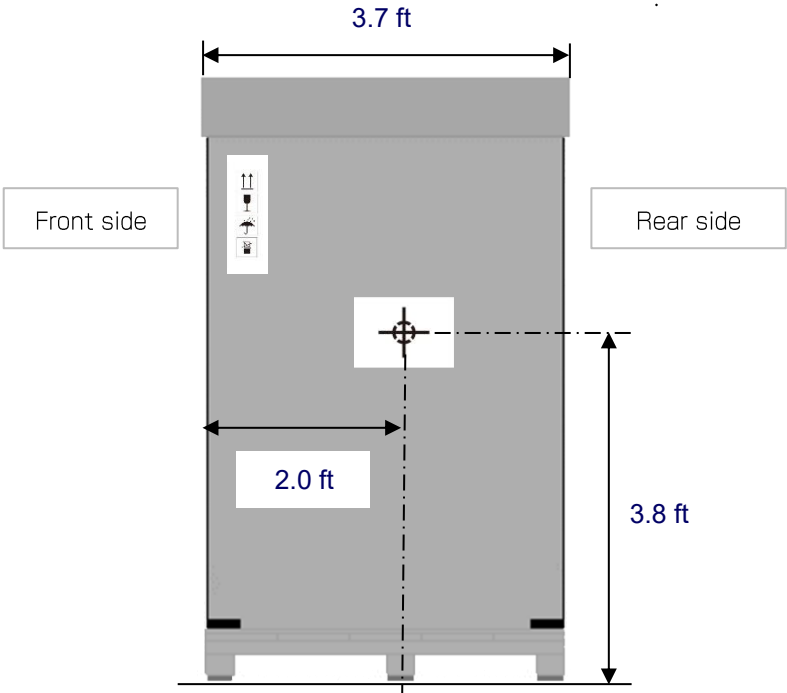

Left side

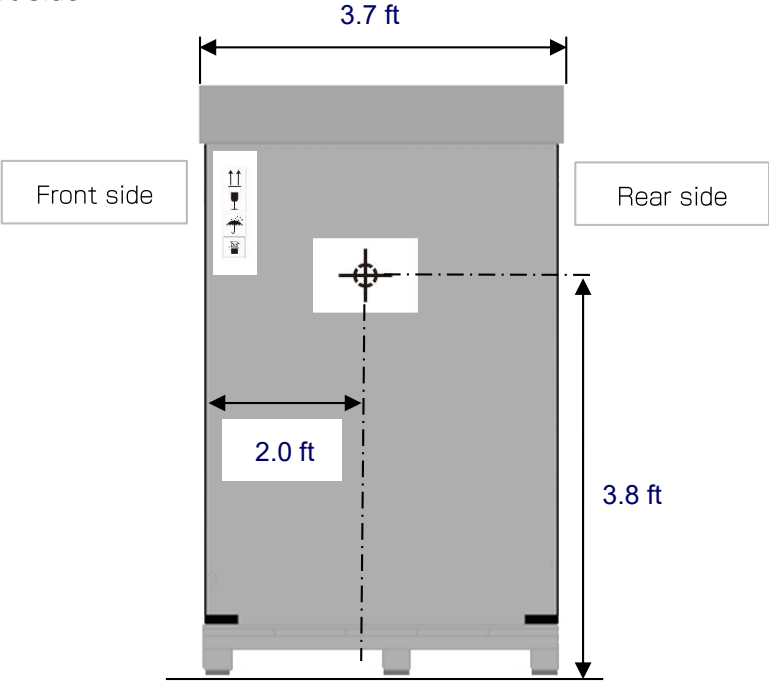

SC F10070 Lifting Position on Sides - Main Unit

Lifting position on sides



If you need to access the lift from the side, observe the following:

- Insert the forklift forks centered on the center of gravity.
- Set the fork interval as wide as possible.

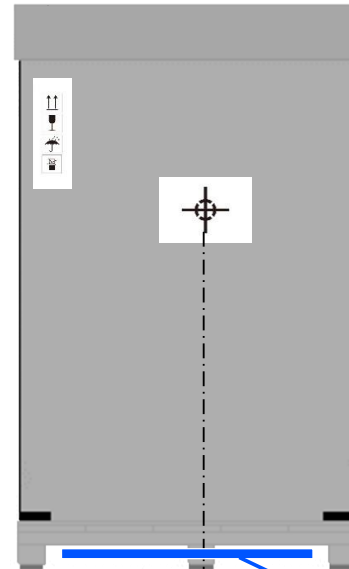
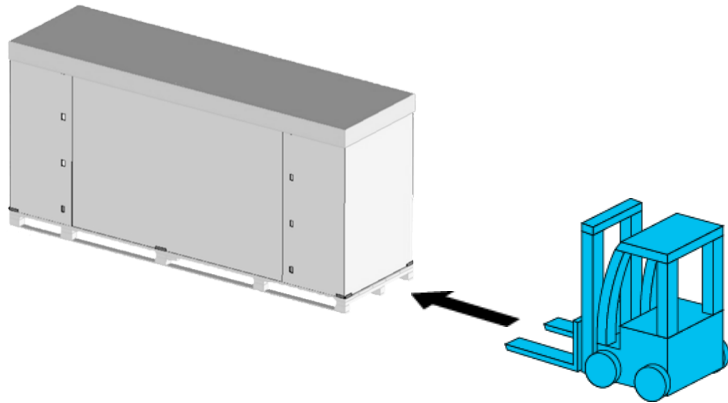

Insert the forklift forks centered on the center of gravity.
Insert the forklift forks all the way.

Lifting position

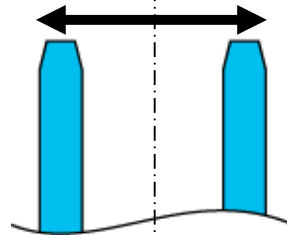

Keep the center of gravity center and set the fork interval as wide as possible.
Maximum 2.62 ft

SC F10070 Option Set Lifting Position

Handling of optional package

Lifting position and prohibited parts

 <p>Caution</p>	<p>Do not lift where prohibited. The load will be applied to an improper place and the device will be damaged.</p>
--	--

Insert the forklift forks keeping the center of gravity centered from the long side or the short side of the pallet, and place the lift position securely on the forks.

 : No lifting points

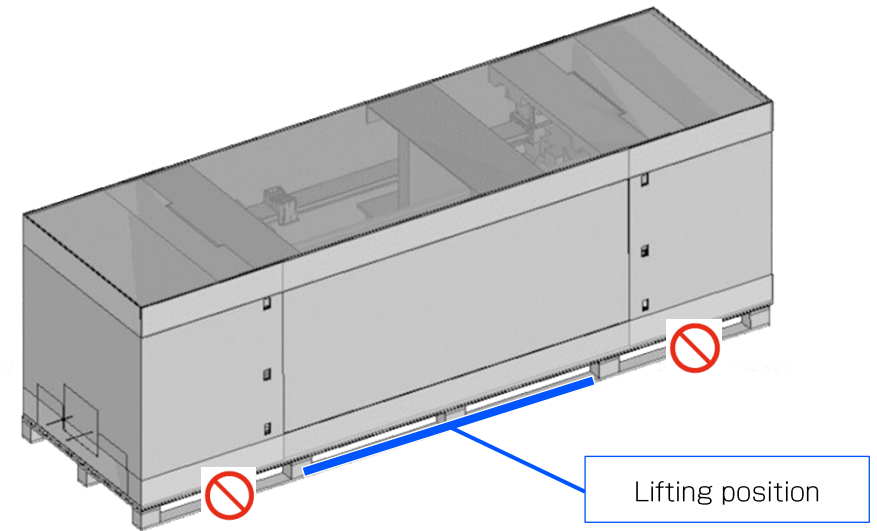
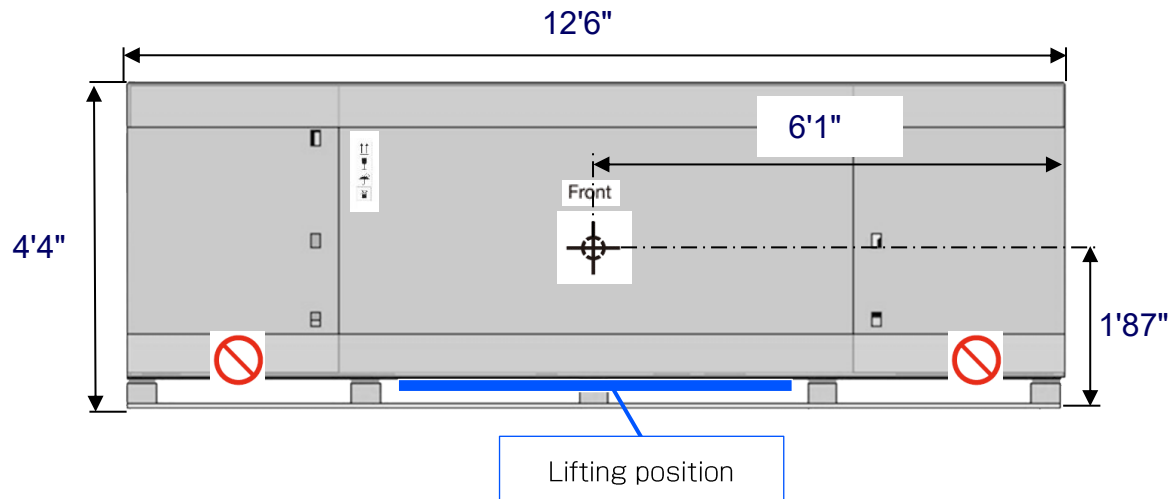

IMPORTANT

1. Move the box inside the building near the main unit setup location.
2. **Do not** unbox the Option Set at this time.

SC F10070 Option Set Lifting Position

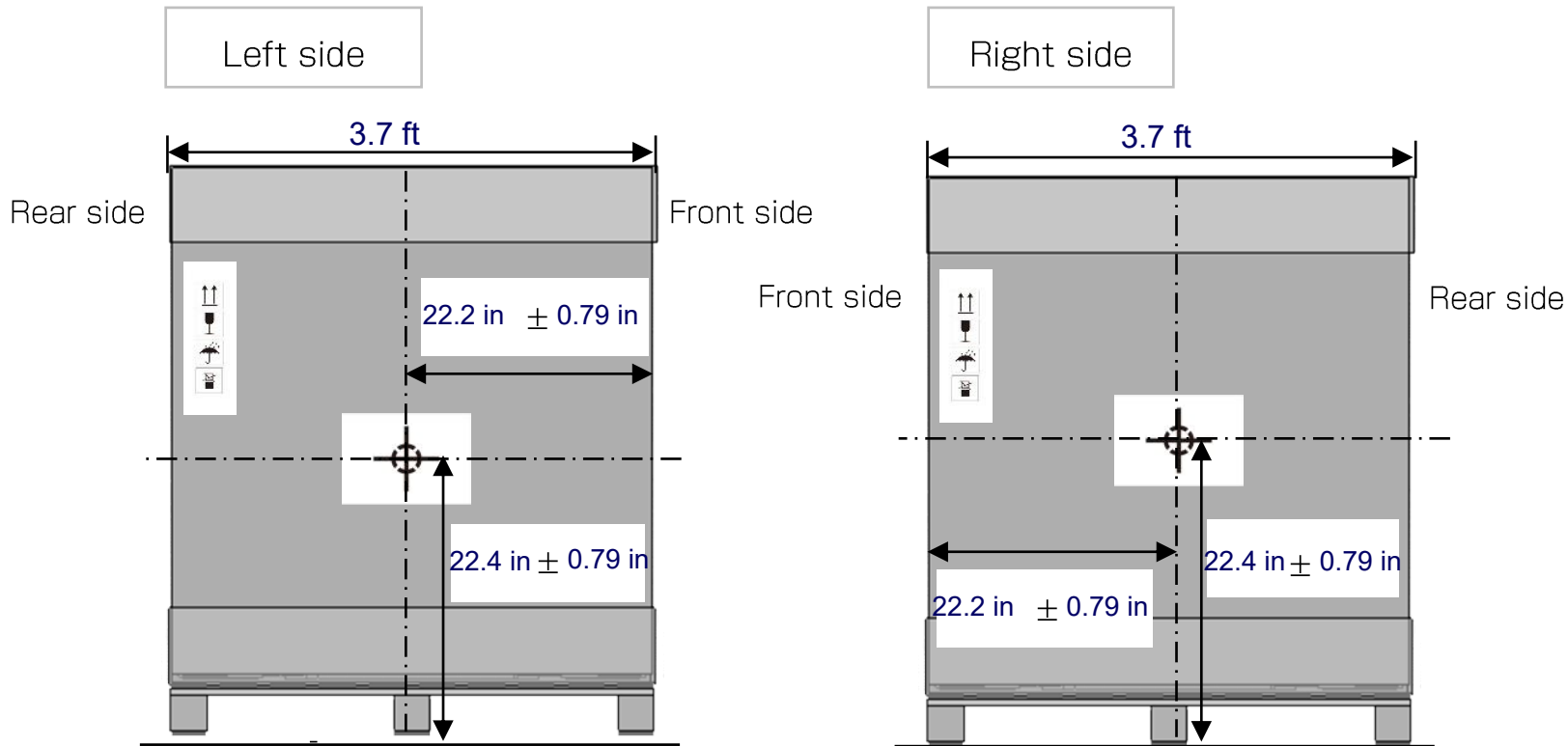

· Insert from short side

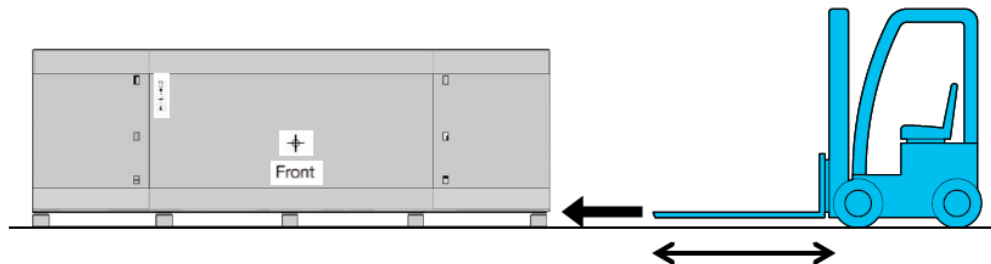

SC F10070 Option Set Cardboard Removal

Packing specifications

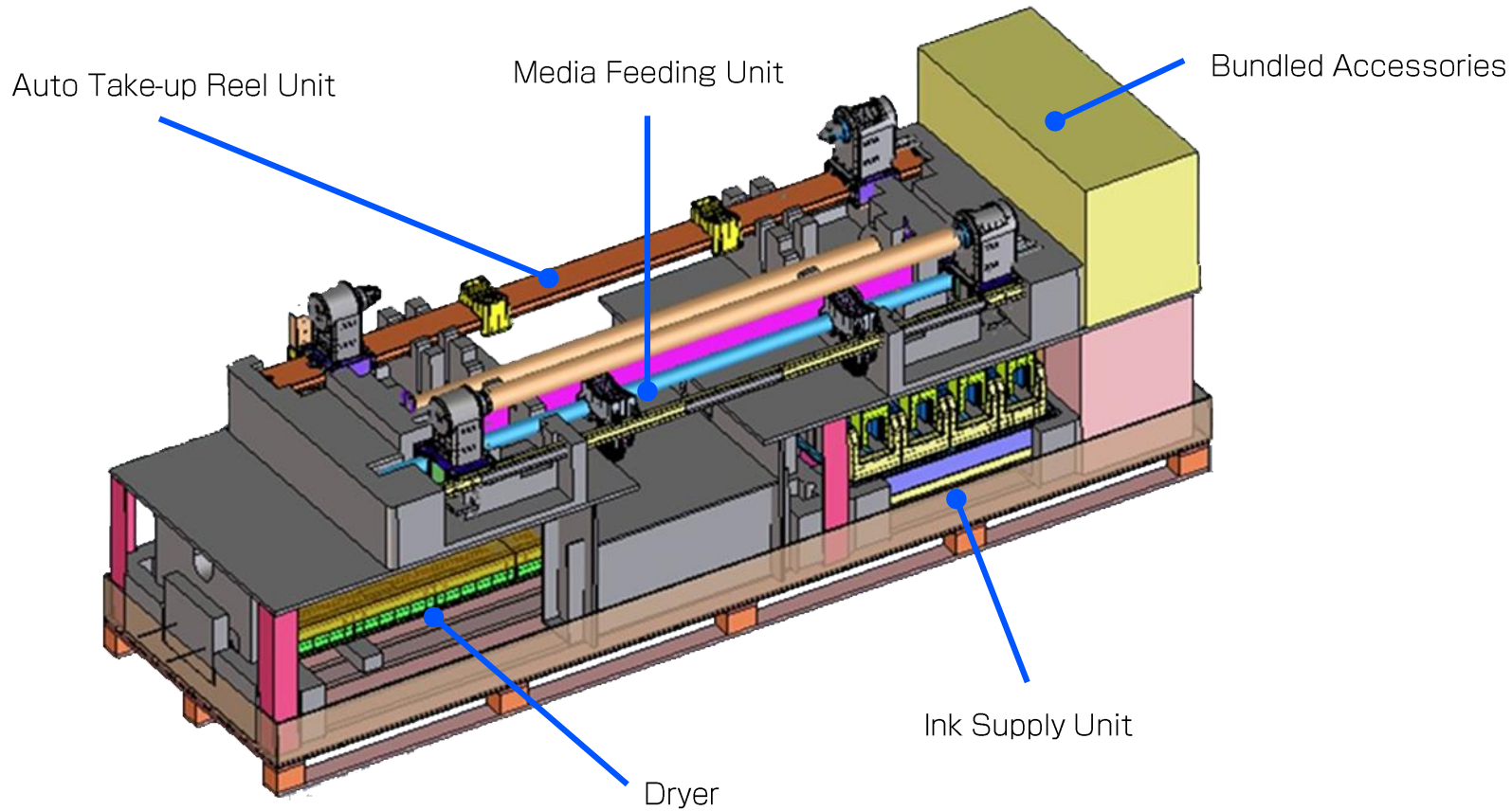

IMPORTANT

1. After moving the Option Set box to the printer setup location, remove the top and side cardboard pieces from the pallet.
2. Leave the option components on the pallet.
3. Do not open the Bundled Accessories box.

SC F10070 Accessories Included with Main Unit

Main Unit Accessories Box



2nd Accessories Box (not packed inside Main Unit box)



Includes power cords
and User's Guide Kit

IMPORTANT

Leave all accessories in their boxes and keep with the Main Unit.

SC F10070 Main Unit Unpacking

Open the Boxes

1. Unload the printer from the truck.

IMPORTANT: Carrier to take photos of all sides and top of the box while it is being offloaded from the truck. If you notice damage to the box or pallet, please take close-up photos. If photos are not provided, Carrier may be liable for damages. Please email photos to EpsonSiteSurvey@ea.epson.com with the subject line being the printer serial number. See page 16 for serial number location and additional instructions.



2. Remove the packing material.

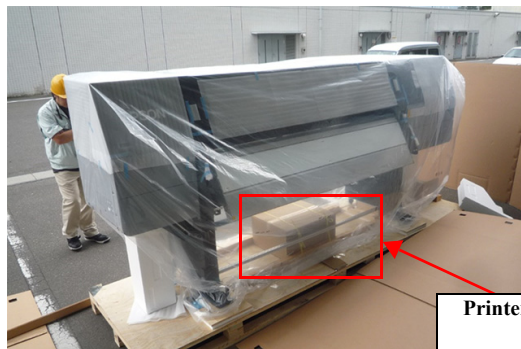
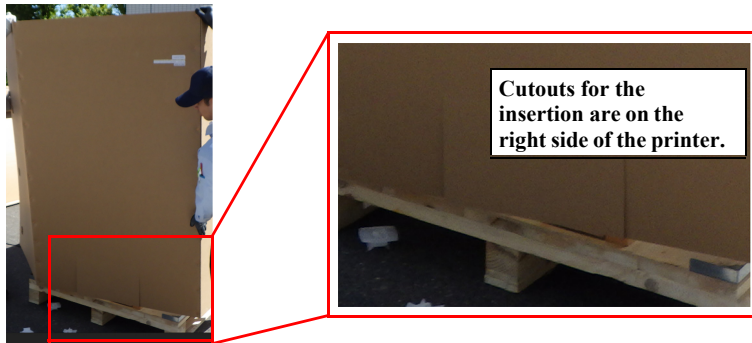
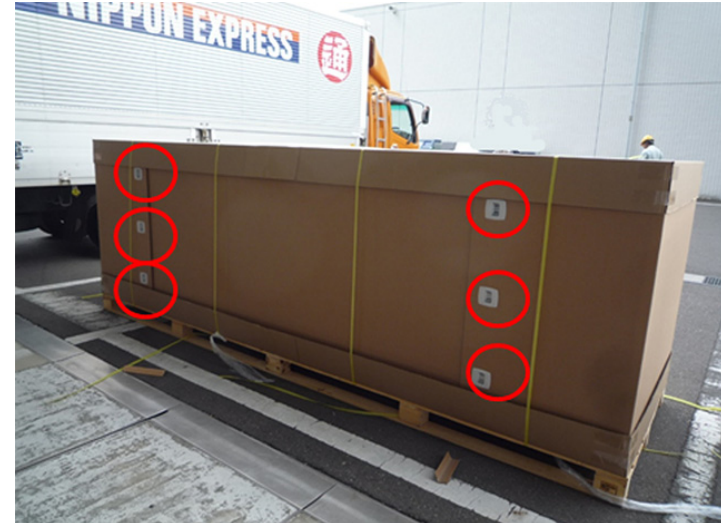

Figure 1-5.

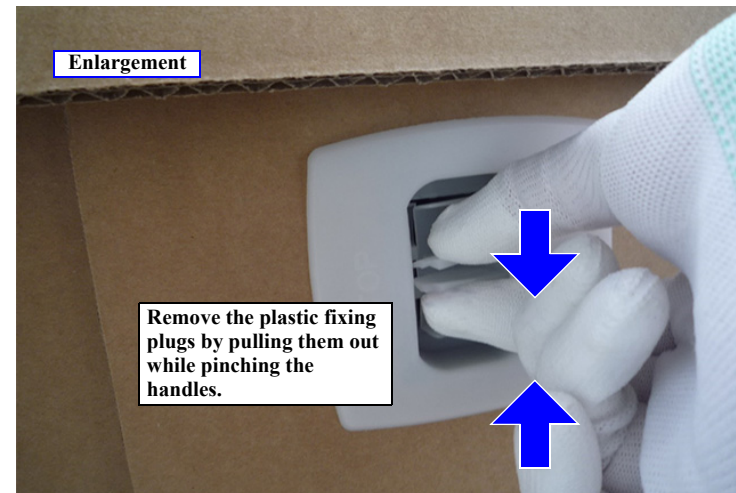

Figure 1-6.

SC F10070 Main Unit Unpacking

3. Remove the four corners fixing bolts (1 x 4 bolts) with a 19 mm wrench.
4. Remove the fixing brackets from the pallet with a 19 mm wrench. (1 x 4 double nuts.)

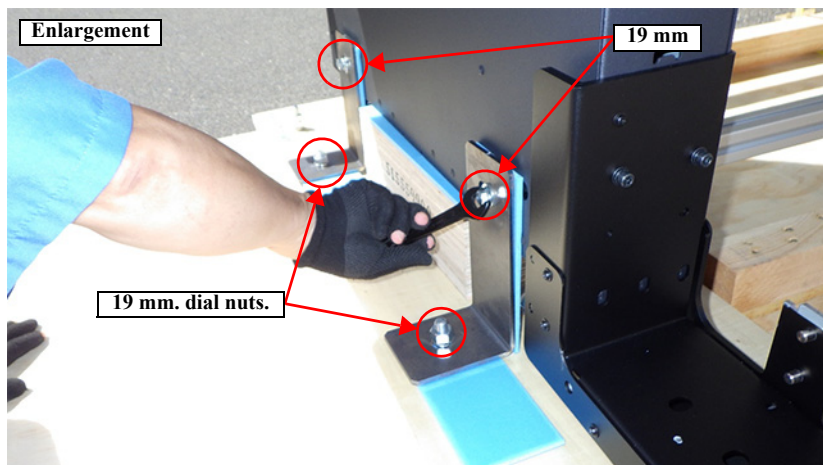
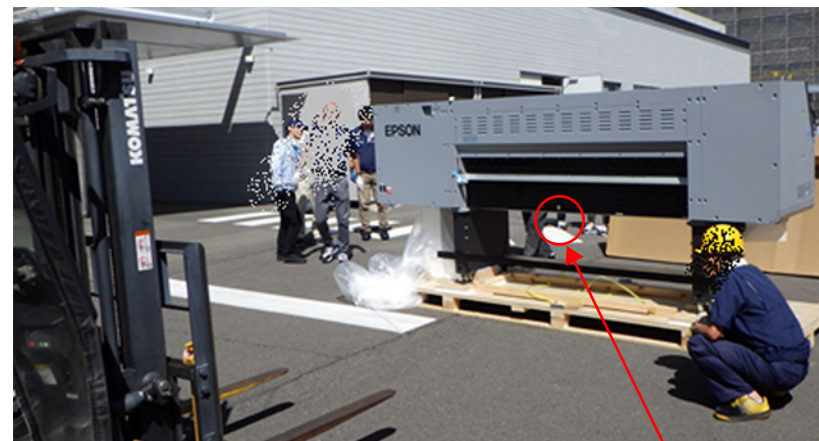

Figure 1-7.

5. Insert the forklift forks from the rear of the main unit.



Center of gravity mark.

Figure 1-8.

	<p>The forklift forks must not be inserted from the front of the main unit.</p>
--	---

SC F10070 Lifting Position on Main Unit

Main body

Lifting position and prohibited parts

	Caution Do not lift where prohibited. Load is applied to an inappropriate place, the device will be damaged.
---	---

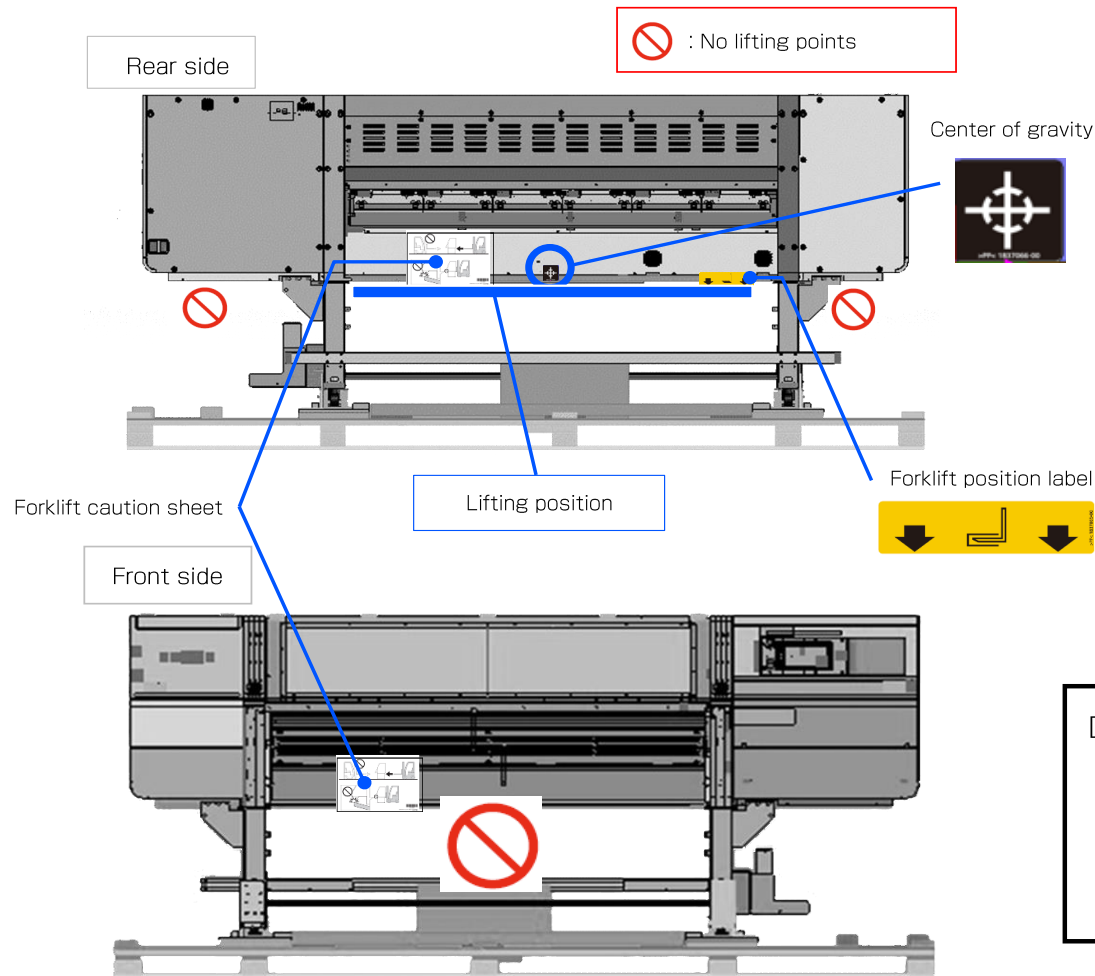

Do not insert the forklift from the front side
--

The diagram shows a forklift on the left with an arrow pointing towards the front side of the SC F10070 unit on the right. A red circle with a slash is placed over the forklift's path, indicating that this action is prohibited.

SC F10070 Lifting Position on Main Unit

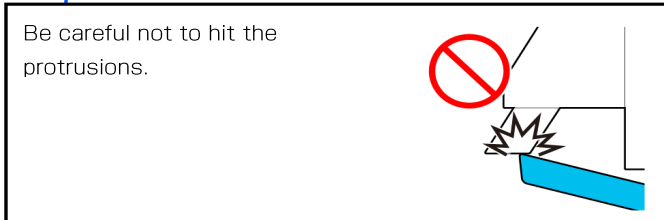
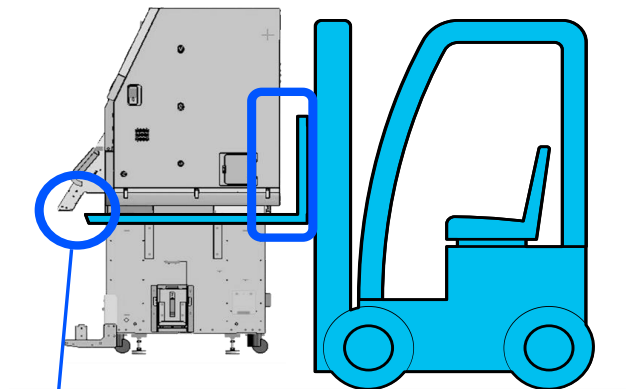
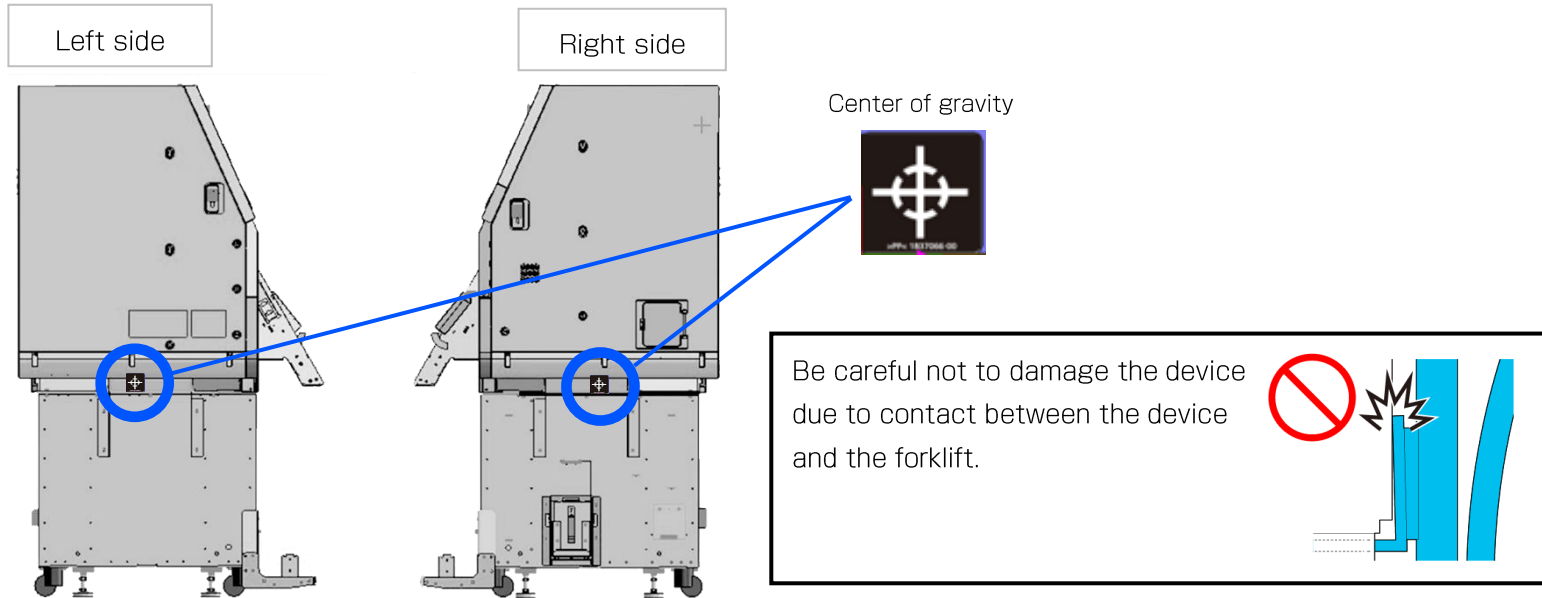

SC F10070 Main Unit Unpacking

IMPORTANT: Carrier must take photos of all four sides of the unit and pallet. If you notice damage to the unit or pallet, please take close-up photos before removing the unit from the pallet. If photos are not provided, Carrier may be liable for damages.

Please email photos to EpsonSiteSurvey@ea.epson.com with the subject line being the printer serial number. The serial number is located on the back right-side of the unit when viewed from the front.

7. Move indoors to the setup location. (This work must be performed by at least 4 persons because the main unit weighs approximately 1322 lb.)

6. Remove the printer from the pallet with the forklift.

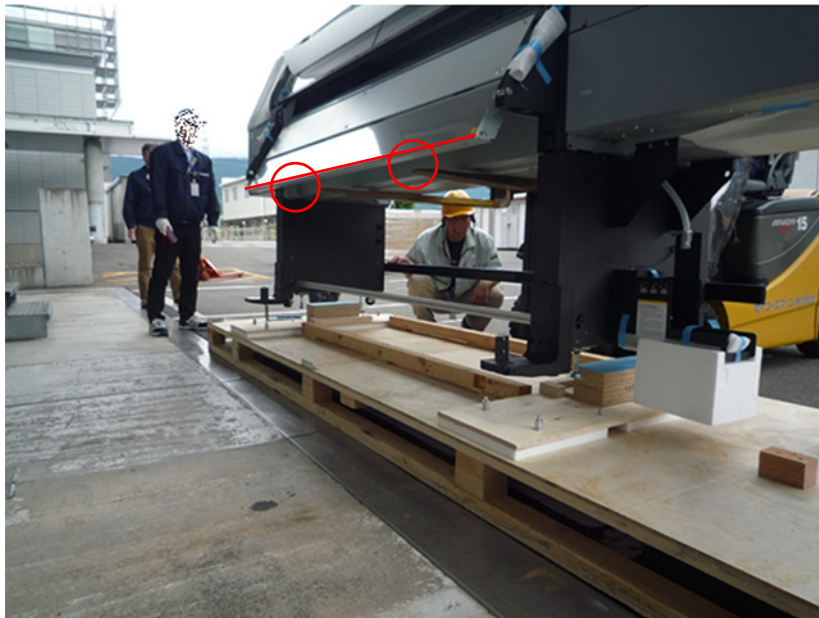

Figure 1-9.



Make sure the forklift forks do not touch the lower edge of the after heater.

07/20/2021 ver. 5