

# Epson® PowerLite® 9300i Notice

If dust accumulates in the lamp filter, it can cause overheating and reduce the life of the lamp. Epson recommends cleaning the lamp filter every three months; clean it more often if the projector is used in a dusty environment.

**Caution:** If the  temperature light comes on, the projector may be overheating. Clean the lamp filter as described below. Also be sure to check the air filters on the bottom of the projector; see your User's Guide for details.

## Cleaning the Lamp Filter

Follow these steps to clean the lamp filter:

1. Turn off the projector.
2. When the power light stops flashing, unplug the power cord.
3. Let the projector cool for at least half an hour (if it has been on). The lamp is extremely hot immediately after use.
4. If the projector is mounted on the ceiling, remove the rear cover.

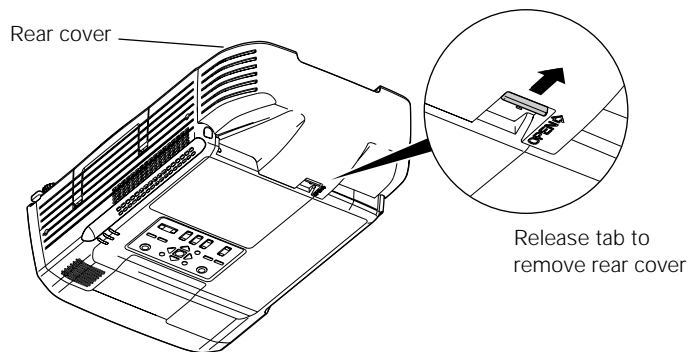

5. Loosen the lamp cover screws (you don't need to take them out all the way). Then remove the cover.

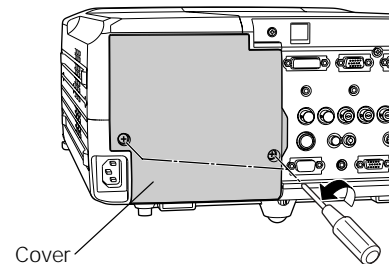

6. Loosen the three screws holding the lamp in place (you can't remove them).

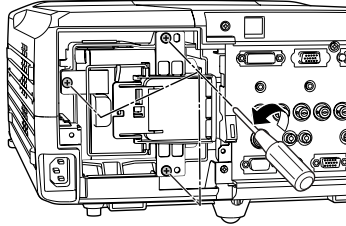

7. Grasp the wire handle and pull the lamp straight out.

**Caution:** Avoid touching the glass portion of the lamp. Oils transferred from your hands can cause the lamp to overheat and fail prematurely.

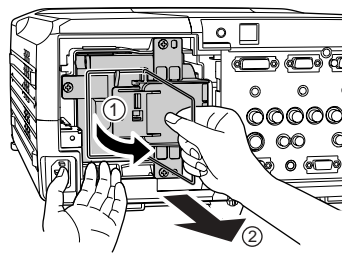

8. Hold the shutter open, and use a vacuum cleaner to remove any dust from the wire mesh filters inside.

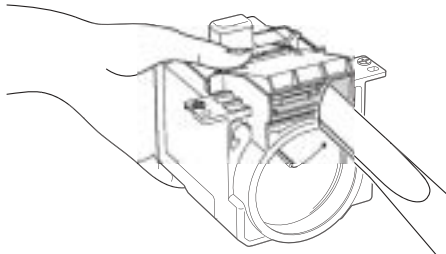

9. Insert the lamp back into the projector, tighten its screws, and replace the lamp cover.

Epson is a registered trademark of SEIKO EPSON CORPORATION.

PowerLite is a registered trademark of Epson America, Inc.

© 2003 Epson America, Inc. 12/03

Printed in XXXXXX

CPD-17590