



Installer Guide

Follow these instructions to set up the PowerLite® Pro Cinema 1080 projector and HQV® video processor.

For more information, see the manuals that came with these products.

Setting Up the Equipment and Displaying an Image

1. Unpack the HQV video processor and attach the serial number sticker included with it to the HQV *User Manual*.
2. Connect at least one video source to the video processor.
3. Connect an HDMI cable from the video processor to the projector.

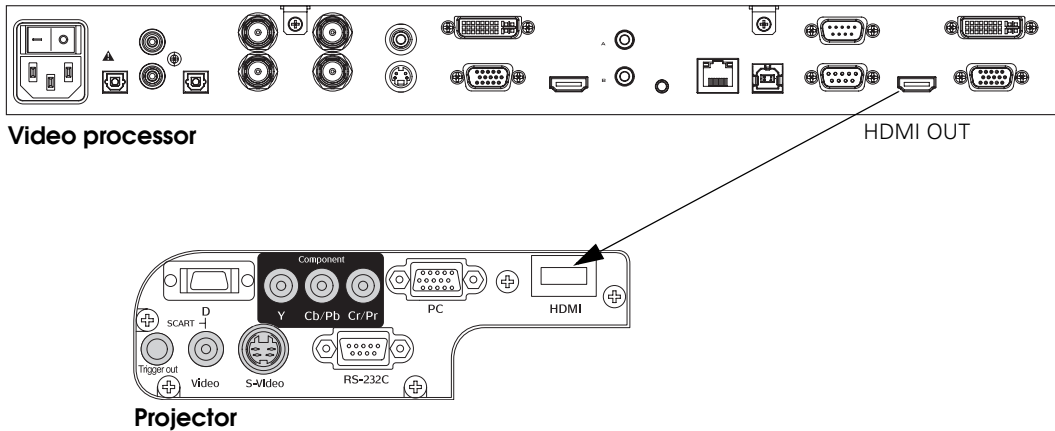

4. Plug in the power cord for the video processor. Make sure batteries are installed in the HQV remote control.
5. Set up the projector and turn it on as outlined below. For details, see the projector *User's Guide*.
 - Remove the protective lens pad from the projector, then remove the lens cap.
 - Make sure batteries are installed in the Epson remote control.
 - Plug in the power cord, then turn on the power switch on the back of the projector. Once the projector is receiving power, press the **On** button on the Epson remote control to turn it on.
6. Press the **Pattern** button on the Epson remote control, then adjust the image as outlined below.
 - Focus and zoom the image.
 - Position the image on the screen. If possible, keep the projector level and position the image using only the lens shift dials.

Caution: Do not try to move the lens by hand, or you may damage the projector. Always use the lens shift dials to change the lens position.

When done, press the **Pattern** button to clear the displayed pattern.

Note: If the projector is ceiling-mounted or set up for rear-screen projection, you'll use the projector's menu system to reorient the image (see step 1 on page 4). For best image quality, avoid tilting the projector or angling it toward the screen.

7. Press the **HDMI** button on the remote control to select HDMI as the input source.

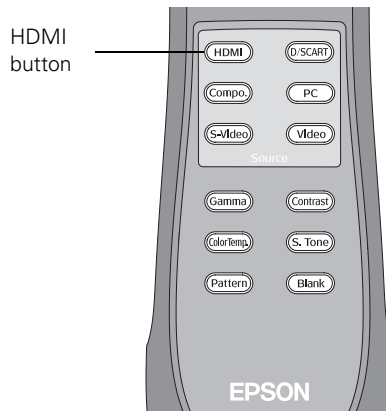

8. Turn on the power switch on the back of the HQV video processor (above the AC power inlet). It may take several seconds for the video processor to come on.
9. Press the **ON/SETUP** button on the HQV remote control to place the video processor in Setup mode. (You see **SetUp Mode** on the display.)

Note: If the HQV video processor doesn't respond to the remote control, check the remote control's batteries. If the batteries are good, turn off the HQV video processor and then turn it back on using the power switch above the AC power inlet.

Press the **MENU** button. Then use the **▲** and **▼** buttons to select the output resolution setting ("Output = xxx"). Use the **◀** and **▶** buttons to change the setting to **Output = 1080p 60Hz**.

Press the **ON/SETUP** button on the remote control to exit Setup mode.

10. Make sure the projector is displaying an image. If not, turn on a connected video source and select it by pressing the appropriate source button on the HQV remote control.

Selecting Projector Settings

1. If the projector is ceiling-mounted or set up for rear-screen projection, you need to reorient the image. Press the **Menu** button on the Epson remote control and open the **Settings** menu. Select **Projection** and then select the projector's mounting position.

Press the **Menu** button when done to exit the menu system.

2. Press the **Aspect** button and select **Normal** as the aspect ratio.
3. Press the **Color Mode** button and select **HD** as the color mode.

Note: This sets the brightness, contrast, and color settings to 0, Skin Tone to 3, Absolute Color Temperature to 7500K, lamp Brightness Control to High, and Auto Iris to Off.

4. Press the **Gamma** button and select **2.2** as the gamma setting.
5. Press the **Menu** button, open the **Image** menu, and select **Sharpness**.

If you see this screen, highlight **Standard** and press the **Select** button:

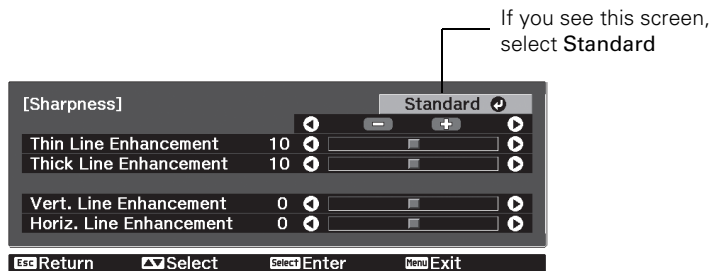

Change the **Sharpness** setting to **-3**.

6. Press the **ESC** button to return to the main menu. Open the **Signal** menu and then adjust the following settings:
 - Set **Output Scaling** to **100%**.
 - Set **EPSON Super White** to **Off**.
 - Set **HDMI Video Range** to **Normal**.
7. Press the **Menu** button when done to exit the menu system.

Selecting HQV Video Processor Settings

1. Press the **MENU** button on the HQV remote control.
2. In the  Picture menu, select **Aspect Ratio** and set it to **Full Screen**.

Note: If Full Screen is not a selectable option, select the Standard setting instead. If the video source is playing a high-definition video, you won't be able to adjust this setting. You can play a standard-definition DVD or switch to a different input, such as S-video, to adjust this setting for other sources.

3. In the  Advanced menu, select **HQV Film Mode** and set it to **Auto**.
4. Make any additional desired adjustments, following the instructions in the *HQV User Manual*. For example, you may want to select appropriate noise reduction settings.

Performing Color Calibrations

Use the HQV calibration software to perform final color calibrations. See the *ISF Certified Calibration Controls Dealer Guide* for details. Once the ISF calibrations are complete, you can use the projector's menu system, if necessary, to further fine-tune the color settings.

Installing the Calibration Software and USB Drivers

Note: These instructions explain how to connect to the HQV processor using a USB cable. To connect using a serial or network cable, see the *ISF Certified Calibration Controls Dealer Guide*.

1. Insert the HQV Video Processor TX3 CD in your Windows XP or 2000 computer. Locate the **setup.exe** file and double-click it to start the installation. Follow the on-screen instructions to install the calibration software.

Leave the CD in your CD/DVD drive when done.
2. Connect a USB cable from your computer to the **USB** port on the HQV video processor. You should see a Found New Hardware wizard on your computer screen. If not, make sure the video processor is turned on.

Follow the steps below to install drivers from the calibration software CD.
3. **Windows XP:** At the Found New Hardware screen, select **No, not this time** and click **Next**.
Windows 2000: Click **Next**.



4. **Windows XP:** At the next page, select **Install from a list or specific location** and click **Next**. Then select **Search for the best drivers in these locations**. Make sure the checkbox for **Search removable media** is selected.

Windows 2000: Select **Search for a suitable driver for my device**. Click **Next**, then select **CD-ROM drives**.

5. Click **Next** to install the driver, then click **Finish** when done.
6. You see the **Found New Hardware** screen again. Repeat steps 3 through 5 to install a second driver.
7. Remove the CD from your **CD/DVD** drive.

Using the Calibration Software

Use the calibration software to adjust the ISF Day and Night settings for each connected video source.

1. Launch the **Config Tool** located in the **Silicon Optix** program folder.
2. When the program opens, click the **Connect** button, select **USB** as the connection method, and click **OK**.
3. Select either  **Day** or  **Night**, depending on the ISF configuration you want to adjust.
4. Click the tab that corresponds to the video source you want to adjust.
5. For the **Input Parameters**, adjust the **Contrast**, **Brightness**, **Color**, **Hue**, and **Sharpness** as needed.
6. If you want to eliminate overscan, reduce all four **Overscan** settings to 0 (left, right, top, and bottom). If you want the image overscanned by about 2.5 to 3 percent, leave the settings as they are.
7. For the **Output Parameters**, you need to make sure the **Luma** is set correctly for all digital video sources to prevent clipping. Set the **Peak** to 235 and the **Base** to 16.

Note: RGB Peak and Base parameters should be adjusted, if necessary, only with photometric equipment. See the *HQV ISF Certified Calibration Controls Dealer Guide* for details.

8. When you're done making adjustments, click the **Disconnect** button to exit the software.

Using the Projector's Color Adjustments

If you notice that the peak of the red color channel is low after calibrating the component and HDMI inputs, or if you need to make any other color adjustments, you can fine-tune the color using the RGB and RGBCMY screens in the projector's menu system.

Note: These adjustments should be made only by a trained technician with a reference meter such as the Photo Research PR-650 SpectraColorimeter™ or Konica Minolta CS-200 Chroma Meter.

■ RGB

Press the **Menu** button on the Epson remote control and access this screen by selecting **Image > Advanced > RGB**.

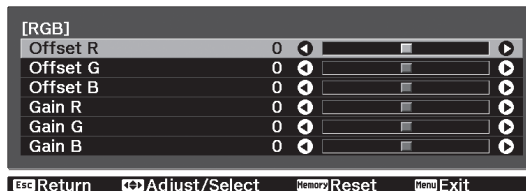

Adjust the offset and gain for each signal color. Use **Offset** to adjust the base and **Gain** to adjust the peak.

■ RGBCMY

Press the **Menu** button on the Epson remote control and access this screen by selecting **Image > Advanced > RGBCMY**.

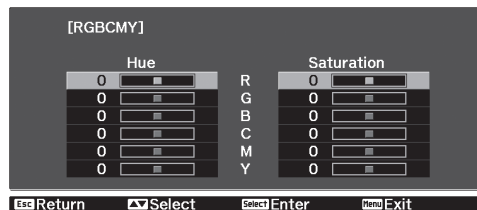

Adjust the hue and saturation for each color component (red, green, blue, cyan, magenta, yellow).

For your reference, the NTSC and HDTV color coordinate specifications are shown below.

NTSC (SMPTE)

	X	Y
Red	0.630	0.340
Green	0.310	0.595
Blue	0.155	0.070
Cyan	0.231	0.326
Magenta	0.314	0.161
Yellow	0.421	0.507

HDTV (ATSC)

	X	Y
Red	0.640	0.330
Green	0.300	0.600
Blue	0.150	0.060
Cyan	0.225	0.329
Magenta	0.321	0.154
Yellow	0.419	0.505

Using IR and ESC/VP21 Command Codes

If you want to program a universal remote control to work with the projector, you can obtain a list of projector IR control codes from the Epson web site at epson.com/support.

If you want the HQV video processor to be able to turn the projector on and off or control other functions, connect the supplied null-modem RS-232 cable as shown below. See the *HQV User Manual* and *Programming and Service Manual* for more information.

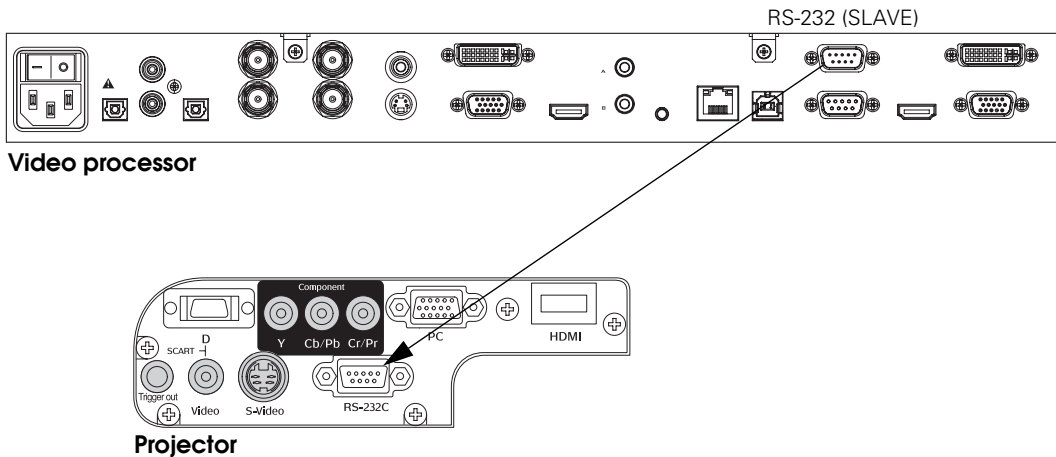

You can download the complete *ESC/VP21 Communication Manual* for Epson home theater projectors from the Epson web site at epson.com/support. Following are some of the available codes:

Item		Command	
Power ON/OFF	ON	PWR ON	
	OFF	PWR OFF	
A/V Mute ON/OFF	ON	MUTE ON	
	OFF	MUTE OFF	
A/V Mute selection	Black	MSEL 00	
	Blue	MSEL 01	
Source change	Terminal	Signal name	
	Component	Component video	SOURCE 10
		YCbCr	SOURCE 14
		YPbPr	SOURCE 15
		Auto	SOURCE 1F
	PC	HDB15	SOURCE 20
		RGB	SOURCE 21
	Input 3 (HDMI)	HDMI	SOURCE 30
	Video	Video/S-Video	SOURCE 40
		Video (RCA)	SOURCE 41
		S-Video	SOURCE 42
	Input 5	Digital video	SOURCE C0
		YCbCr	SOURCE C4
		YPbPr	SOURCE C5
	Auto	SOURCE CF	
Color Mode	Cinema Night	CMODE 05	
	Cinema Day	CMODE 06	
	Natural	CMODE 07	
	Vivid	CMODE 08	
	HD	CMODE 09	
	Silver Screen	CMODE 0A	

Item	Command	
Aspect ratio	Auto	ASPECT 00
	Normal	ASPECT 20
	Full	ASPECT 21
	Zoom	ASPECT 22
	Wide	ASPECT 25

Copyright Notice

All rights reserved. No part of this document may be reproduced, stored in a retrieval system, or transmitted in any form or by any means, electronic, mechanical, photocopying, recording, or otherwise, without the prior written permission of Epson America, Inc. This publication and the features described herein are subject to change without notice.

Trademarks

Epson is a registered trademark and Exceed Your Vision is a trademark of Seiko Epson Corporation. PowerLite is a registered trademark of Epson America, Inc.

General Notice: Other product names used herein are for identification purposes only and may be trademarks of their respective owners. Epson disclaims any and all rights in those marks.