

# Mobilink P60II Receipt Version Product Information Guide

What's in the Box .....	1
Accessories.....	1
Printer Specifications .....	1
Media .....	2
Reliability.....	2
Safety.....	2
Dimensions .....	2
Control Panel.....	2
Loading Paper .....	3
Removing the 58-mm Spacer .....	3
Installing the 58-mm Spacer .....	3
Performing a Self-Test .....	3
Removing a Paper Jam.....	3

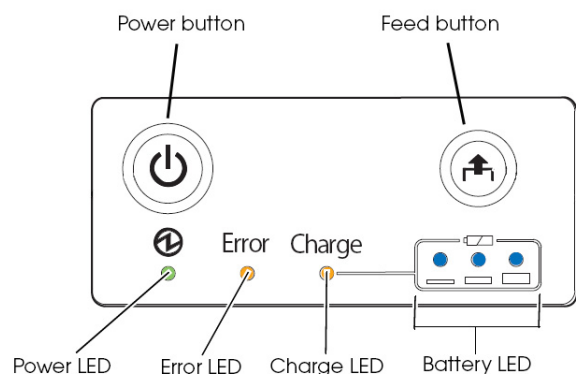

## Accessories

Option	Model	Part number
AC/DC power supply	PS-11	C32C825375
Battery	OT-BY60II	C32C831091
Multi-battery charger	CH60II	C32C825374
Shoulder strap, black	TM-P60II	C32C890181
Soft case, black	TM-P60II	508339

## Printer Specifications

### Printing

Print methods: thermal line printing

### Receipt Section

Dot density: 203 dpi × 203 dpi  
(dpi = dots per inch [25.4 mm])

Print width: 2.07" (52.5 mm), 420 dots (2.28" paper)  
2.13" (2.13 mm), 432 dots (2.36" paper)

Characters per line: font A: 35, B: 42, C: 52 (2.28" paper)  
font A: 36, B: 43, C: 54 (2.36" paper)

Print direction: unidirectional with friction feed

Print speed: 3.94"/sec. (100 mm/sec.) maximum

Paper feed speed: approx. 3.94"/sec. [100 mm/sec.]  
(continuous paper feed)

Character sets: alphanumeric: 95 characters;  
international: 18 sets  
extended graphics: 128 × 43 pages  
(including a user-defined page)

## What's in the Box

- Mobilink P60II printer
- User's manual
- Small thermal paper roll (for operational testing)
- Battery, model OT-BY60II (with user's manual)
- USB cable saddle
- Belt clip (attached to printer)
- 58mm spacer (attached to printer)

## Interfaces

Built-in: USB 2.0 Full-speed

Wireless: Bluetooth® or IEEE 802.11b/g/n (2.4 Ghz), a/n (5 Ghz), depending on model.

## Media

Paper type: thermal roll paper  
 Paper size: 58 mm (2.28") or 60 mm (2.36") wide  
 Max. Diameter: 2" roll  
 Specified paper:

Paper Type Number	Manufacturer
TF50KS-E	NIPPON Paper Industries Co., Ltd.
P30023	Kanzaki Specialty Papers (USA)
P31023	
P35023	
150PSM	Ricoh Company, Ltd.

## Reliability

Print head life: 100 million pulses, 100 km  
 Autocutter: 500,000 cuts  
 MTBF: 120,000 hours  
 MCBF: 16 million lines

## Safety

Electromagnetic Interference:

FCC/ICES-003 Class A

Safety Standards:

*CE Markings:* UL60950-1  
 CSA C22.2 No.60950-1  
 EN300328  
 EN301489-1  
 EN301489-17  
 EN60950-1  
 EN62311

## Dimensions

### Dimensions

(H × W × D): 4.0 x 6.3 x 2.6 inches  
 (103 x 159 x 65 mm)

**Weight:** approx. 1.39 lb (630 g)  
 (including battery and belt clip, excluding roll paper)

## Control Panel

### LEDs

Ⓢ (*Power*)

On when power is on.

Off when power is off.

**Flashing** when printer is powering off (160ms); when standing by in software set up mode (320ms); and when a wireless LAN printer is activated (300ms/800ms).

*Error*

On when the printer is offline (paper out, power-on initialization, paper cover open, battery charge at "S" level).

**Flashing** if there is an error. Possible causes include:

- thermal head temperature too high
- roll paper cover opened during printing
- autocutter malfunction
- memory R/W check abnormality
- Extremely high or low power supply voltage
- CPU executed an incorrect address
- internal circuit connection abnormality

Turn the printer off for a few seconds, then turn the printer back on. If the LED is still blinking, contact a dealer or qualified service person.

*Charge*

On when the battery is being charged.

Off when the battery is fully charged.

**Flashing** when the battery is charging abnormally.

*Battery*

Printer Condition	Battery LED	Error LED	Battery charge status
Power on	3 LEDs On	Off	Level H
	2 LEDs On	Off	Level M
Power on and buzzer sounds.	1 LED On	Off	Level L*
	1 LED flashing	On	Level S**
	3 LEDs Off	On	Level E***
*You can continue printing, but replacing or charging the battery is recommended.			
**Replace or charge the battery. Printing may stop in the middle.			
***Replace or charge the battery. The printer is unable to print.			

### Buttons

*Power*

Press this button to turn the power on or off. To turn the power off, hold the button for more than two seconds.

*Feed*

Press this button to advance the paper one line. Hold the button down to advance the paper.

## Loading Paper

**Caution:** To avoid injury, do not touch any part of the printer other than the roll paper when the cover is open.

**Note:** Do not open the paper roll cover when the printer is printing or feeding paper. Only use paper that meets specifications, and do not use rolls that have the paper glued onto the core.

1. Open the roll paper cover by pressing down on the roll paper cover open button.
2. Remove the used roll paper core, if there is one, and insert the roll paper in the direction shown below.

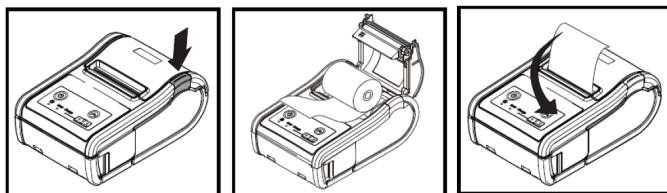

3. If the receipt printer is attached to a belt using the belt clip, insert the roll paper as shown below.
4. Pull out some paper, and close the roll paper cover.
5. Tear off the extra paper using the manual cutter.

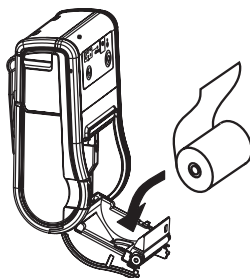

## Removing the 58-mm Spacer

While using a flathead screwdriver to push part A in the direction indicated by the arrow, pull up at part B to remove the spacer.

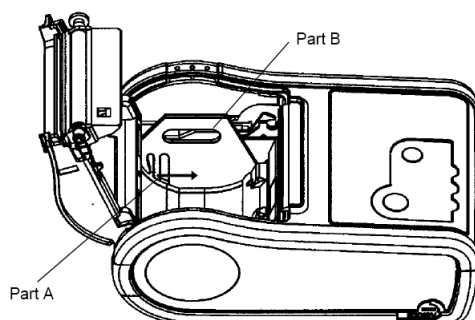

## Installing the 58-mm Spacer

Insert the spacer part C into the printer part D, and then insert spacer part E into printer part F to install the spacer.

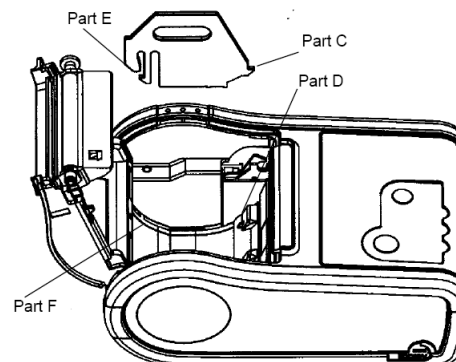

## Performing a Self-Test

Follow the steps below to perform a self-test on roll paper:

1. Make sure the printer is off and the roll cover is closed.
2. Press and hold the **Feed** button and turn on the printer. The printer prints its status and the **Paper** LED begins flashing.
3. To continue the self-test, press the **Feed** button.

The self test is complete when **\*\*\* completed \*\*\*** is printed.

## Removing a Paper Jam

**Caution:** Do not touch the thermal head, because it can be very hot after printing. Let it cool before you remove the jammed paper.

1. Turn off the printer.
2. Open the roll paper cover by lifting the two tabs on the roll paper cover and pushing the cover back.
3. Remove the jammed paper.
4. Close the roll paper cover.