

TM-T70II Product Information Guide

What's in the Box	2
Accessories	2
Printer Specifications	2
Printing	2
Interfaces	2
Media	2
Reliability	2
Safety	3
Dimensions	3
Memory Switches/Receipt Enhancement Functions	3
Memory Switches	3
Receipt Enhancement Functions	3
Control Panel	3
Loading Paper	3
Testing the Printer	4
Removing a Paper Jam	4
Cleaning the Thermal Head	4

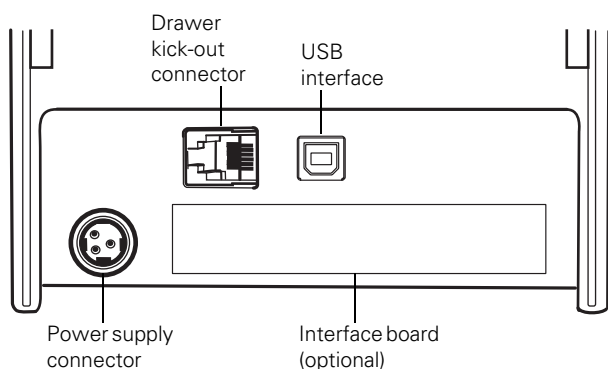
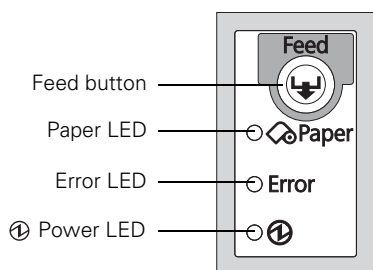
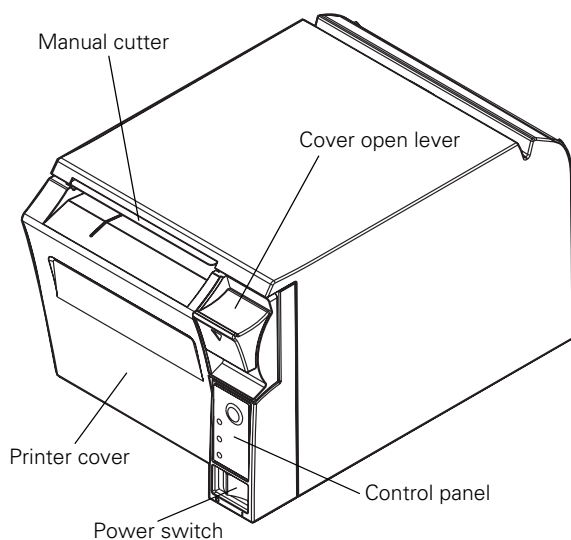

What's in the Box

- ☐ Printer
- ☐ Setup Guide
- ☐ Small thermal paper roll (for operational testing)
- ☐ Power supply and AC cable
- ☐ CD (includes drivers, utilities, and manuals)
- ☐ Power switch cover
- ☐ Locking wire saddle (for routing USB cable)

Accessories

Option	Model	Part number
AC adapter (with AC cable)	PS-180	C825343
AC adapter (without AC cable)	PS-180	C825341
AC cable	AC CABLE	205498100
Interface boards	UB series	see price sheet
Cable connector cover	OT-CC70II	C32C814606

Printer Specifications

Printing

- Print method: thermal line printing
- Dot density: 180 dpi × 180 dpi
(dpi = dots per inch [25.4 mm])
- Print width: 2.83" (72.2 mm), 512 dots
- Characters per line: font A: 42, font B: 56
- Print direction: unidirectional with friction feed
- Print speed: 9.84"/sec. (250 mm/sec.) maximum
- Paper feed speed: approx. 7.87"/sec. [200 mm/sec.]
(continuous paper feed)
- Character sets: alphanumeric: 95 characters;
international: 18 sets;
extended graphics: 128 × 43 pages
(including user-defined page)

Interfaces

- Built-in: USB 2.0 Full-speed
- Optional: serial, parallel, Powered USB, Ethernet, and wireless

Media

- Paper type: thermal roll paper
- Paper size: 80 mm wide

Reliability

- Print head life: 120 million pulses, 120 km
- Mechanism: 17 million lines
- Autocutter: 1.7 million cuts
- MTBF: 360,000 hours
- MCBF: 65 million lines

Safety

EMI:	FCC Class A CAN ICES-3(A)/NMB-3(A)
Safety Standards:	UL60950-1 CSA C22.2 No 60950-1

Dimensions

Dimensions (H × W × D):	4.49" × 4.92" × 7.64" (114 mm × 125 mm × 194 mm)
Weight:	approx. 3.75 lb (1.7 kg)

Memory Switches/ Receipt Enhancement Functions

Use the TM-T70II Utility, Memory Switch Setting Mode, or ESC/POS commands to set the memory switches and receipt enhancement functions listed below. See your TM-T70II documentation for more information.

Memory Switches

- ☐ Receive buffer capacity
- ☐ BUSY condition
- ☐ Processing when data receive error
- ☐ Auto line feed
- ☐ USB power-saving function
- ☐ Release condition of receive buffer BUSY
- ☐ Paper sensor to output paper-end signals default
- ☐ Error signal output
- ☐ Print density
- ☐ Multi-tone print density
- ☐ Print speed
- ☐ Number of head energizing parts
- ☐ Character code table default
- ☐ International character default
- ☐ Interface selection
- ☐ Autocutting after closing cover
- ☐ Paper reduction
- ☐ Font A auto replacement
- ☐ Font B auto replacement
- ☐ Buzzer

- ☐ TM-T88V command-compatible mode
- ☐ Communication condition of serial interface
- ☐ Communication condition of USB interface

Receipt Enhancement Functions

- ☐ Auto top logo
- ☐ Auto bottom logo
- ☐ Auto top/bottom logo extended functions

Control Panel

① (Power) LED

On when the power is on.

Note: Turn off the printer before opening the printer cover.

Error LED

Steadily on when the printer is offline. Blinking if there is an error. See if the printer cover is open. Turn the printer off for a few seconds, then turn the printer back on. If the LED is still blinking, contact a dealer or qualified service person.

Paper LED

Comes on when roll paper is low or out. Flashes when the printer is performing a self-test.

Feed Button

Pressing this button once feeds paper by one line. Holding this button down feeds paper continuously.

Loading Paper

Warning: To avoid injury, do not touch any part of the printer other than the roll paper when the printer cover is open.

Caution: Do not open the printer cover when the printer is printing or feeding paper; you may damage the printer. Only use paper that meets specifications, and do not use rolls that have the paper glued onto the core.

1. Turn off the printer.
2. Press the cover open lever to open the printer cover.

3. Remove the used roll paper core, if there is one, and insert the roll paper in the direction shown below.

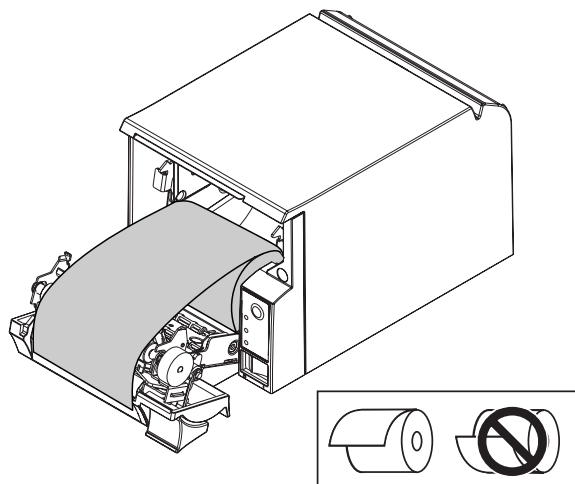

4. Pull out some paper, and make sure it sits between the paper guides.

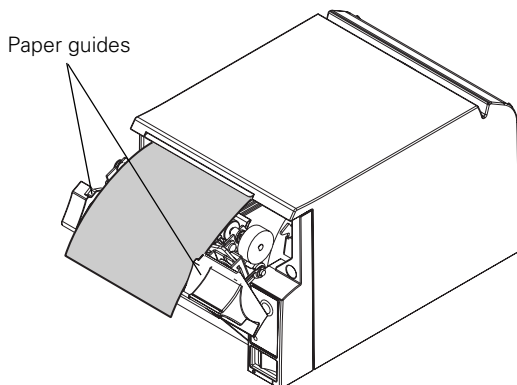

5. Close the printer cover.
6. Tear off the extra paper using the manual cutter.

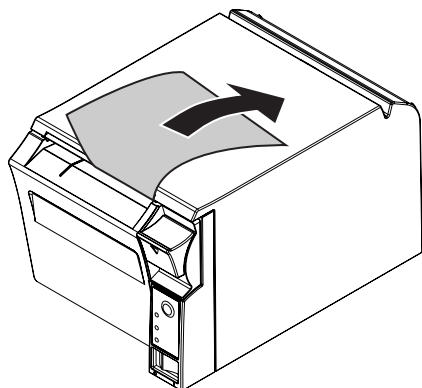

Testing the Printer

Follow these steps to perform a self-test:

1. Make sure the printer is off and the printer cover is closed.

2. Press and hold the **Feed** button and turn on the printer. The printer prints its status and the **Paper** LED begins flashing.
3. To continue the self-test, press the **Feed** button for less than 1 second.

The self-test is complete when ***** completed ***** is printed.

Removing a Paper Jam

Warning: The thermal head can be very hot after printing. Let it cool before you remove the jammed paper. To avoid injury, do not touch any part of the printer other than the roll paper when the printer cover is open.

1. Turn off the printer.
2. Press the cover open lever to open the printer cover.
3. Remove the jammed paper, then reinstall the roll paper.
4. Close the printer cover.

Cleaning the Thermal Head

Epson recommends cleaning the thermal head periodically (about every 3 months) to maintain print quality.

Warning: The thermal head can be very hot after printing. Let it cool before you clean it. To avoid injury, do not touch any part of the printer other than the roll paper when the printer cover is open.

Caution: Do not touch the thermal head with your fingers or any hard object; you may damage the printer.

1. Turn off the printer.
2. Press the cover open lever to open the printer cover.
3. Clean the thermal head with a cotton swab moistened with an alcohol solvent (ethanol or isopropyl alcohol).

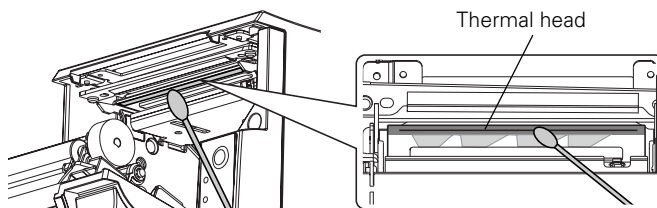

EPSON is a registered trademark and EPSON Exceed Your Vision is a registered logomark of Seiko Epson Corporation.

General Notice: Other product names used herein are for identification purposes only and may be trademarks of their respective owners. Epson disclaims any and all rights in those marks.

This information is subject to change without notice.

© 2013 Epson America, Inc., 7/13

CPD-39900