

KDS Menu Routing

About this guide

This guide consists of 2 sections:

- **Overview-** A detailed description of what KDS Menu Routing is and its functionality in a TrueOrder™ Kitchen Display System (KDS).
- **How to Configure KDS Menu Routing –** A procedure that can be followed to configure this in a Multi-Station KDS system.

Overview

In KDS Menu routing all print jobs are sent directly from the POS to a single KDS device (Master Device). The menu configuration and routing determine which displays the orders are sent to. In Figure 1 the Master Display gets the full order, then shows only grill items while routing the French Fries to the Fry station.

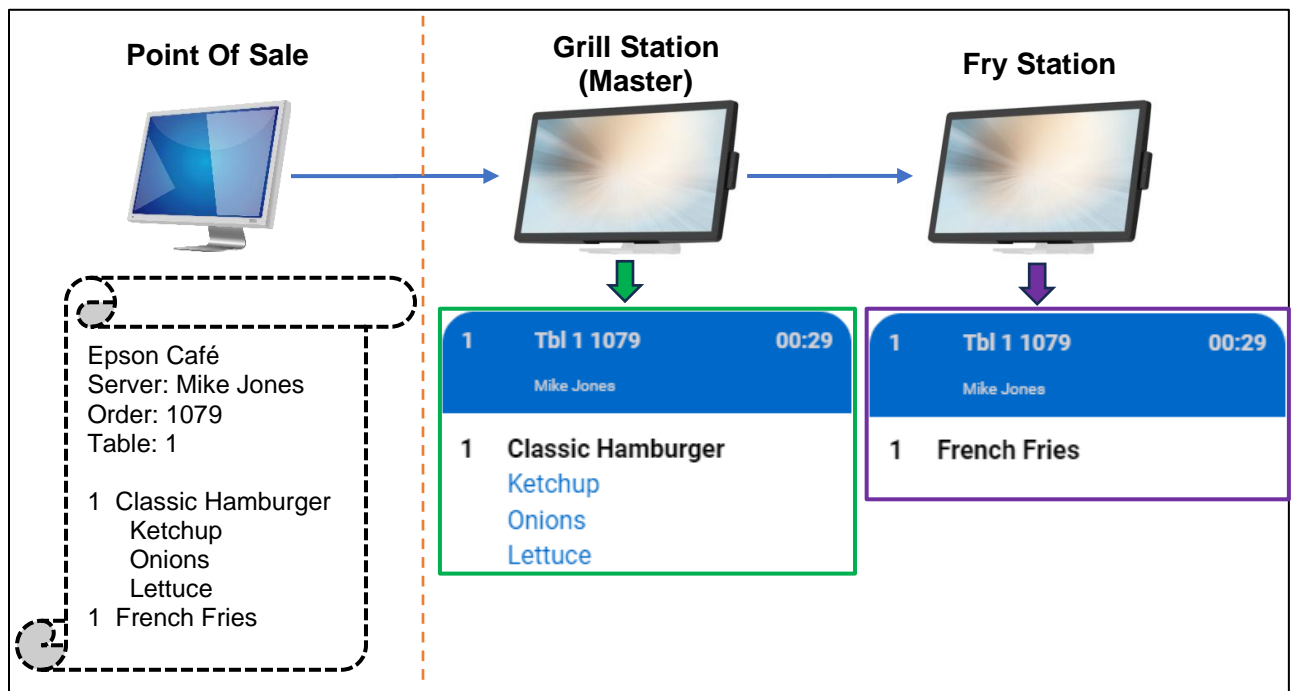

Figure 1: KDS Menu Routing

How to Configure KDS Menu Routing

This guide assumes that you already have a 2 Station KDS system setup as described in the TrueOrder KDS Multi-Station Quick Start Guide.

1. Configure Site Wide Settings

1. Select **Application Settings**.
2. Select **POS Connected Device**.
3. Select **KDS Menu Routing** from the drop-down menu.
4. Click **Save**.

The screenshot shows the 'KDS Configuration Utility' interface. The top navigation bar includes 'STATIONS', 'LAYOUT', 'MENU & RECEIPT', 'APPLICATION SETTINGS' (circled with a red line and labeled '1'), and 'POS EQUIP'. The left sidebar has 'SITE WIDE' (selected), 'WIZARD', and 'DISPLAY LOGOS'. The main content area is titled 'Application Settings' and 'Site wide'. Under the 'CONFIGURATION' section, the 'Name' is 'Test Site1', 'POS Type' is 'EpsonKDS Version 3.2', and 'POS Connected Device' is 'Kitchen' (circled with a red line and labeled '2'). The 'Menu Routing' dropdown is set to 'KDS Menu Routing' (circled with a red line and labeled '3'). The 'Daily Maintenance Time' is '07:00 AM' and 'Consider Orders Unique' is unchecked. Under 'TIME SETTINGS', 'Time Zone' is 'America/New_York' and 'NTP Time Server' is 'time.google.com'. There are buttons for 'SET CURRENT KDS TIME' and 'SET CURRENT TIME, ZONE AND TIME'. At the bottom, there are text input fields for 'Ticket Header Text', 'Ticket Footer Text', 'Item Header Text', and 'Item Footer Text'. A 'SAVE' button is circled with a red line and labeled '4'.

2. Configure Menu Items and Groups.

Please consult the KDS Menu and Recipes Quick User Manual for more details about how to configure a menu.

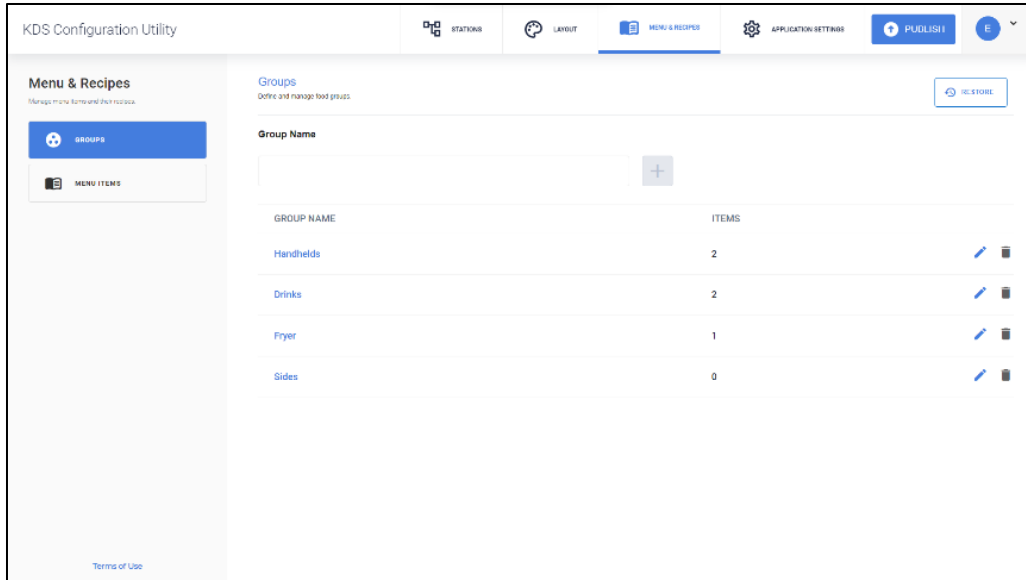

3. Configure the Menu Items for your Displays.

1. Click **Layout**.
2. Select **Grids**.
3. Select the Layout you want to configure (e.g., **Kitchen**).

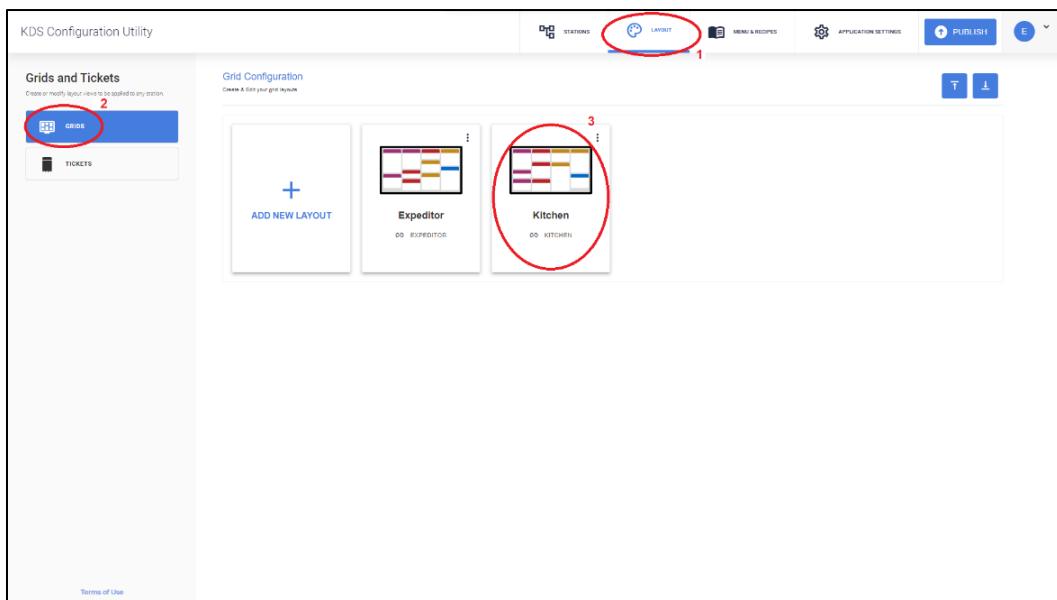

4. Enable the **Menu Items Filter**.
5. Select the **Menu Items** you want shown on that Display.
6. Click **Save**.

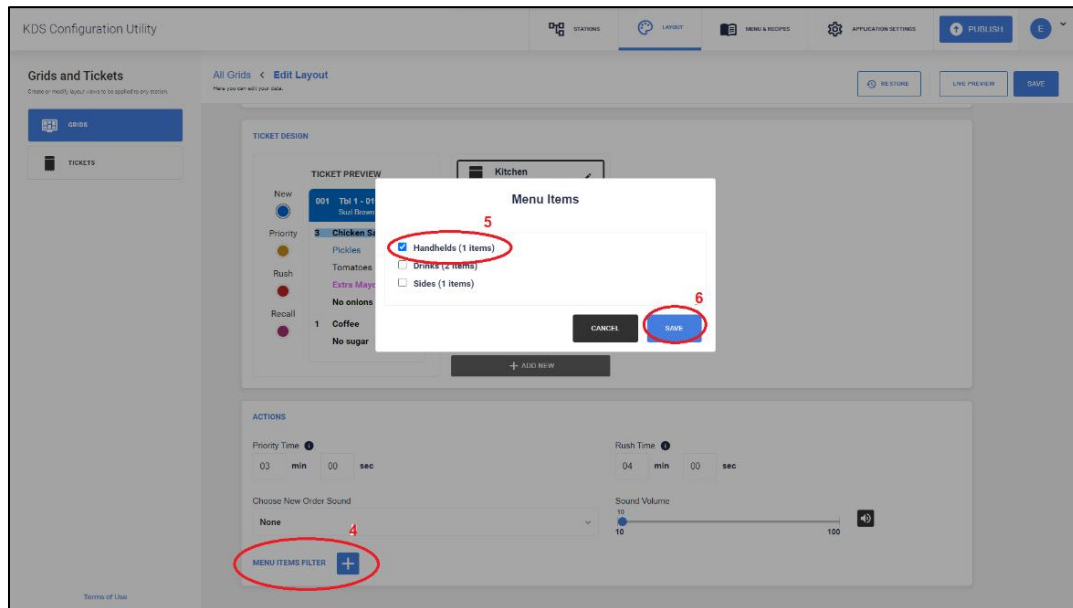

7. Select Menu Item/s to display.
8. Click **Save**.
9. Click **Publish**.

