

## Station Print Only

### About this Guide

This guide consists of 2 sections:

- **Overview** – A detailed description on what the KDS Station Print Only feature is in a TrueOrder™ Kitchen Display System (KDS).
- **How to Configure** - A procedure that can be followed to configure this within a Single or Multi-Station KDS system.

## Overview

A printer at a display station has the capability of bumping and printing the order or items in that order, creating a label. It may be desirable to have this order printed immediately from a KDS station when received. For example, if the items at that station are already prepared and simply require a label. Enabling the “Station Print Only” function in a KDS display accomplishes this. The KDS station then does not need a display attached nor a bump bar. An order sent to it will be automatically bumped off and printed when received.



Epson TM-L100 LFC  
Label Printer



Epson TM-L90II LFC  
Label Printer

# How to Configure

This guide assumes that you have a Multi- Station setup as described in the TrueOrder Multi-Station Quick Start Guide. However these instructions can be followed to configure this in any KDS configuration.

## 1. Enable Station Print Only

1. Click **Stations**.
2. Click **Stations**.
3. Select Station that you want to configure.

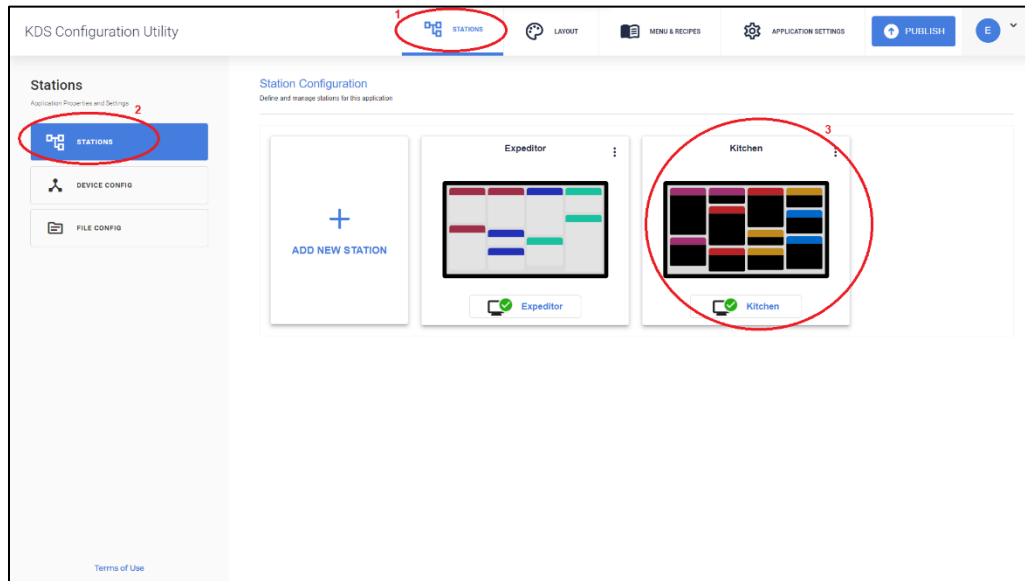

4. Enable **Station Print Only**.
5. Click **Save**.

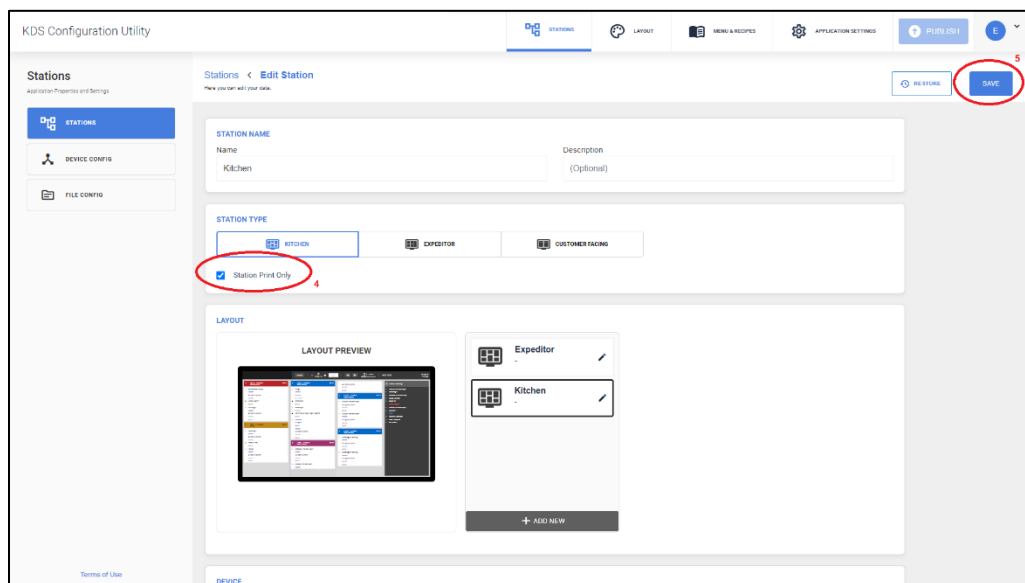

## 2. Enable Print Functions

1. Select **Device Config.**
2. Select *device* associated with '**Station Print Only**' (e.g., Kitchen Device used as example).

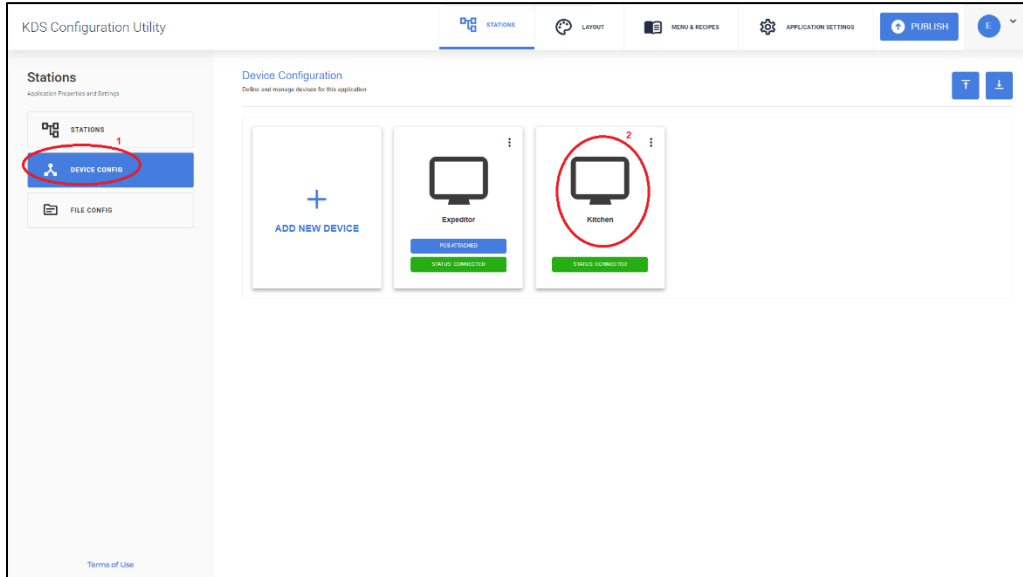

3. Enable **Print Functions** – Print Ticket on Bump.
4. Click **Save**.
5. Click **Publish**.

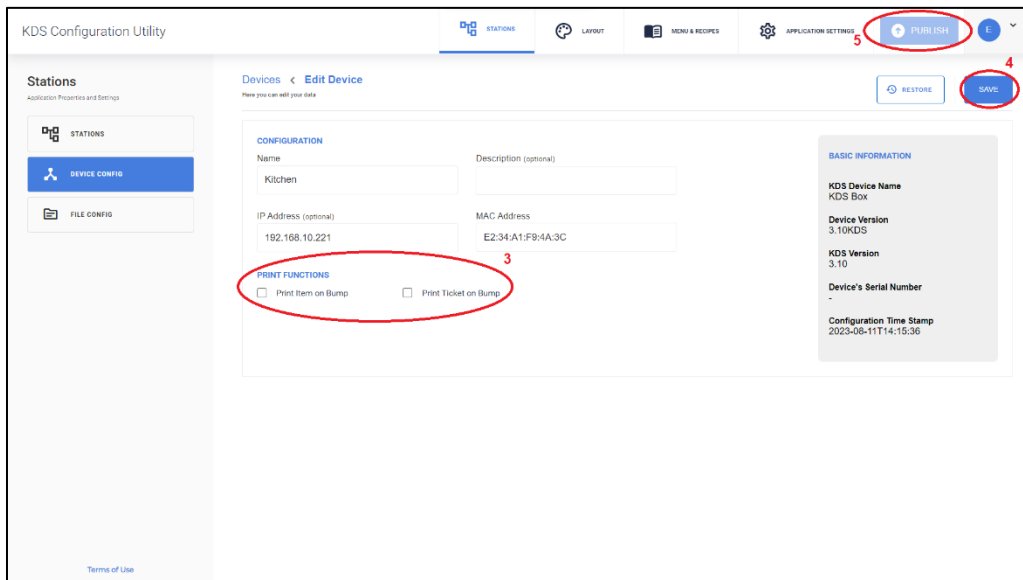

The printer at that station will now automatically bump and print an order ticket immediately for every incoming order.