

Note: The stand is optional for the Stylus Pro 7600.

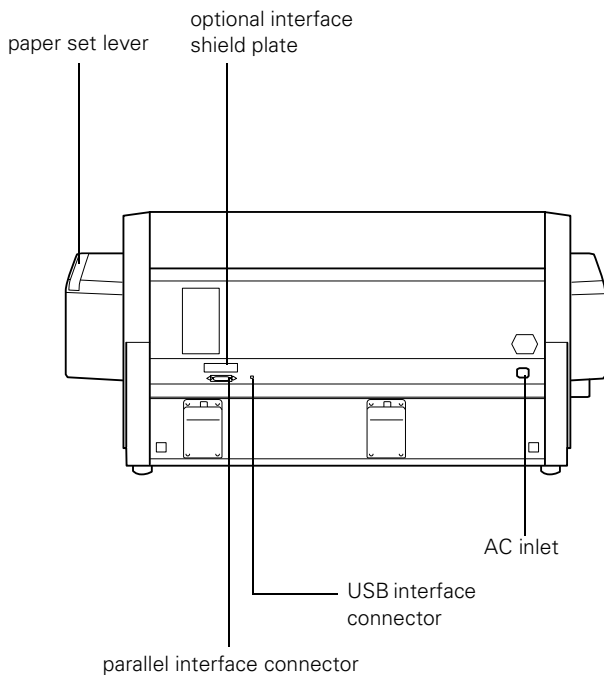

Printer Specifications

Printing

Printing method	7 color EPSON UltraChrome ink or 6 color EPSON Photographic Dye ink
	UltraChrome model switchable between three ink modes:
	<ul style="list-style-type: none"> <input type="checkbox"/> Photo Black Mode (uses Photo Black and Light Black cartridges) <input type="checkbox"/> Matte Black Mode (uses Matte Black and Light Black cartridges) <input type="checkbox"/> Dual Matte Black Mode (uses two Matte Black cartridges)
Nozzle configuration	96 nozzles for each color: black 1, black 2, cyan, magenta, yellow, light cyan, light magenta
Resolution	Maximum 2880 dpi × 1440 dpi
Print direction	Bidirectional
Control code	ESC/P® Raster Photographic Driver
Line spacing	1/6 inch (default), programmable in 1/1440-inch increments
Paper feed speed	200 ± 10 milliseconds per 1/6-inch line
RAM	32MB (Stylus Pro 7600) 64MB (Stylus Pro 9600)

Engine Reliability

Total print volume	20,000 B0 images, 360 × 360 dpi
Print head life	28 billion dots per nozzle
Periodic maintenance	Pump unit, head cleaner, and cap assembly require replacement approximately every 2 years based on 25% duty cycle
Cutter blade life	Approximately 2000 B0+ sheets (EPSON media up to 4.33 mil thick); approximately 1000 B0+ film sheets

Electrical

Specification	120V Model	220–240V Model
Input voltage range	90 to 132V	198 to 264V
Rated frequency range	50 to 60 Hz	
Input frequency range	49 to 61 Hz	
Rated current	1.0A	0.5A
Power consumption	Stylus Pro 7600: Approx. 50 W (ISO 10561 Letter Pattern) Stylus Pro 9600: Approx. 55 W (ISO 10561 Letter Pattern) Both printers: 12 W or less in sleep mode	

Mechanical

Paper feed	Friction feed (roll and cut sheet)
Paper path	Roll paper or cut sheets with manual insertion
Dimensions	Stylus Pro 7600: Width: 43.3 inches (1100 mm) Depth: 22.5 inches (572 mm) Height: 22.0 inches (560 mm) Stylus Pro 9600: Width: 63.9 inches (1624 mm) Depth: 28.2 inches (717 mm) Height: 46.5 inches (1181 mm), including stand
Weight	Stylus Pro 7600: 96 lb (43.5 kg) without ink cartridges or stand Stylus Pro 9600: 185 lb (84 kg) without ink cartridges or stand

Environmental

Temperature	Operation: 50 to 95 °F (10 to 35 °C) Storage: –4 to 104 °F (–20 to 40 °C) 1 month at 104 °F (40 °C) Transit: –4 to 140 °F (–20 to 60 °C), stored in shipping container 120 hours at 140 °F (60 °C)
Humidity (without condensation)	Operation: 20 to 80% RH Storage: 20 to 85% RH Transit: 5 to 85% RH (stored in shipping container)

Paper

The allowable paper dimensions are shown below:

	Roll paper	Cut sheets
Size (Stylus Pro 9600)	8.3 to 44.0 in. wide (210 to 1118 mm)	8.5 × 11 in. up to 44 in. wide
Size (Stylus Pro 7600)	8.3 to 24.0 in. wide (210 to 610 mm)	8.5 × 11 in. up to 24 in. wide
Maximum external roll diameter	2 in. core: 4 in. (103 mm) 3 in. core: 6 in. (150 mm)	—
Thickness	3.15 to 19.7 mil (0.8 to 0.5 mm)	3.15 to 59 mil (0.8 to 1.5 mm)

Notes:

- ❑ Poor quality paper may reduce print quality and cause paper jams and other problems. If you encounter problems, switch to a higher grade of paper.
- ❑ Do not use curled, folded, or deckle-edge paper.
- ❑ Depending on the media, best feed and print quality are guaranteed on EPSON paper with thicknesses of 3.15 to 4.33 mil (0.08 to 0.11 mm), 64 to 90 gsm.
- ❑ For best results, use paper under the following conditions:
 Temperature: 59 to 77 °F (15 to 25 °C)
 Humidity: 40 to 60% RH

BorderFree™ (marginless) printing is available in the following paper widths:

- ❑ 8 to 8.5 inches
- ❑ 10 inches
- ❑ 12 inches
- ❑ 14 inches
- ❑ 16 inches
- ❑ 20 inches
- ❑ 24 inches
- ❑ 36 inches (Stylus Pro 9600 only)
- ❑ 44 inches (Stylus Pro 9600 only)

When printing BorderFree, set the image size in your application to be approximately 3 mm (1/8 inch) larger than the intended size of your printed image.

Safety Approvals

Safety standards	UL 1950, CSA C22.2 No. 950 FDA
EMC	FCC part 15 subpart B, class B, CSA C108.8 class B

Ink Cartridges

- Lightfastness* *Photographic Dye:*
Color: up to 26 years (using EPSON ColorLife paper); black and white not rated
- UltraChrome:*
Color: up to 100 years
Black and white: over 100 years
- Print yield Approximately 28 pages/A1 (720 dpi, 40% duty)
- Approximately 3,800 pages/A4 (360 dpi, 5% duty)
- Print yield may vary, depending on how often you run cleaning cycles and how much you use the printer; yield of the initial cartridge set is reduced because of ink charging.
- Cartridge life: *Photographic Dye*
2 years from production date
- UltraChrome*
2 years from production date if unopened; within 6 months after opening package, at 77 °F (25 °C)
- Temperature: *Storage (uninstalled):*
-22 to 104 °F (-30 to 40 °C); 1 month at 104 °F (40 °C)
- Storage (installed):*
-4 to 104 °F (-20 to 40 °C); 1 month at 104 °F (40 °C)
- Transit:*
-22 to 140 °F (-30 to 60 °C); 1 month at 104 °F (40 °C), 120 hours at 140 °F (60 °C)
- Freezing:*
14 °F (-10 °C); ink thaws and is usable after at least 3 hours at 77 °F (25 °C)
- Capacity 110 ml (all models)
- 220 ml (Stylus Pro 9600, UltraChrome only)

* Preliminary data from Wilhelm Imaging Research, Inc. indicate the lightfastness of color UltraChrome prints made by the EPSON Stylus Pro 7600 and 9600 printers will be rated up to 100 years under glass on specific EPSON media. Data indicate the lightfastness of black and white UltraChrome images printed using the 7-color mode will be rated as greater than 100 years under glass on specific EPSON media. Ink lightfastness ratings are based on accelerated testing of prints on specialty media, displayed indoors, under glass. Actual print stability will vary according to media, printed image, display conditions, light intensity, humidity, and atmospheric conditions. EPSON does not guarantee longevity of prints. For maximum print life, display all prints under glass or lamination or properly store them. Visit www.wilhelm-research.com for the latest information.

Drivers

Macintosh® System 8.5.1 through 9.x (OS X clients supported via RIP, available from the EPSON web site for download), Windows® 95, Windows 98, Windows 2000, Windows Me, Windows XP, and Windows NT 4.0. Raster drivers are standard. For Adobe® PostScript® support, use the optional EFI® Fiery® Spark Professional 2.0 Software RIP or a third-party software solution.

Interfaces

- USB (1.1 and 2.0 compatible), recommended length less than 6 feet (2 meters)
 - Parallel (IEEE-1284 ECP mode)
- In addition, a Type B expansion slot is available for installing one of these options:
- Ethernet network card (10/1000 Base T)
 - IEEE 1394 (FireWire) card

The following connections are supported for each operating system:

Connection	Win 95	Win 98	Win NT 4.0	Win 2000	Win Me	Win XP	Mac
Parallel	X	X	X	X	X	X	
USB		X*		X	X	X	X
Ethernet (optional)	X	X	X	X	X	X	X
FireWire (optional)				X	X	X	X

* Supported on pre-installed operating systems, not upgraded from earlier versions of Windows.

In addition, Macintosh OS X supports USB and Ethernet when running applications in Classic mode.

Consumables and Accessories

Ink Cartridges

When you install the printer's first ink cartridges, it takes about 10 minutes to initialize the printer. Do not interrupt this process by turning off the printer, opening the printer covers, or releasing the paper set lever, or the printer will have to re-initialize. In that case, there may not be enough ink left in the original cartridges and you may have to replace them with new ones.

When you installed the ink cartridges that came with the printer, it was initialized as either a Photographic Dye ink model or UltraChrome ink model. If you don't use the correct replacement cartridges for your model, you will see an error message and your printer won't work until you insert the correct cartridges.

If you have a Stylus Pro 9600 that uses UltraChrome ink, you can install any combination of 110 and 220 ml cartridges. Unless you're planning to switch between black ink modes (see page 12), be sure to replace the black ink cartridges with the same type as you're currently using.

Use the following cartridges before the expiration date on the package:

Photographic Dye ink users:

Black*	T545100	Light cyan	T545600
Cyan	T545200	Light magenta	T545500
Magenta	T545300	Yellow	T545400

* Your printer requires two black ink cartridges.

UltraChrome ink users:

Cartridge	110 ml	220 ml*
Photo Black**	T543100	T544100
Matte Black**	T543800	T544800
Light Black**	T543700	T544700
Cyan	T543200	T544200
Magenta	T543300	T544300
Light Magenta	T543600	T544600
Light Cyan	T543500	T544500
Yellow	T543400	T544400

* Stylus Pro 9600 only.

** Your printer uses two black ink cartridges. Unless you are switching between black ink modes, use the same type of cartridges as are currently installed. Check their type by looking at the installed cartridges. If you install an incorrect cartridge, you will see the message **WRONG INK CARTRIDGE**.

User-Replaceable Parts

You can order these user-replaceable parts:

Part	Part number
Replacement Ink Maintenance Tank	C120890071
Replacement Printer Cutter Blade (replaces the printer's built-in cutter)	C12C815241

Options

The following options are available:

Part	Part number
EPSON Stylus Pro 7600 Printer Stand	C12C844061
EFI® Fiery® Spark Professional 2.0 Software RIP	C842832
Internal 10/100 BaseT (Ethernet™) Type-B interface card	C12C823912
Internal IEEE 1394 (FireWire™) Type-B interface card	C823722
Automatic Take-Up Reel System (Stylus Pro 9600 only)	C12C815251
Replacement 44-inch Take-up Reel Core (Stylus Pro 9600 only)	C815121
Paper Roller Spindle (Normal Tension) — 2- or 3-inch	
Stylus Pro 7600:	C12C811161
Stylus Pro 9600:	C12C811151
Paper Roller Spindle (High Tension) — 2- or 3-inch	
Stylus Pro 7600:	C12C811155
Stylus Pro 9600:	C12C811152
Manual Media Cutting System*	
Stylus Pro 7600:	C12C815231
Stylus Pro 9600:	C815182
Replacement Manual Cutting Blade (for Manual Media Cutting System)	C815192

* Designed for use with heavy media, which may damage the printer's built-in cutter.

EPSON Paper and Other Media

The papers you can use vary, depending on whether you have the Photographic Dye ink model or the UltraChrome ink model, as shown in the tables below.

NOTE: The Stylus Pro 7600 cannot use paper wider than 24 inches.

Papers supported by Photographic Dye ink model

Paper type	Roll sizes	Sheet sizes
Premium Glossy Photo Paper (250)	8.3-inch roll: S041376	11" × 17": S041290
	13-inch roll: S041378	11.7" × 16.5": S041288
	24-inch roll: S041638	13" × 19": S041289
	36-inch roll: S041639	
Premium Luster Photo Paper	10-inch roll: S041644	8.3" × 11.7": S041602
	20-inch roll: S041645	11.7" × 16.5": S041406
	24-inch roll: S041461	13" × 19": S041604
	36-inch roll: S041462	
Premium Semigloss Photo Paper	44-inch roll: S041463	
	—	8.3" × 11.7": S041331
		13" × 19": S041327
Premium Semimatte Photo Paper (250)	24-inch roll: S041655	—
	36-inch roll: S041656	
	44-inch roll: S041657	
Photo Paper	13-inch roll: S041233	8.3" 11.7": S041141, S041271, S041272
		8.3" × 11.7": S041140
		11.7" × 16.5": S041142
		11" × 17": S041156
		13" × 19": S041143
		8.3" × 23.4" (Panoramic): S041145
Photo Glossy Paper	24-inch roll: SP91021	—
	36-inch roll: SP91001	
	44-inch roll: SP91002	
Photo Semigloss Paper	24-inch roll: SP91022	—
	36-inch roll: SP91003	
	44-inch roll: SP91004	
Photo Quality Ink Jet Paper	—	11" × 17": S041070
		13" × 19": S041069
		16.5" × 23.4": S041079
		17" × 22": S041171
		16.5" × 49.21" (Banner): S041102
ColorLife™ Photo Paper Semigloss	24-inch roll: S041664	—
	44-inch roll: S041666	
Presentation Matte Paper	24-inch roll: S041295	—
	36-inch roll: S041221	
	44-inch roll: S041220	
Doubleweight Matte Paper	24-inch roll: S041385	—
	36-inch roll: S041386	
	44-inch roll: S041387	
Enhanced Matte Paper	24-inch roll: S041595	8.3" × 11.7": S041603
	36-inch roll: S041596	13" × 19": S041605
	44-inch roll: S041597	

Papers supported by Photographic Dye ink model (continued)

Paper type	Roll sizes	Sheet sizes
Matte Paper - Heavyweight	—	8.3" × 11.7": S041257
		11.7" × 16.5": S041260
		13" × 19": S041263
Enhanced Matte Posterboard	—	24" × 30": S041598
		30" × 40": S041599
EPSON Proofing Paper Commercial Semimatte	13-inch roll: S041668	—
	24-inch roll: S041658	
	36-inch roll: S041659	
	44-inch roll: S041660	
Glossy Paper Heavyweight	24-inch roll: S041291	—
	36-inch roll: S041227	
	44-inch roll: S041226	
Semigloss Paper Heavyweight	24-inch roll: S041292	—
	36-inch roll: S041229	
	44-inch roll: S041228	
Posterboard Semigloss	—	20.25" × 28.75": S041237
		28" × 40": S041236
Backlight Film	24-inch roll: S041482	—
	36-inch roll: S041483	
	44-inch roll: S041484	

Papers supported by UltraChrome ink model

Paper type	Roll sizes	Sheet sizes
Premium Glossy Photo Paper (250)	8.3-inch roll: S041376	11" × 17": S041290
	13-inch roll: S041378	11.7" × 16.5": S041288
	24-inch roll: S041638	13" × 19": S041289
	36-inch roll: S041639	
	44-inch roll: S041640	
Premium Luster Photo Paper	10-inch roll: S041644	8.3" × 11.7": S041602
	20-inch roll: S041645	11.7" × 16.5": S041406
	24-inch roll: S041461	13" × 19": S041604
	36-inch roll: S041462	
Premium Semigloss Photo Paper	44-inch roll: S041463	
	—	8.3" × 11.7": S041331
		13" × 19": S041327
Premium Semimatte Photo Paper (250)	24-inch roll: S041655	—
	36-inch roll: S041656	
	44-inch roll: S041657	
Photo Glossy Paper	44-inch roll: SP91002	—
	36-inch roll: SP91001	
	24-inch roll: SP91021	
Photo Semigloss Paper	44-inch roll: SP91004	—
	36-inch roll: SP91003	
	24-inch roll: SP91022	
Doubleweight Matte Paper	44-inch roll: S041387	—
	36-inch roll: S041386	
	24-inch roll: S041385	
Enhanced Matte Paper	24-inch roll: S041595	8.3" × 11.7": S041603
	36-inch roll: S041596	13" × 19": S041605
	44-inch roll: S041597	

Papers supported by UltraChrome ink model (continued)

Paper type	Roll sizes	Sheet sizes
Enhanced Matte Posterboard	—	24" × 30": S041598 30" × 40": S041599
EPSON Proofing Paper Commercial Semimatte	13-inch roll: S041668 24-inch roll: S041658 36-inch roll: S041659 44-inch roll: S041660	—
Glossy Paper - Photo Weight	44-inch roll: S041389 22-inch roll: S041388	13" × 19": S041456
Watercolor Paper-Radiant White	—	13" × 19": S041351
EPSON Velvet Fine Art Paper*	—	8.5" × 11": S041636 13" × 19": S041637
Somerset Velvet for EPSON Fine Art Paper	24-inch roll: SP91203 44-inch roll: SP91204	24" × 30": SP91200 36" × 44": SP91201 44" × 60": SP91202
Smooth Fine Art Paper*	24-inch roll: S041431 36-inch roll: S041432 44-inch roll: S041433	24" × 30": S041434 36" × 44": S041435
Textured Fine Art Paper*	24-inch roll: S041447 36-inch roll: S041448 44-inch roll: S041449	24" × 30": S041450 36" × 44": S041451
Synthetic Paper*	24-inch roll: S041399 36-inch roll: S041400 44-inch roll: S041401	—
Adhesive Synthetic Paper*	24-inch roll: S041402 36-inch roll: S041403 44-inch roll: S041404	—
Adhesive Vinyl	24-inch roll: S041436 36-inch roll: S041437 44-inch roll: S041438	—
Backlight Film	24-inch roll: S041482 36-inch roll: S041483 44-inch roll: S041484	—
Tyvek® Brillion™	24-inch roll: S041494 36-inch roll: S041495 44-inch roll: S041496	—
Canvas	24-inch roll: S041531 36-inch roll: S041532 44-inch roll: S041533	—

NOTE: Check the EPSON Pro Graphics web site (<http://prographics.epson.com>) for additional media that may become available.

Control Panel

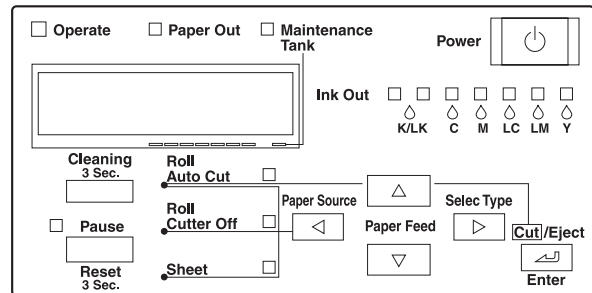

Control Panel Lights and Messages

When a problem occurs, a message appears on the display and the lights on the control panel come on or flash.

Error messages

Message/Light	Explanation	Response
INK LOW Ink Out light(s) flashing	Ink cartridge(s) are nearly empty (printing continues).	Make sure you have replacement cartridges available.
INK OUT Ink Out light(s) on	Ink cartridge(s) are empty (printing stops).	Replace the ink cartridge(s) indicated by Ink Out light(s).
NOT ENOUGH INK Ink Out light(s) on	Not enough ink is available to finish cleaning the print head.	Replace the ink cartridge(s) indicated by Ink Out light(s).
NO INK CARTRIDGE Ink Out light(s) on	Ink cartridge(s) not installed.	Install ink cartridges as indicated by the lights.
WRONG INK CARTRIDGE INVALID INK CARTRIDGE Ink Out light(s) on	You tried to install the wrong ink cartridge.	If you are installing ink cartridges for the first time, you must install the cartridges that came with your printer. If you are replacing ink cartridges, check the package and product code. You must use the ink cartridges designed for your printer. Other cartridges will not work.
LOAD PAPER Paper Out light on	Paper lever is in the released position (all the way back) while loading paper.	After you finish loading paper, pull the paper lever all the way forward, to the secured position.

Error messages (continued)

Message/Light	Explanation	Response
LOAD ROLL PAPER LOAD SHEET PAPER Paper Out light on	Paper source setting in printer software is different from control panel.	Make sure the right paper is loaded and the paper source setting is the same on the control panel and printer software.
PAPER JAM Paper Out light flashing	Paper has jammed in the printer.	Remove the jammed paper.
PAPER NOT CUT Paper Out light flashing	Roll paper was not cut completely.	Cut the paper manually, remove the cut paper from the printer, then reload paper.
	Cut paper did not fall off.	Remove the cut paper from the printer. Reload paper.
PAPER NOT STRAIGHT Paper Out light flashing	Paper slipped and fed into the printer at an angle.	Reload paper, making sure the edges are straight and aligned with the vertical row of holes at the paper exit.
PAPER OUT Paper Out light on	No paper is loaded.	Load paper.
	Paper ran out.	Remove any printouts or paper remaining in the printer and load more paper. If the message appears during a print job, reset the printer by pressing the Pause button for 3 seconds. Then load paper and resend the job.
RELOAD PAPER Paper Out light on	Paper could not be reversed into the printing position.	Remove the paper. Reload it so that the bottom edge is straight and aligned with the vertical row of holes at the paper exit.
	Image is too wide for the paper loaded in the printer.	Resize your image or load wider paper.
	Paper is not fully ejected.	Cut the paper at the paper insertion slot, then reload paper.
	PAPER NOT CUT error was cleared.	Reload paper.
REMOVE PAPER Paper Out light on	Paper is too thick for head cleaning.	Pull the paper set lever out to remove the paper. Head cleaning automatically starts. After cleaning, reload paper.
SET PAPER LEVER Paper Out light on	Paper lever was released during the printing process or another operation.	Pull the lever all the way forward, to the secured position. Start printing again from the beginning for best results.

Error messages (continued)

Message/Light	Explanation	Response
SET INK LEVER	The ink lever was left in the unlocked position.	Pull the lever down to lock the ink cartridges.
FRONT COVER OPEN Pause light on	Front cover is open.	Close the front cover.
TURN PRINTER PWR OFF AND ON	This message appears after you clear a paper jam.	Press the Power button to turn the printer off and back on again.
UNABLE TO PRINT	You tried to print while an error condition was present or the ink compartment cover was open.	After 3 seconds the message disappears. Press the Pause button to exit SelecType mode. If the message appears again, clear the error before you print.
MAINTENANCE TANK ALMOST FULL Maintenance Tank light flashing	The maintenance tank is almost full.	Make sure you have a replacement maintenance tank.
CHANGE MAINTENANCE TANK All lights flashing	The maintenance tank is full.	Replace the maintenance tank.
NO MAINTENANCE TANK Maintenance Tank light is on	The maintenance tank is not installed.	Make sure the maintenance tank is fully inserted.
OPTION I/F ERROR	Wrong interface card installed.	Turn off the printer and remove the card. See the documentation that came with the card.
SERVICE REQ. All lights flashing	An error has occurred.	Note the error number, then turn the printer off and back on.
MAINTENANCE REQ.	A printer part will need to be replaced soon.	Note the error number and contact EPSON. (If only the cutter blade is worn out, you can replace it yourself.)
COMMAND ERROR	You're using the wrong printer driver.	Make sure you installed the correct driver for your printer.
	Damaged data was sent to the printer.	To clear the data, press the printer's Power button to turn the printer off. Wait for about a minute, then turn the printer on again.

Printing a Status Check

The status check shows the amount of ink remaining in each cartridge, the page count, and the status of the cutter blade, maintenance tank, and other printer parts.

NOTE: You can replace the ink cartridges, cutter blade, and maintenance tank yourself. Other parts need to be replaced by an authorized EPSON service technician.

Follow these steps to print the status check:

1. Load a sheet of paper in the printer. (You can print test pages on roll paper, but you will use more paper.)
2. Press the **SelectType** button on the control panel. You see **PRINTER SETUP**.
3. Press **▼** so you see **TEST PRINT**, then press **▶**. You see **NOZZLE CHECK**.
4. Press **▼** so you see **STATUS CHECK**, then press **▶**. You see **PRINT**.
5. Press **Enter**. The status check sheet prints.

The amount of ink left or the component life is indicated as follows:

E*****F = full (or full life remaining)
 E**** F = 3/4 full (or 3/4 life remaining)
 E*** F = 1/2 full (or 1/2 life remaining)
 E** F = 1/4 full (or 1/4 life remaining)
 E* F = nearly empty (or service life near end)
 E F = empty (or service life ended)

6. Press **Pause** to exit the Test Print menu.

Replacing an Ink Cartridge

The easiest way of checking ink levels is from the control panel:

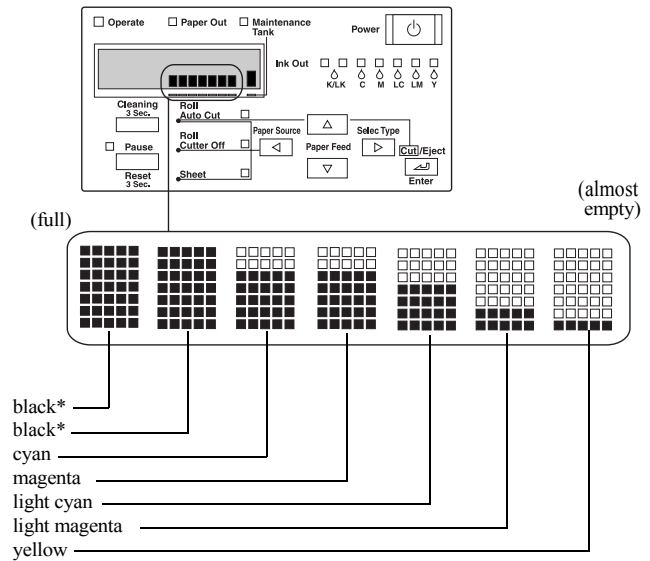

* If your printer uses UltraChrome ink, the black ink cartridges may be a combination of Photo Black, Matte Black, or Light Black.

When one of the **Ink Out** lights is flashing (and **INK LOW** is displayed on the control panel), the corresponding cartridge is almost out of ink. Make sure you have a replacement cartridge. When the light stays on and **INK OUT** is displayed, the cartridge is empty. You must replace the cartridge before you can continue printing.

See page 5 for information on selecting the correct replacement cartridges. Before you start, make sure the printer is turned on. Then follow these steps to replace an ink cartridge:

1. Note the color of the cartridge whose **Ink Out** light is on or flashing. This is the cartridge you need to replace.
2. Open the ink compartment cover.

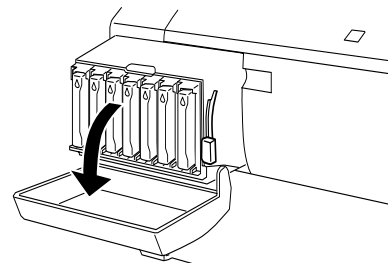

3. Raise the ink lever to the unlocked position.

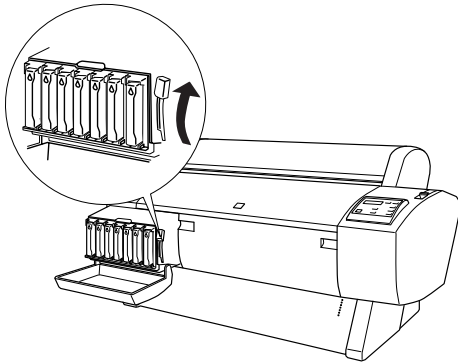

4. Remove the empty ink cartridge from the printer.

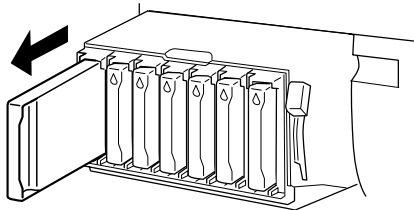

5. Make sure the replacement cartridge is the correct color, and remove it from its package.

If you're using UltraChrome Ink, gently shake the cartridge before installing it.

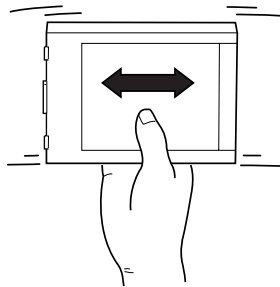

6. Hold the cartridge with the arrow pointing toward the printer. Then insert the cartridge into the slot. Don't force it in.

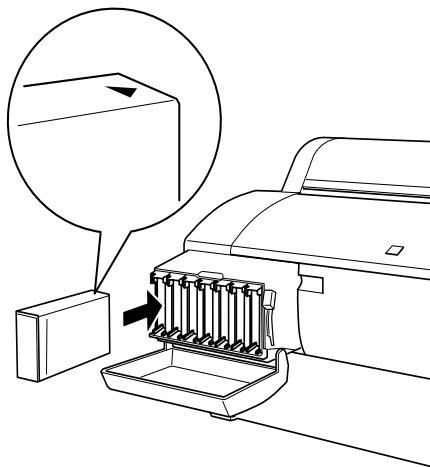

7. Lower the ink lever to its locked position.

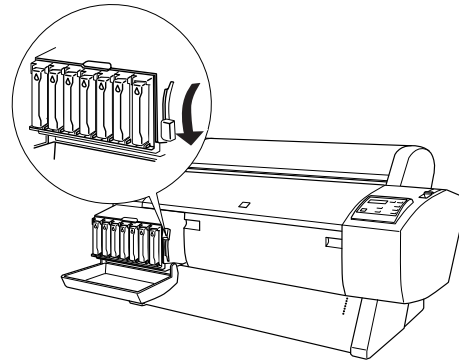

8. If you're using 110 ml cartridges, close the ink compartment cover. If you're using 220 ml cartridges, you'll have to leave the cover open.

Once the cartridges are installed, the printer returns to its **READY** state (or says **LOAD PAPER** if paper isn't loaded).

If you see the message **WRONG INK CARTRIDGE**, you may have loaded an incorrect black ink cartridge for the black ink mode you're currently in, or loaded a cartridge containing the wrong type of ink for your printer (Photographic Dye or UltraChrome). Remove any cartridges indicated by a red **Ink Out** light on the control panel, and replace them with the correct cartridges.

Paper Type and Banding

Banding can be caused by several problems, such as clogged print head nozzles or a mis-aligned print head. It can also be caused by using a paper that is not defined in the EPSON printer driver or in a third-party RIP. To correct this problem, make sure you select the correct paper type in the driver.

If your paper type is not defined, use the printer's SelecType menu to create a custom paper type. See "Optimizing the Settings for Your Paper" in the *Printer Guide*.

Running a Nozzle Check and Cleaning Cycle

If your printed image is unexpectedly light or faint or dots are missing from the image, you may need to run a cleaning cycle. This unclogs the print head nozzles so they can deliver ink properly.

The cleaning cycle uses ink, so you should run it only if print quality declines. To determine if a cleaning cycle is needed, print a nozzle check (below). You should also print a nozzle check after cleaning to see if the cleaning cycle was successful.

Printing a Nozzle Check Pattern

1. Load a letter-size sheet of paper in the printer. (You can print the nozzle check on larger sheets or roll paper, but you will use more paper; you'll also have to remove any roll paper before running the cleaning cycle.)
2. Press the **SelectType** button on the control panel. You see **PRINTER SETUP**.
3. Press **▼** so you see **TEST PRINT**, then press **▶**. You see **NOZZLE CHECK**.
4. Press **▶** so you see **PRINT**, then press **Enter**. The nozzle check sheet prints.
5. Examine the nozzle check pattern. Each staggered horizontal and straight vertical line should be complete, with no gaps in the pattern:



If dots are missing from the pattern, as shown below, clean the print head as described in the next section.

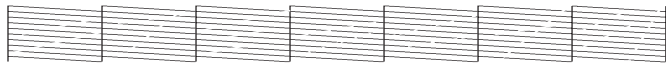

Cleaning the Print Head

1. Make sure no paper is loaded and all of the **△ Ink Out** lights on the printer's control panel are off.
If an **△ Ink Out** light is flashing or on, you need to replace the corresponding ink cartridge instead. See page 9 for instructions.
2. Press the **Cleaning** button and hold it for at least 3 seconds. The **Pause** light flashes as the printer cleans its print head. The cleaning cycle takes about 60 seconds and does not use any paper.
3. When the **Pause** light goes off, print the nozzle check again to confirm that the head is clean.
You may need to run the cleaning cycle several times to get a complete nozzle check pattern. For effective cleaning, always run a nozzle check between cycles.

If the lines in the pattern are still missing dots after several cleaning cycles, turn the printer off and leave it overnight, then clean the print head again the following morning. If you still see no improvement, contact EPSON for assistance.

Aligning the Print Head

If banding appears on your prints, or vertical lines are not straight, you need to align the print head. Although you can align the print head using the printer software, it's best to do this from the control panel. This aligns the print head for all modes and resolutions.

If you haven't already done so, it's a good idea to run a nozzle check before aligning the print head (page 11). This ensures that the print head alignment patterns print correctly.

1. Make sure the printer is turned on. Then load roll paper that is at least 24 inches wide (you can use the roll paper that came with your printer).
2. Press the **SelectType** button on the control panel. You see **PRINTER SETUP**.
3. Press **▲** so you see **HEAD ALIGNMENT**, then press **▶**. You see **PAPER THKNS**.
4. Press **▶** so that ***STD** appears on the display. This is the correct thickness setting for most EPSON papers. If you'll be printing on one of the papers listed below after completing the alignment, use the **▲** and **▼** buttons to select the appropriate thickness setting for that paper.

Thickness setting	Paper type
3N	For EPSON Premium Glossy Photo Paper (250) and Premium Semimatte Photo Paper (250)
0N	For film
0.0 to 1.6 mm	For non-EPSON media

5. Press **Enter**.
6. Press the **▼** button to select the mode you want to perform the adjustment in (**BI-D BLACK**, **BI-D ALL**, or **UNI-D ALL**).
If you're printing non-photographic images with black ink only, select **BI-D BLACK**. Otherwise, perform a **UNI-D ALL** adjustment, followed by **BI-D ALL**.
7. Press the **Enter** button to print the alignment patterns.

- Once the patterns are done printing, examine the first row (K1) in group #1. You see a pattern similar to that shown below (only part of it is shown in the drawing). Use your own eye loupe or the one that came with the printer to determine which line looks the best. In the example below, the middle line (numbered 5) is the best.

NOTE: You must use at least a 10x eye loupe to check the pattern.

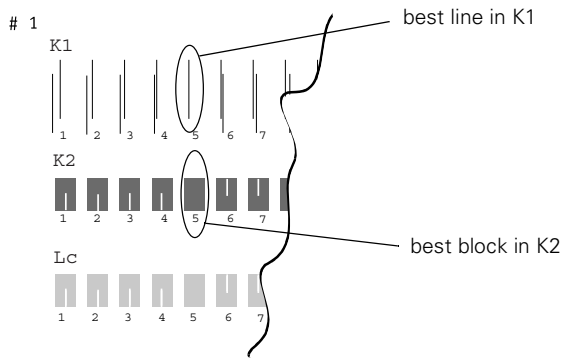

- Use the ▲ and ▼ buttons to select the best line.
- Press **Enter**.
- Examine the black set of blocks (K2) in group #1. Select the block with the smallest gap, then press **Enter**.
- Repeat this process for each of the other patterns, when prompted.
- If number 5 (the current alignment setting) shows the smallest gap for each pattern, the print head is aligned and you can exit the adjustment early by pressing **Pause**. You may need to repeat the alignment more than once to ensure that number 5 is the best choice for all patterns.
- When done, press **Pause** to exit the head alignment.

Switching Between Black Ink Modes

If your printer uses EPSON UltraChrome ink, you can switch between black ink modes to optimize your black ink density. When you installed the cartridges that came with your printer, your printer was initialized in Photo Black Mode. You can switch between the three modes shown below:

Mode	Image and paper type
Photo Black Mode	For printing photographic images on all media types. Optimized for traditional photographic and ink jet-coated papers, such as EPSON Premium Luster Photo Paper, Photo Semigloss Paper, Premium Semimatte Photo Paper, etc.
Matte Black Mode	Optimized for printing photographic images on matte or plain papers, such as EPSON Enhanced Matte Paper, Smooth and Textured Fine Art Paper, and Somerset Velvet for EPSON, when the highest level of photographic quality is desired.
Dual Matte Black	For printing on matte or plain paper, such as newsprint and plain bond, when print speed is favored over photographic image quality.

After deciding on the black ink mode you want to switch to, make sure you have the black ink cartridge(s) you'll be installing. In some cases, you'll be replacing only one of the cartridges.

Mode	Required cartridges
Photo Black Mode	Photo Black and Light Black
Matte Black Mode	Matte Black and Light Black
Dual Matte Black	Matte Black and Matte Black

Since this process consumes ink from the color cartridges as well as the black ones, you need to make sure there is enough ink in all the cartridges before you begin. Check the **Ink Out** lights on the control panel:

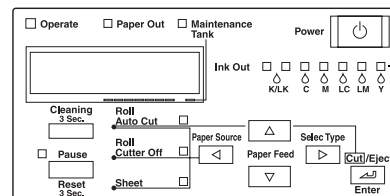

If an **Ink Out** light is on or flashing, you'll need to replace the cartridge

If there is not enough ink in one or more cartridges to carry out the procedure (5% or less), you'll be prompted during the procedure to replace the cartridges. If any cartridges are low on ink but not low enough to prevent the procedure from being carried out, you should still make sure you have replacements available, or you will be limited in how much you can print after switching black ink modes.

If the printer's maintenance tank is almost used up, you'll need to replace it as well. The printer will tell you if it needs to be replaced, but you may wish to check it in advance, as shown below, so you can make sure you have one available, in case it's needed.

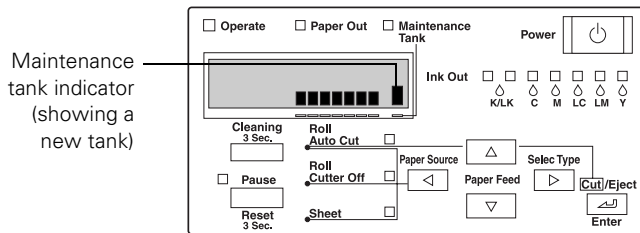

Selecting the Black Ink Cartridges

Make sure you have all the needed supplies as described above. Once you remove the ink cartridges from the printer, you must not turn off the printer until you have finished switching black ink modes. Follow these steps to start the process and tell the printer which cartridges you want to install:

1. Make sure the printer is on and **READY** is displayed on the control panel.
2. Press the **SelectType** button. You see **PRINTER SETUP**.
3. Press **▼** until you see **MAINTENANCE**, then press **▶**. You see **PWR CLEANING**.
4. Press **▼** so you see **BK INK CHANGE**, then press **▶**. You see **EXEC**.
5. Press **Enter**. You see **SELECT INK SET**.

The printer gives you two choices for the new set of black ink cartridges, depending on which ones are already installed (press **▲** or **▼** to see the choices). For example, if you're in Photo Black Mode, the printer will let you switch to either Matte Black Mode (**#1 MAT: #2 LBK**) or Dual Matte Black Mode (**#1 MAT: #2 MAT**).

6. Make sure you know which cartridges you want to install, then press **▲** or **▼** until the correct set of cartridges is displayed.
7. Press **ENTER**.

If you see the message **NOT ENOUGH INK**, lift the ink lever and remove any low or empty cartridges. (Check the **Ink Out** lights on the control panel to see which cartridges are low or empty.) Insert the replacement cartridge(s), then lower the ink lever.

8. The printer displays a message telling you to release the ink lever and remove the cartridges. Raise the lever and remove all the cartridges; do not re-insert them until instructed to do so.

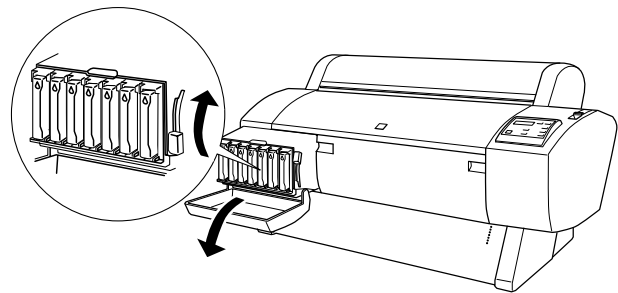

Be sure to set aside any black ink cartridges you won't be using, so that you don't accidentally re-insert them.

Checking the Maintenance Tank

Once you have removed all the ink cartridges, you may see a message telling you to replace the maintenance tank. If so, pull out the tank from the side of the printer and replace it with a new one. If you don't see this message, continue on to the next section.

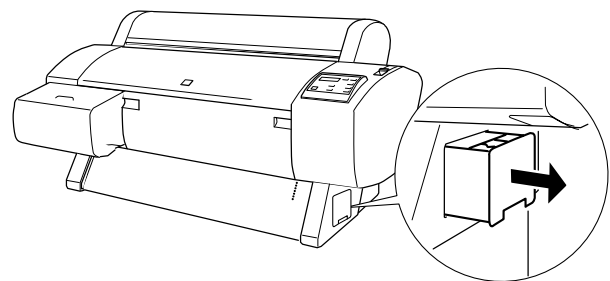

Draining the Ink

Once you have removed all the ink cartridges, you see a message that the printer is ready for draining. Follow these steps:

1. Insert the draining cartridge into the slot indicated on the control panel (**#1** or **#2** slot). The position is also indicated by the flashing **Ink Out** light.
2. Lower the ink lever. The printer begins draining the ink delivery system.
3. Once the draining is complete, the printer stops making noise and you see a message telling you to remove the draining cartridge.

If you are replacing both black ink cartridges, you see a message prompting you to insert the draining cartridge in the second slot. Once you do this, the draining process repeats a second time.

Charging the Ink

Once draining is complete, make sure you have the correct black ink cartridges available for the black ink mode you're switching to. Then follow these steps:

1. Insert all the ink cartridges into the printer. Be sure to install the correct black ink cartridges for the black ink mode you're switching to.
2. Lower the ink lever. The printer begins charging the ink delivery system.
3. Once the charging is complete, the printer stops making noise and displays **READY** on the control panel.

Continue on to the next section to update your printer driver software.

Updating the Macintosh Driver

If you're printing from a Macintosh, you need to update the driver so that it knows which black ink mode you're using. (In Windows, the driver is updated automatically.)

1. Open the Chooser from the **Apple** menu.
2. Click the printer icon and port, as shown.

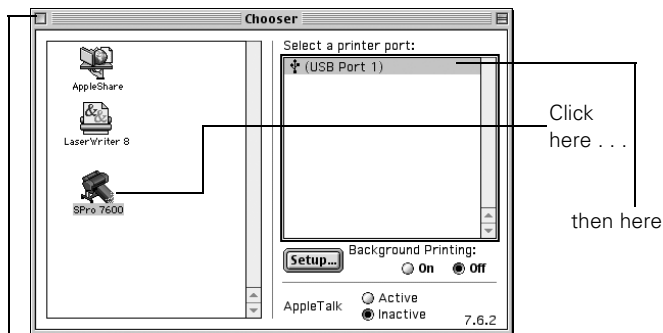

Close when done

3. Close the Chooser. This completes the black ink replacement.

Replacing the Cutter Blade

If you notice that your paper isn't cut cleanly, the cutter blade may need to be replaced. If you use the blade to cut heavy stock or non-EPSON media, you may need to replace it more often. You can check the status of your cutter by printing the status check sheet (see page 9).

1. Make sure that the printer is on and the front cover is closed.
2. Press the **SelectType** button on the control panel. You see **PRINTER SETUP**.
3. Press **▼** until you see **MAINTENANCE**, then press **▶**. You see **PWR CLEANING**.
4. Press **▼** until you see **CUTTER REPL**, then press **▶**. You see **EXEC**.
5. Press **Enter**. The carriage moves to the cutter replacement position.
6. You see a message on the control panel telling you to open the front cover. Open the cover to access the carriage.

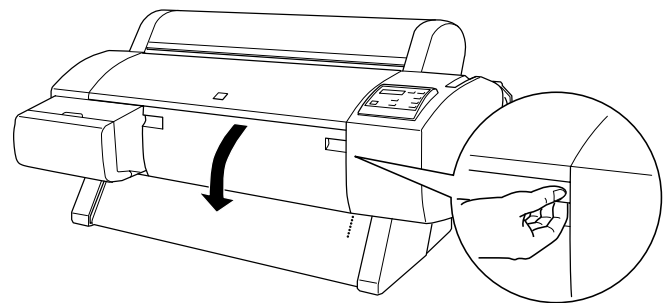

7. Push down on the side pin, then turn the latch to the right.

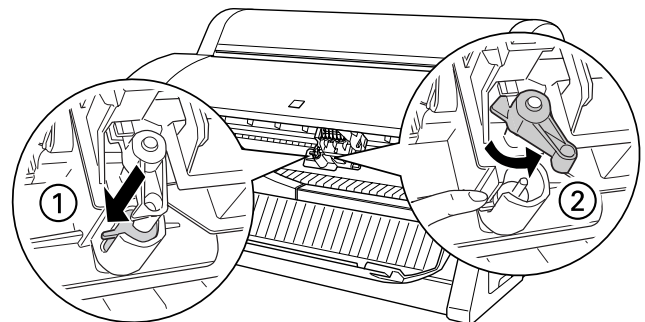

- Carefully remove the cutter blade. Be careful not to lose the spring.

CAUTION: The blade is sharp. Be careful when removing it.

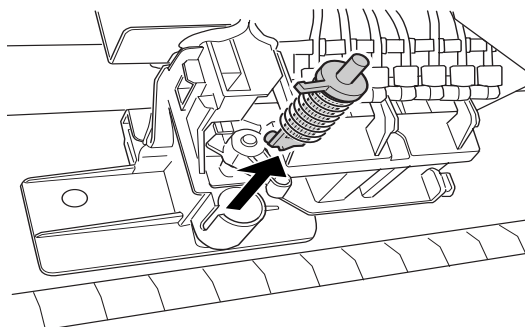

- Insert the new cutter as shown.

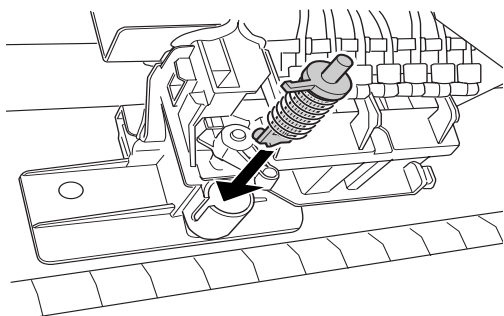

- Push down on the side pin while turning the latch to the left.

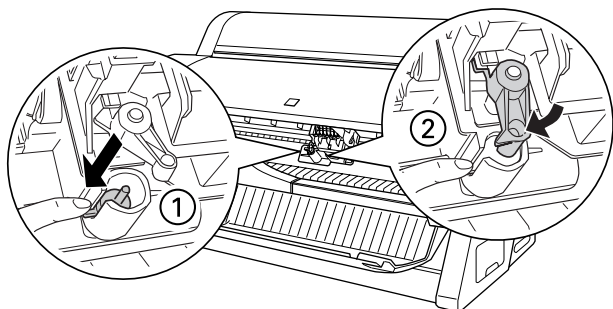

- Close the front cover. The carriage returns to the home position and the printer returns to its previous status.

Replacing the Maintenance Tank

When the maintenance tank is almost full, the **Maintenance Tank** light on the control panel flashes. When the tank is completely full, the printer stops working and the **Maintenance Tank** light stays on. You see the message **CHANGE MAINTENANCE TANK** on the control panel.

You can check how much space remains in the maintenance tank by viewing its indicator on the control panel, shown below.

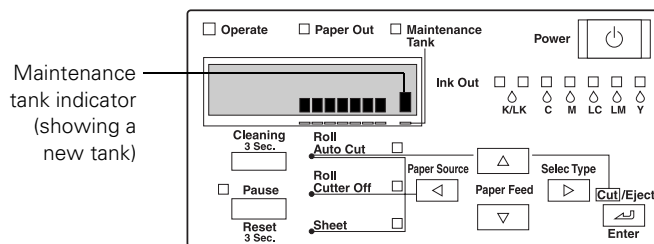

Follow these steps to replace the tank:

- Make sure the printer is not printing or performing any other operations (**READY** or **PAPER OUT** should appear on the control panel).
- Pull out the maintenance tank from the side of the printer.

CAUTION: Be careful not to spill ink from the tank when removing it. Hold it upright at all times.

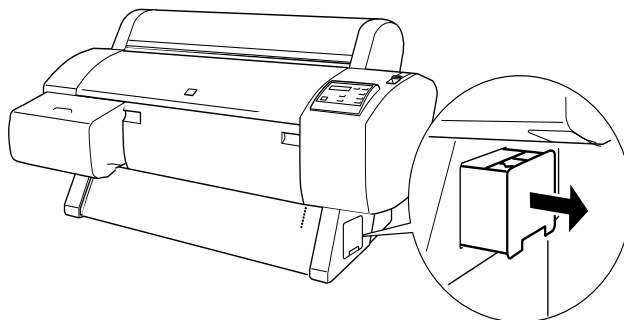

- Insert the new tank.

Related Documentation

CPD-14021	EPSON Stylus Pro 7600 and 9600 Printer Guide
CPD-14020	EPSON Stylus Pro 7600 and 9600 Quick Reference Guide