

IMPORTANT

How to Insert the CD/DVD Tray

Follow these steps to load CDs and DVDs in your printer.

Caution: If you don't insert the tray correctly, you may damage the printer or tray.

- 1 Lift the printer cover and push in the output tray extension. Then lower the CD/DVD tray guide.

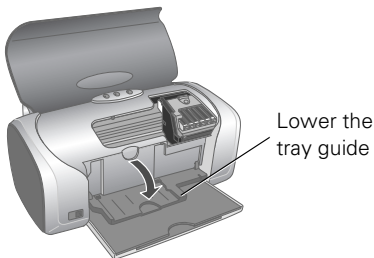
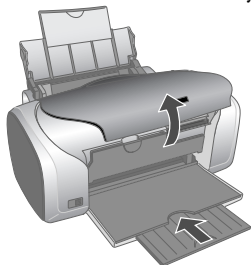

- 2 Place the CD or DVD on the tray, making sure the disc lays flat in the tray.

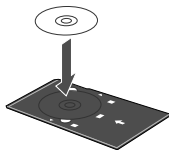

- 3 Insert the tray carefully, making sure it is level, not tilted up or down.

Push the tray under the tab and the two rollers.

Don't push in the tray too far; line up the arrows exactly.

See your user's manual for more information.

